

Spa Parts Catalog





Wellisparts is a registered trademark of the Wellis Group.

© **Wellis 2022**

The contents of this catalogue are the copyright of the publisher and may not be reproduced (even extracts) without his written authorisation. We do not undertake any liability for direct or indirect loss or damage eventually caused by the use of informations contained in this catalogue.

The publisher reserves the right to change specifications and prices without prior notice.

wellis.com | **<https://wos.wellis.com>**

Content



Wellis OS

Dear Partners!

Recently, we have placed more emphasis on the use of our internal system, WOS. Our development team has been working for several months to provide you a high-quality, fast and modern platform. Based on your feedbacks, the following changes will be available in the near future:

Each customer will have a main account on WOS. On the main account it is possible to create additional WOS accounts and set different authorizations per account. You may give different authorizations for the sales and service teams or/and individual persons.

According to our plans, the following rights can be set:

- Visibility of orders
- Placing orders
- Visibility of prices
- Visibility of invoices
- Visibility of shipments
- News visibility
- Media library visibility
- Use of Fault Report
- Product visibility

For more information, contact your regional representative.

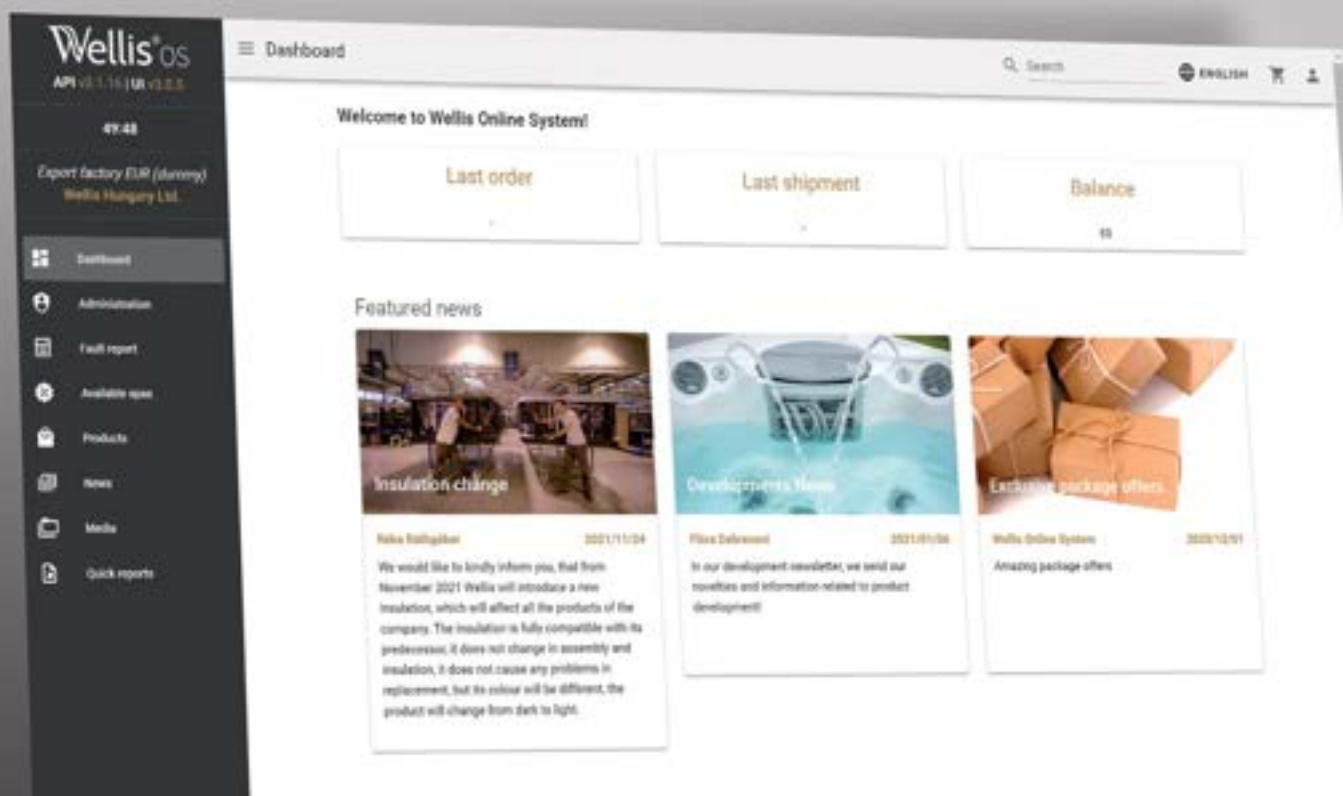

Accessories

SWIMSPA STEP

WE00076

Safety and convenience should be a top-priority for your customer – this attractive package offers both! Weight: 97 lb;

Step size without handrail: 57.9x30.3x34.6 in.

Step size with handrail: 57.9x65x36.8 in.

Factory price: **\$1106.88**



WELLISTEP WITH WELLIS LOGO

AKU1638

Maintenance free spa steps, 27.8 in.-wide and made of UV-resistant plastic with anti-slip rubber treads - the best choice for your Wellis spa.

Load capacity: 331 lb ; Size: 27.8x24.4x16.7 in.

Factory price: **\$85.00**

EASY THERMAL COVER LIFTER

WT00208

Easy cover lifter, Weight: 8.82 lb, Adjustable (available dimension):
Length: 68.9-92.5 in., Width: 74.8-98.4 in., Height: 31.5-41.3 in.

Factory price: **\$80.00**



UNIVERSAL THERMAL COVER LIFTER

WM00767

The thermal cover folds around this frame and cantilevers over the rear edge of the spa, very easy operation whatever the size or weight of the cover – particularly suitable for the more bulky Wellis Xtreme™ thermal cover

Factory price: **\$90.00**



BUCKLE KIT (4 PCS) WITH NUMBER COMBINATION LOCK

AT00135-1

Buckle kit (4 pcs) with number combination lock for safety closing

Factory price: **\$9.20**

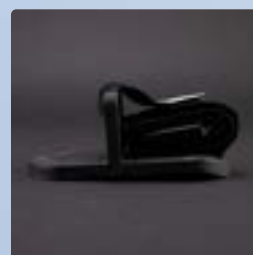
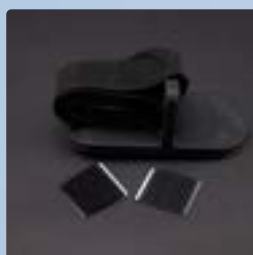

STRAP FOR ROOF LIFT

AT00087

This set works with the Buckle kit and it can hold down the roof tightly;
Related product: AT00135-1

Factory price: **\$7.19**



WELLIS SPA GRIP

WM00275

The rust-proof rails have an anti-slip foam rubber grip and can be fixed to the side panel of the spa cabinet to provide convenient and safe access in and out of the spa.

Factory price: **\$112.84**



WELLIS SPA GRIP STANDING

WM00769

The rust-proof rails have an anti-slip foam rubber grip and can be fixed to the side panel of the spa cabinet to provide convenient and safe access in and out of the spa. Standing version;
Weight: 5.7 lb, Size: 20.5x16.1x5.1 in.

Factory price: **\$112.84**

WELLIS SPA UMBRELLA WITH LED LIGHT

WM00128

Perfect for rain or shine our spa broolly utilises the weight of the spa to hold it in place. It can be opened, closed or tilted with ease by a simple hand crank, whilst its height can be adjusted at the push of a button.

Height: 102 in., Umbrella diameter: 108 in.

Factory price: **\$747.50**





WELLIS TOWEL BAR

WM00766

A useful accessory for any spa on which you can store your towel and clothes without them getting wet or creased. Folds away between uses.

Factory price: **\$35.94**



WELLIS SPAZIANO TRAY

WM00768

The plastic tray has a stainless steel support that can be mounted to the side panel of the spa cabinet and can also be rotated 360 degrees

Factory price: **\$86.25**



SPA COVER CLEANING TOWEL

WE00107

It helps keep the pool cover clean;
Weight: 0.79 lb;
Size: 3.2x3.2x8.3 in.

Factory price: **\$5.75**



SPA CLEANSER

WE00108

For fixing greases and oils and to keep the water clean

Factory price: **\$4.74**



SMART WATER ANALYZER FOR HOT TUBS USA

WV00116

Control the water quality in your spa anywhere, anytime

In addition to displaying the measured values in a clear, unambiguous way, the W.I.S. mobile application provides personalised recommendations for spa maintenance and the use of chemicals for accurate scheduling of dosing. You can also track and manage multiple supplies simultaneously to increase efficiency

Factory price: **\$310.00**



pH probe for Smart Water Analyzer

WV00109

Replacable PH probe sensor
for W.I.S; Weight: 0.11 lb;
Size: 0.4x2.4x2.4 in.

Factory price: **\$68.20**

ORP probe for Smart Water Analyzer

WV00110

Replacable ORP probe sensor
for W.I.S; Weight: 0.11 lb;
Size: 0.4x2.4x2.4 in.

Factory price: **\$76.59**

Conductivity probe for Smart Water Analyzer

WV00111

Replacable conductivity probe
sensor for W.I.S; Weight: 0.11 lb;
Size: 0.4x2.4x2.4 in.

Factory price: **\$76.59**



Calibration KIT for Smart water analyzer

WV00105

Calibration set for W.I.S. It helps recalibrate the device when it's necessary;
Weight: 1.1 lb; Size: 4.3x0.4x2.6 in.

Factory price: **\$22.77**



SPA DISPENSER

WE00072

This dispenser is designed for use of Bromine or Tri-Chloro-S-Triazinetrione tablets or sticks-slow dissolving type only.

Related product:WV00098

Factory price: **\$7.19**



SPA WAND VACUUM CLEANER V2

WE00104

Package contains: Slide-on brush, dual end nozzle, wall mounted bracket for storage, wide end nozzle, leaf skimmer

Factory price: **\$43.00**



SPA FILTER CLEANING SYSTEM

WE00045

Our new spa filter cleaning system is a unique patented filter cleaning system, designed to clean whirlpool and hot tub filters to perfection in just a flash.

Factory price: **\$104.65**



FILTER CLEANING BRUSH

WE00071

Suitable for use on pool or spa cartridge filters.

Factory price: **\$12.00**

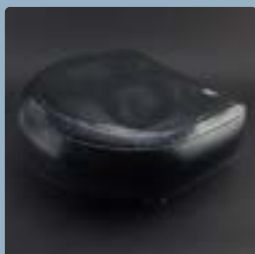
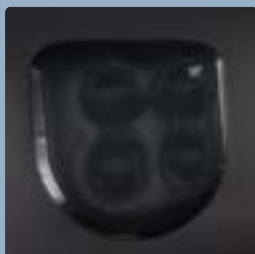

SPA BOOSTER SEAT

WE00070

Heavy-duty heat resistant material. Firmness and size can be adjusted by amount of water used. Suction cups prevent seat from floating or moving.

Factory price: **\$10.78**

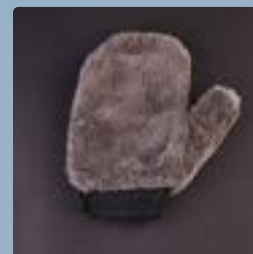

SPA-CLEANING GLOVES

WE00106

It helps keep the pool surface clean and tidy; Weight: 0.018 lb; Size: 3.2x3.2x6.3 in.

Factory price: **\$6.04**

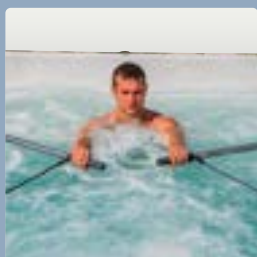
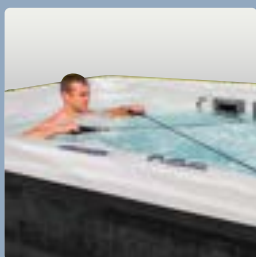

EXPANDER ROWING EQUIPMENT

Expander: WM00422

Rowing equipment: WM00421

TRAINING AND ROWING SET for swim spas

The expander combined with paddles offers the experience of real rowing. At the same time, the expander alone, fixed to the attachment on the side of the pool, can be used for a number of different fitness trainings.

Expander factory price: **\$80.00**

Rowing equipment factory price: **\$250.00**

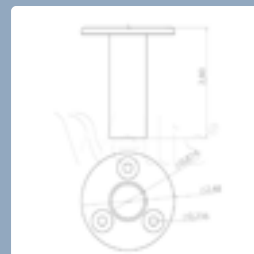
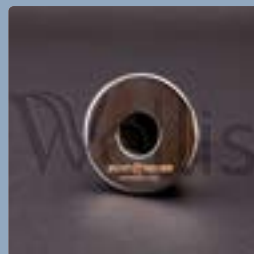

ADAPTER FOR SWIM TETHER

AKU2157

Weight: 0.483 lb; Material: Stainless Steel

Factory price: **\$39.22**

SWIM TETHER

WM00419

THE SECRET OF DYNAMIC SWIMMING TRAINING

It helps to keep the person performing swimming training in the middle of the swimming area, and more importantly, it can be used to increase resistance against the swimmer in the Swim spa, requiring even more effort. Using it may significantly increase the efficiency of the training. The flexible swim tether, made of fiberglass, is fixed to a spot created for this purpose at the end of the Swimming spa, and it is connected to the belt on the waist of the swimmer with a strong strap

Factory price: **\$165.00**



Cabinet Configuration

This will help you choose partial or complete cabinet for the given Model.

It can be set by:

- model
- part of the cabinet
- color of Cabinet
- installation;
- ventillation
- screws
- cover slats

Please follow through the navigation step by step.



SPA CABINET ELEMENT CONFIGURATOR

AKU2610

SWIM SPA CABINET ELEMENT CONFIGURATOR

AKU2646



Lightings

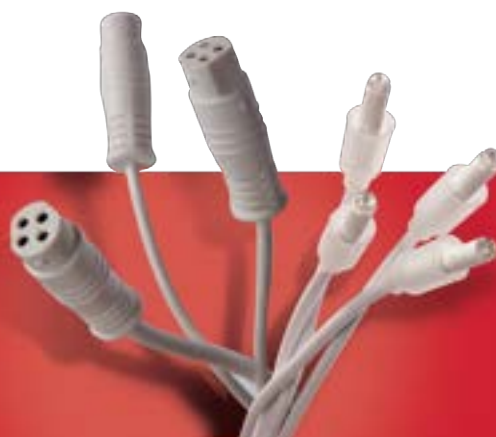

LED CONTROL BOX

Product code: **ACM0802**

Weight: **0.553 lb**; Temperature: ~ **122 F°**; Related product: **ACM0751, ACM0750, ACM0803, ACM0944**; Connection: **4 PIN; RGB**; Performance: **30 W**; Voltage: **10-20 VAC**; Current: **1.5-3 A**

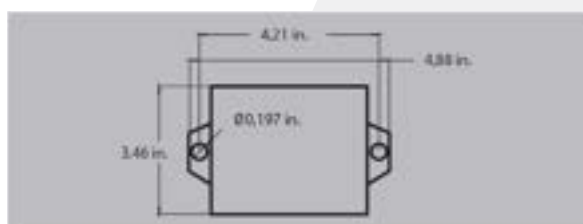

Factory price: **\$31.05**



LED LIGHT - FLAT LENS RD

Product code: **ABE0128**

Weight: **0.355 lb**; Temperature: ~ **122 F°**; Related product: **ABE0128, AKU2470**; Length: **59.1 in.**; Connection: **3x4 PIN; RG**

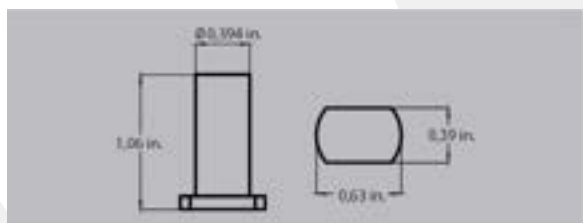

Factory price: **\$0.76**



LED LIGHT - LENS

Product code: **AKU2470**

Weight: **0.011 lb**; Temperature: ~ **122 F°** Contains: **Nut + Led hous**; Related products: **ABE0128, ACM0932**

Wellisparts®

Factory price: **\$1.22**

EXTENTION CABLE FOR LED LIGHT

Product code: ACM0750

Weight: **0.324 lb**; Temperature: ~ **122 F°**; Voltage: **5 V**; Number of leds: **7 PCS**; Connection: **4 PIN**; Related product: **ACM0531, ACM0750**; Current: **0.4 A**; RGB; Performance: **2 W**; Without controller



Factory price: **\$15.24**

UNDERWATER LIGHT - HOUSE RD

Product code: ACM0531

Weight: **0.604 lb**; Temperature: ~ **122 F°**; Related product: **AKU0026, ACM0803, ACM0749**

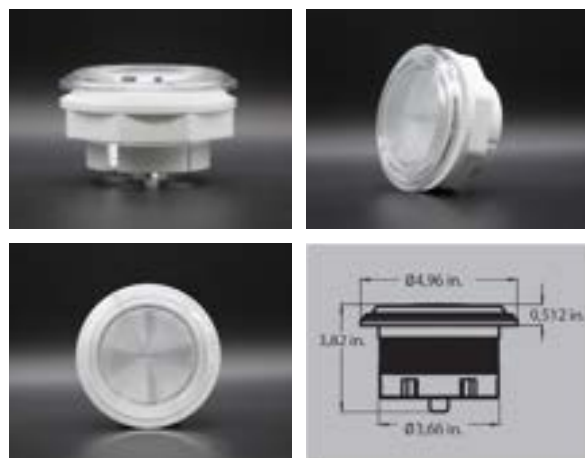

Factory price: **\$22.71**

UNDERWATER LIGHT - RGB (7 LEDS)

Product code: ACM0803

Weight: **0.324 lb**; Temperature: ~ **122 F°**; Voltage: **5 V**; Number of leds: **7 PCS**; Connection: **4 PIN**; Related product: **ACM0531, ACM0750**; Current: **0.4 A**; RGB; Performance: **2 W**; Without controller

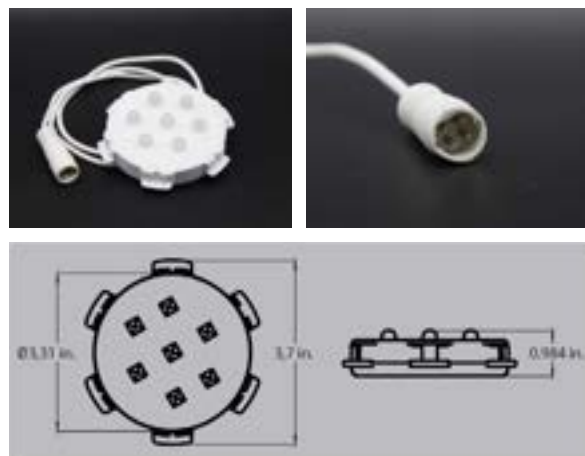

Factory price: **\$34.79**

UNDERWATER LIGHT - RGB WITH CONTROL (7 LEDS)

Product code: ACM0749

Weight: **0.489 lb**; Temperature: ~ **122 F°**; Voltage: **5 V**; Number of leds: **7 PCS**; Connection: **4 PIN**; Related product: **ACM0531, ACM0750**; Current: **2.4 A**; RGB; **Waterproof**; Performance: **12 W**; With controller

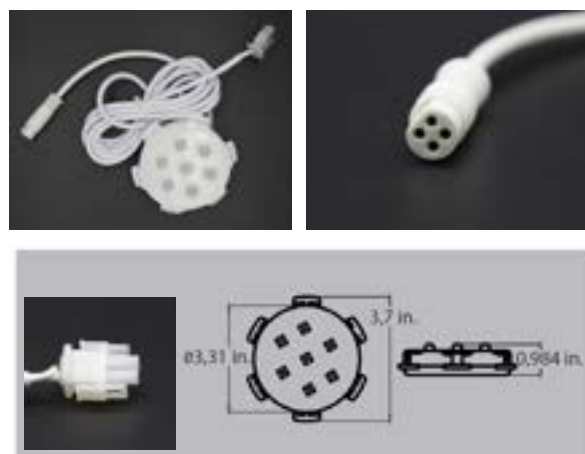

Factory price: **\$34.79**



WELLIS LOGO OVAL

Product code: *ACM0843*

Weight: **1.2 lb**; Material: **Stainless steel**; Voltage: **5 V**;
Connection: **4 PIN**

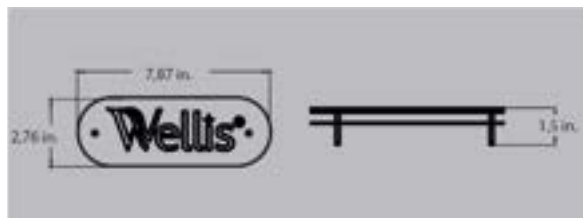

Factory price: **\$32.34**



CUP HOLDER LIGHT LENS

Product code: *AKU0056*

Weight: **0.19 lb**; Material: **PVC**; Temperature: ~ **122 F°**

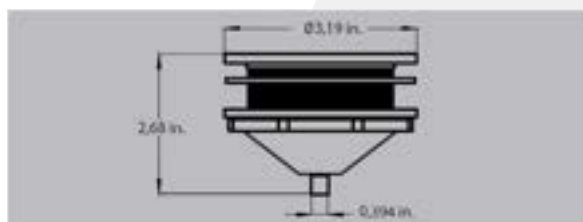

Factory price: **\$12.94**



HANDRAIL TRANSPARENT

Product code: *AKU2410*

Weight: **0.256 lb**; Temperature: **122 F°**; Material: **Plexi Transparent**

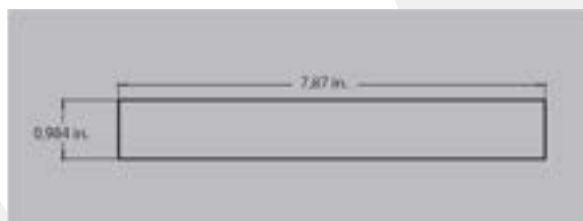

Factory price: **\$16.68**



SEAL FOR TRANSPARENT HANDRAIL

Product code: *AKU0072*

Weight: **0.0044 lb**; Related Product: **AKU0106**

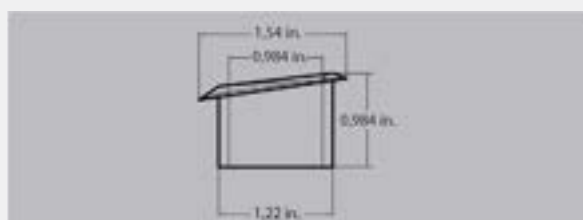

Factory price: **\$4.03**



LED 4-IN 12V-GATEWAY

Product code: ACM0865

Weight: **0.212 lb**; 6.5 × 2.4 × 1.2 in., 4 pins input connector, 0.08 × 24.8 in. LED, 0.08 × 59.8 in. LED, LED external diameter 0.2 in., internal 8 mm; Additional product: **ACM0866**

Factory price: **\$10.49**



LED DISTRIBUTOR Y 12V BATHTUB GATEWAY

Product code: ACM0866

Weight: **0.066 lb**; 5.5 × 1.8 × 0.4 in., 1 4 pins round connector, 1 4 pin plug, 1 4 pins connector, length 17.7 in. Additional product: **ACM0865**

Factory price: **\$5.32**



LED 4 RGB PROW V2

Product code: ACM0932

Weight: **0.165 lb**; Temperature: ~ **122 F°**; Related product: **ABE0128**, **AKU0050**; Length: **29.5 in.**; Connection: **4 PIN**; Number of leds: **4 PCS**; Max. performance: **1 W**; **RGB**

Factory price: **\$12.22**



LED LIGHT - RGB 75 CM (29.5 IN.)

Product code: ACM0827

Weight: **0.057 lb**; **1 led**; **29.5 in.**; **4 pin father**; **multicolor**; **5 V**

Factory price: **\$4.60**



STARSIDE CORNER LED

Product code: ACM0927

Weight: **0.437 lb**; Connector **1 pc.**; 4-pin socket; 1 pc. 4-pin plug; cable length **59.06 in.**; Ip44; 5 V

Factory price: **\$17.25**



LED 2 75CM (29.5 IN.) RGB PROW

Product code: ACM0826

Weight: **0.097 lb**; 2 led; **29.5 in.**; 4 pin father; multicolor; 5 V; 1 led; **29.5 in.** 4 pin father; multicolor; 5 V

Factory price: **\$4.60**

Wellisparts®



TRANSFORMER 12V UL

Product code: ACM0944

Weight: **2.47 in.**; **100-200V**, 50-60Hz, Output **13VDC 5A**, Class2 power supply, Model: **AQ-PSB-1**, IPX5, UL certification; Related product: **AE00271**, **AE00269**, **AE00272**, **AE00272**, **AE00273**, **ACM0802**

Factory price: **\$117.86**

Wellisparts®

Jets



Explanations of marks which take place in the names of the products:

"S"	Internal dimension
"Spigot"	External dimension
"SB"	External connector
"RB"	Ribbed external connector

AIR JET BODY CROSSING

Product code: AJ00124

Weight: **0.046 lb**; Material: **PVC**; Temperature: ~ 122 F°

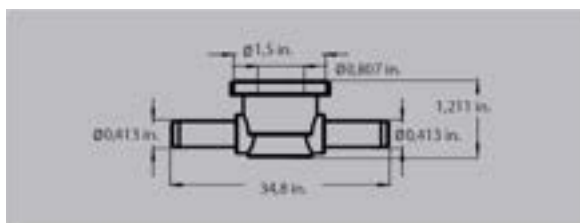

Factory price: **\$0.79**

JET 2" - TRANSPARENT 1 HOLE TRANSPARENT V3 WELLIS

Product code: AJ00214

Weight: **0.046 lb**; Material: **PVC**; Temperature: ~ 122 F°;
Related product: **AJ00226SET**; Compatible with: **AJ00220**

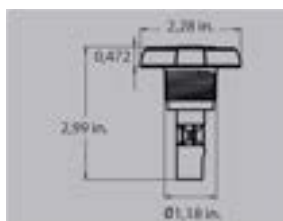

Factory price: **\$4.89**



JET 3" - TRANSPARENT 1 HOLE V3 WELLIS

Product code: AJ00216

Weight: **0.423 lb**; Material: **PVC**; Temperature: ~ 122 F°

Related product: **AJ00228SET**; Compatible with: **AJ00217, AJ00222, AJ00223**

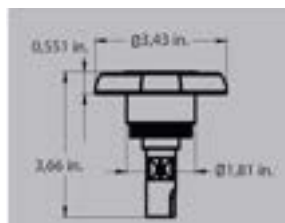

Factory price: **\$7.76**



JET 3" - TRANSPARENT 1 HOLE ROTATION TRANSPARENT V3 WELLIS

Product code: AJ00217

Weight: **0.882 lb**; Material: **PVC**; Temperature: ~ 122 F°

Related product: **AJ00216, AJ00222, AJ00223**

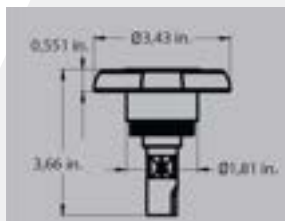

Factory price: **\$7.91**



JET 5" - TRANSPARENT 1 HOLE TRANSPARENT V3 WELLIS

Product code: AJ00218

Weight: **1.1 lb**; Material: **PVC, Stainless steel**; Temperature: ~ 122 F°

Related product: **AJ00230SET**; Compatible with: **AJ00219, AJ00224, AJ00225**

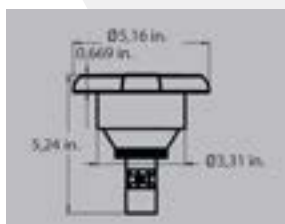

Factory price: **\$13.08**



JET 5" - TRANSPARENT 1 HOLE ROTATIONAL TRANSPARENT V3 WELLIS

Product code: AJ00219

Weight: **1.1 lb**; Material: **PVC, Stainless steel**; Temperature: ~ 122 F°

Related product: **AJ00230SE**; Compatible with: **AJ00218, AJ00224, AJ00225**

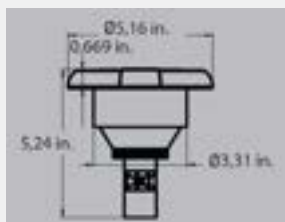

Factory price: **\$13.66**

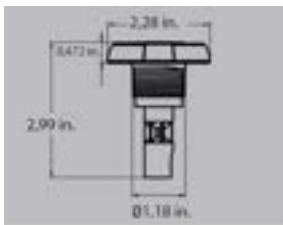

JET 2" - TRANSPARENT 1 HOLE TRANSPARENT V3 NEUTRAL

Product code: AJ00220

Weight: **0.423 lb**; Material: **PVC**; Temperature: ~ 122 F°

Related product: **AJ00226SET**; Compatible with: **AJ00214**

Factory price: **\$5.18**

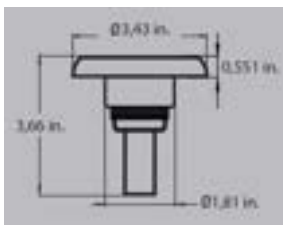

JET 3" - TRANSPARENT 1 HOLE TRANSPARENT V3 NEUTRAL

Product code: AJ00222

Weight: **0.423 lb**; Material: **PVC**; Temperature: ~ 122 F°

Related product: **AJ00228SET**; Compatible with: **AJ00216, AJ00217, AJ00223**

Factory price: **\$7.91**

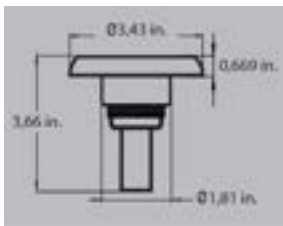

JET 3" - TRANSPARENT 1 HOLE ROTATIONAL TRANSPARENT V3 NEUTRAL

Product code: AJ00223

Weight: **0.423 lb**; Material: **PVC**; Temperature: ~ 122 F°

Related product: **AJ00228SET**; Compatible with: **AJ00216, AJ00217, AJ00222**

Factory price: **\$7.91**



JET 5" - TRANSPARENT 1 HOLE TRANSPARENT V3 NEUTRAL

Product code: AJ00224

Weight: **1.1 lb**; Material: **PVC, Stainless steel**; Temperature: ~ 122 F°

Related product: **AJ00230SET**; Compatible with: **AJ00218, AJ00219, AJ00225**

Factory price: **\$13.94**

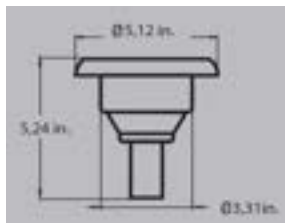

JET 5" - TRANSPARENT 1 HOLE ROTATIONAL TRANSPARENT V3 NEUTRAL

Product code: *AJ00225*

Weight: **1.1 lb**; Material: **PVC, Stainless steel**; Temperature: ~ **122 F°**
Related product: **AJ00230SET**; Compatible with: **AJ00218, AJ00219, AJ00224**

Factory price: **\$12.94**

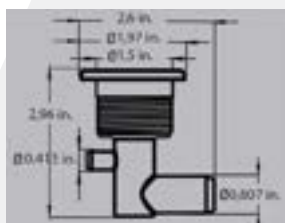

2" JET BODY V4 TRANSPARENT SET

Product code: *AJ00226SET*

Weight: **0.284 lb**; Material: **PVC**; Temperature: ~ **122 F°**
Related product: **AJ00214, AJ00220**; Contains: **LED adapter for 2" jet, Jet house 2" V4, Selfadjustable nut, Jet house sealing 2"**

Factory price: **\$3.88**

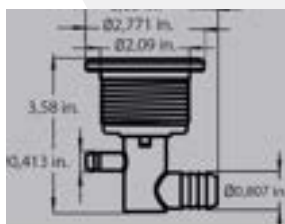

3" JET BODY V4 TRANSPARENT SET

Product code: *AJ00228SET*

Weight: **0.882 lb**; Material: **PVC**; Temperature: ~ **122 F°**
Related product: **AJ00216, AJ00217, AJ00222, AJ00223**
Contains: **Jet house 3" V4, Selfadjustable nut V4, Jet house sealing 3" V4**

Factory price: **\$5.75**

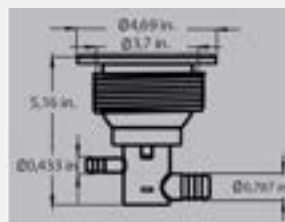

5" JET BODY V4 TRANSPARENT SET

Product code: *AJ00230SET*

Weight: **0.441 lb**; Material: **PVC**; Temperature: ~ **122 F°**
Related product: **AJ00218, AJ00219, AJ00224, AJ00225**
Contains: **Jet house 5" V4, Selfadjustable nut 5" V4, Jet house sealing 5" V4**

Factory price: **\$8.48**



AIR JET

Product code: AJ00210

Weight: **0.015 lb**; Material: **PVC, Stainless steel**; Temperature: ~ **122 F°**

Related product: **AJ00209**

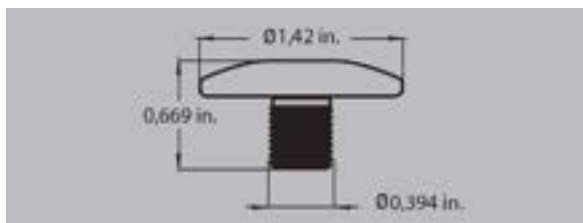

Factory price: **\$1.37**



AIR JET HOUSE

Product code: AJ00209

Weight: **0.024 lb**; Material: **PVC**; Temperature: ~ **122 F°**

Related product: **AJ00210**

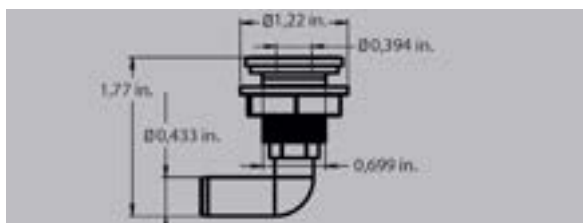

Factory price: **\$1.87**



JET WATER CIRCULATION SELF-LEVELLING SET

Product code: AJ00279

Weight: **0.053 lb**; Material: **PVC**; Temperature: ~ **122 F°**;
Contains: Jet water circulation self-leveling; Self adjusting sealing; Self adjusting nut

Wellisparts®

Factory price: **\$3.31**



JET SET FOR OXYGENTHERAPIE

Product code: AJ00233SET

Weight: **0.157 lb**; Material: **PVC**; Temperature: ~ **122F°**

Contains: Jet house; Jet house nut

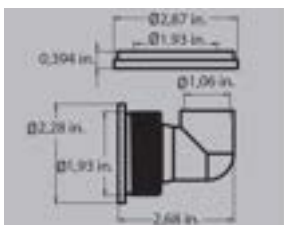

Factory price: **\$22.86**



JET NUT 7.5" STATIONARY

Product code: AJ00251

Weight: **0.241 lb**; Material: **PVC**; Temperature: ~ 122 F°

Related product: **AJ00262**

Wellisparts®

Factory price: **\$2.88**



JET 7.5" STATIONARY (WELLIS)

Product code: AJ00262

Weight: **1.73 lb**; Material: **PVC, Stainless steel**; Temperature: ~ 122 F°

Size: **7.48x7.28x7.28 in.**; Related product: **AJ00262**



Wellisparts®

Factory price: **\$33.06**

Regulators and diverters



WATER DIVERTER 60 - LED LIGHTED V2

Product code: AKU1891

Weight: **1.1 lb**; Material: **PVC**; Temperature: ~ 122 F°

Related product: **AKU1894, AKU2466, AKU1897** Replacement for: **AKU1891**

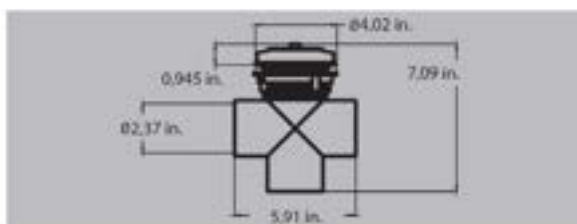

Factory price: **\$13.66**

AIR REGULATOR - HOUSE LED LIGHTED V2

Product code: AKU1892

Weight: **0.293 lb**; Material: **PVC**; Temperature: ~ 122 F°

Related product: **AKU1898, AKU1895, AKU2467**; Replacement for: **AKU1490**

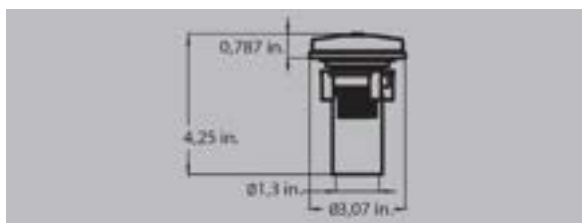

Factory price: **\$10.93**

ON-OFF TAP HOUSE 33 TRANSPARENT V2

Product code: AKU1893

Weight: **0.346 lb**; Material: **PVC**; Temperature: ~ 122 F°

Related product: **AKU1899, AKU1896, AKU2468**; Replacement for: **AKU1491 -hole expansion required**

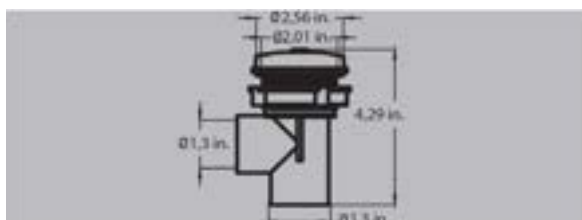

Factory price: **\$9.63**



WATER DIVERTER - GRIP WELLIS V2

Product code: AKU1894

Weight: **0.141 lb**; Material: **ABS**

Temperature: ~ 122 F°

Size: **3.35x3.9 in.**

Related product: **AKU1891**

Replaced product: **AKU1492**

Factory price: **\$7.91**



AIR REGULATOR GRIP WELLIS V2

Product code: AKU1895

Weight: **0.055 lb**; Material: **ABS**

Temperature: ~ 122 F°

Size: **2.5x2.8 in.**

Related product: **AKU1892**

Replaced product: **AKU1493**

Factory price: **\$2.73**



ON-OFF TAP GRIP WELLIS V2

Product code: AKU1896

Weight: **0.042 lb**; Material: **ABS**

Temperature: ~ 122 F°

Size: **2.2x2.4 in.**

Related product: **AKU1893**

Replaced product: **AKU1494**

Factory price: **\$3.59**



WATER DIVERTER - GRIP NATURAL V2

Product code: AKU1897

Weight: **0.112 lb**; Material: **ABS**

Temperature: ~ 122 F°; Size: **3.4x4.3 in.**

Related product: **AKU1891**

Replaced product: **AKU1495**

Factory price: **\$3.02**



AIR REGULATOR - GRIP NATURAL V2

Product code: AKU1898

Weight: **0.044 lb**; Material: **ABS**

Temperature: ~ 122F°; Size: **2.2x2.6 in.**

Related product: **AKU1892**

Replaced product: **AKU1496**

Factory price: **\$1.73**



ON-OFF TAP GRIP NATURAL V2

Product code: AKU1899

Weight: **0.038 lb**; Material: **ABS**

Temperature: ~ 122 F°; Size: **1.9x2.36 in.**

Related product: **AKU1893**

Replaced product: **AKU1497**

Factory price: **\$2.30**



WATER DIVERTER REPAIR KIT

Product code: AKU2466

Repair kit for **AKU1891** only for 2019 or later products

Contains: **sealing 2", Cover, Locking piece**



Wellisparts

Factory price: **\$7.19**



AIR REGULATOR REPAIR KIT

Product code: AKU2467

Repair kit for AKU1892 only for 2019 or later products;
Contains: **sealing 1", Cover, Locking piece**



Factory price: **\$5.46**



ON-OFF TAP REPAIR KIT

Product code: AKU2468

Repair kit for AKU1893 only for 2019 or later products;
Contains: **sealing 1", Cover, Locking piece**

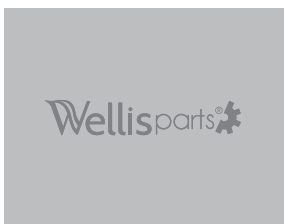

Factory price: **\$5.75**

Waterfalls

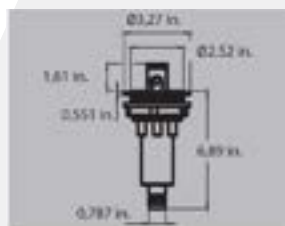

WATER POP-UP FOUNTAIN

Product code: AKU0044

Weight: **0.309 lb**; Material: **PVC**; Temperature: ~ 122 F°

Factory price: **\$23.00**

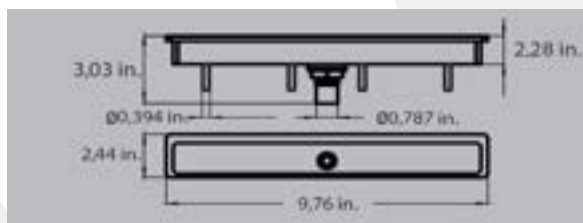

WATERFALL LED WITH LOGO V2

Product code: AKU1913

Weight: **0.761 lb**; Size: **11×3.5×3.4 in.**; Related product: **AKU1915**

Factory price: **\$29.18**

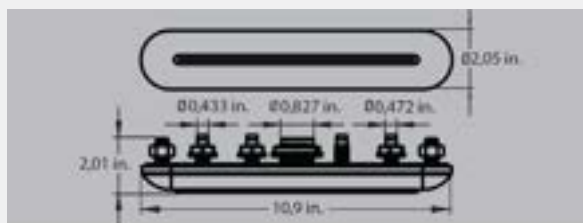

WATERFALL 276X51X48 MM (10.9X2.01X1.89 IN.)

Product code: AKU1916

Weight: **0.573 lb**; Material: **PVC**; Replacement of: **AKU1834**

Factory price: **\$25.88**



LAMINAR JET SPONGE V2

Product code: AE00605

Weight: **0.022 lb**; Material: **extruded ABS**; Size: **2.09x1.65x1.65 in.**

Related product: **AKU2101**



Factory price: **\$2.30**



FOUNTAIN LAMINAR V2

Product code: AKU2101

Weight: **0.306 lb**; Material: **PVC + Silicone + ABS**

Temperature: ~ **122 F°**; Related product: **AE00605**

Replacement for: **AKU1787**

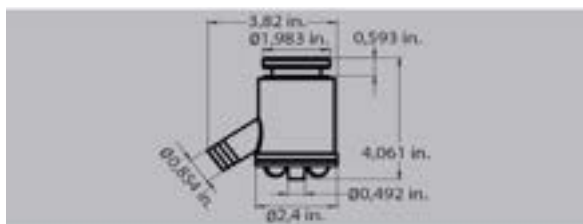

Factory price: **\$14.95**



WATERFALL SEALING 92X280X80 MM V2 (3.62X11X3.15 IN.)

Product code: AKU1915

Weight: **0.055 lb**; Material: **Silicone**; Size: **9.13x1.56x0.09 in.**

Related product: **AKU1913**



Factory price: **\$2.73**



FOUNTAIN LAMINAR V3

Product code: AKU2625

New design, new opening on the top to change the filter

Weight: **0.337 lb**; Material: **PVC**; Temperature: ~ **122 F°**;

Size: **4.17x2.56x3.82 in.**; Related product: **AKU2626**



Factory price: **\$18.40**



Wellisparts®

LAMINAR JET SPONGE V3

Product code: AKU2626

Weight: **0.042 lb**; Material: **ABS**; Size: **2.09x1.34x1.34 in.**;

Related product: **AKU2625**

Factory price: **\$2.88**



Wellisparts®

INLET 8" CHROME V2

Product code: AKU2471

Weight: **0.418 lb**; Material: **Chrome + PVC**; Size: **10.6x1.5x1.65 in.**;

Related product: **ABE0360**

Factory price: **\$11.79**



FONTAIN-CUP HOLDER SET WELLIS

Product code: AKU2746

Replacement of: **AKU0044** -hole expansion required

Contains: **Fontain-cup house, Fontain-cup nut, barb fitting for Fontain-cup**

Factory price: **\$16.03**

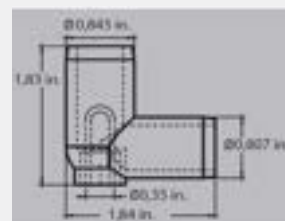

BARB FITTING FOR WATERFALL

Product code: ABE0360

Weight: **0.035 lb**; Material: **Plastic**; Temperature: ~ **122 F°**

Related product: **AKU1916**

Factory price: **\$1.70**

Pipes

**PIPE - TRANSPARENT**Material: **PVC**; Temperature: ~ **122 F°**; Max. pressure: **29 psi**

ABE0385 for Air Regulator; ABE0008 for Water

Product code	Diameter (in.)		Weight (lb/yd)	Min. order quantity (yard)	Factory price
	A	B			Dollar per meter (\$/yd)
ABE0385	0.55	0.39	0.182	by 1,09 yd	1.45
ABE0008	1.02	0.79	0.53	by 1,09 yd	2.77

**PIPE - FIBER REINFORCED
- 25/20 MM (0.984/0.787 IN.)
WHITE**Product code: *AE00144*Weight: **0.463 lb/yd**;

Purchasing unit is by meter

Diameter (in.)	
A	B
0.98	0.79

Factory price: **\$1.58/m****PIPE - FIBER REINFORCED
FLEXIBLE - 32/25 MM
(1.26/0.984 IN.) WHITE**Product code: *ABE0009*Weight: **0.89 lb/yd**; Material: **PVC**;Temperature: ~ **122 F°**

Diameter (in.)	
A	B
1.26	0.98

Factory price: **\$4.03/m**



PIPE - PVC WHITE

Material: **PVC**; Temperature: ~ **122 F°**; Max pressure: **29 psi**

Product code	Diameter (in.)		Weight (lb/yd)	Min. order quantity (yard)	Factory price
	A	B			Dollar per meter (\$/m)
ABE0041	1.26	1.06	0.720	2.19 or 4.37	2.9
ABE0032	1.89	1.65	1.468	2.19 or 4.3	4.88
ABE0324	1.97	1.69	1.670	2.19 or 4.3	4.35
ABE0328	2.36	2.05	2.146	2.19 or 4.3	7.92



PIPE - PVC 63 MM (2.43 IN.)

Product code: *ABE0014*

Material: **PVC**; Temperature: ~ **122 F°**;
Max. pressure: **29 psi**; Minimum order quantity: **2.19 yards**

Diameter (in.)	
A	B
2.48	2.37

Factory price: **\$3.59/m**



PIPE - FIBER FLEXIBLE REINFORCEMENT

Material: **PVC**; Temperature: ~ **122 F°**; Max. pressure: **29 psi**

Product code	Diameter (in.)		Weight (lb/yd)	Min. order quantity (yd/roll)	Factory price
	A	B			Dollar per meter (\$/yd)
ABE0322	1.3	1.06	0.736	by 1.09 yd	2.64
ABE0318	1.97	1.65	1.404	by 1.09 yd	4.61
ABE0319	2.36	2.05	1.927	by 1.09 yd	7.27
ABE0524	2.87	2.48	0.771	by 1.09 yd	18.86



PIPE 33 MM (1.3 IN.) PVC

Product code: *ABE0327*

Weight: **0.367 lb/yd**; Material: **PVC**;
Temperature: ~ **122 F°**

Diameter (in.)	
A	B
1.31	1.009

Factory price: **\$3.45/m**



PIPE 48 MM (1.89 IN.) PVC

Product code: ABE0325

Weight: **1.358 lb/yd**; Material: **PVC**;
Temperature: ~ **122 F°**

Diameter (in.)	
A	B
1.91	1.65

Factory price: **\$6.18/m**



PIPE FIBER REINFORCED 21 MM (0.827 IN.)

Product code: ABE0321

Weight: **0.418 lb/yd**; Material: **PVC**;
Temperature: ~ **122 F°**

Diameter (in.)	
A	B
0.86	0.69

Factory price: **\$4.03/m**



PIPE FIBER REINFORCED 32 MM (1.26 IN.)

Product code: ABE0316

Weight: **0.097 lb/yd**; Material: **PVC**;
Temperature: ~ **122 F°**

Diameter (in.)	
A	B
1.26	1.06

Factory price: **\$4.31/m**



PIPE FIBER REINFORCED 48 MM (1.89 IN.)

Product code: ABE0317

Weight: **1.697 lb/yd**; Material: **PVC**;
Temperature: ~ **122 F°**

Diameter (in.)	
A	B
1.91	1.65

Factory price: **\$7.62/m**

Fittings

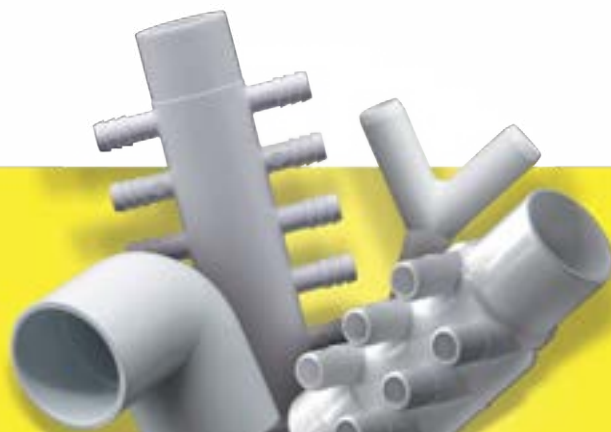

Explanations of marks which take place in the names of the products:

"S"	Internal dimension
"Spigot"	External dimension
"SB"	External connector
"RB"	Ribbed external connector



ELBOW - 20 S × 10 RB (0.787 X 0.394 IN)

Product code: ABE0173

DN: **0.79-0.39 in.**; **S-SB connection**; Material: **PVC**; Color: **White**;
Temperature: ~ **122 F°**; All connections can be glued

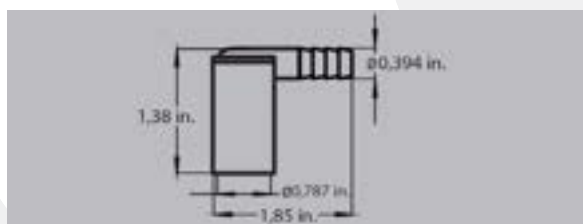

Factory price: **\$3.74**

Product code	A in.	B in.	C in.	Weight lb	Factory price Dollar (\$)
ABE0337	1.26	1.57	2.36	0.073	1.08
ABE0092	1.89	2.2	3.54	0.220	2.73
ABE0048	1.97	2.28	3.62	0.265	3.16
ABE0100	2.36	2.68	4.33	0.417	4.31



ELBOW - 33 (1.299 IN.) SPIGOT × 20 (0.787 IN.) SB 90°

Product code: ABE0122

DN: 1.3-0.79 in. S-SB connection; Material: PVC; Color: White;

Temperature: ~ 122 F°; All connections can be glued

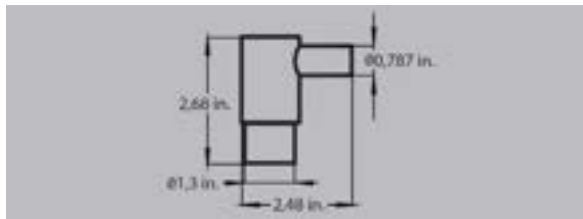

Factory price: **\$1.73**



ELBOW - SPIGOT × S

Material: PVC; Temperature: ~122 F°

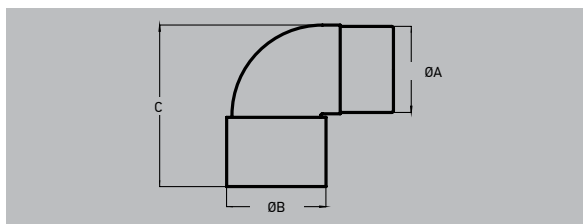

Product code	A in.	B in.	C in.	Weight lb	Factory price Dollar (\$)
ABE0281	1.3	1.61	2.83	0.104	2.16
ABE0098	1.89	2.20	3.39	0.207	4.31



ELBOW 45° - 60.3 (2.374 IN.) S × 60.3 (2.374 IN.) SPIGOT 45°

Product code: ABE0101

DN: 2.36 in. S-SB connection; Material: PVC; Color: White;

Temperature: ~ 122 F°;

All connections can be glued

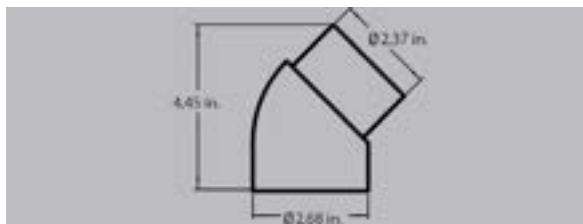

Factory price: **\$3.95**



SWEEP ELBOW - 60.3 (2.374 IN.) SPIGOT × 60.3 (2.374 IN.) S

Product code: ABE0103

DN: 2.36 in. S-SB connection; Material: PVC; Color: White;

Temperature: ~ 122 F°;

All connections can be glued

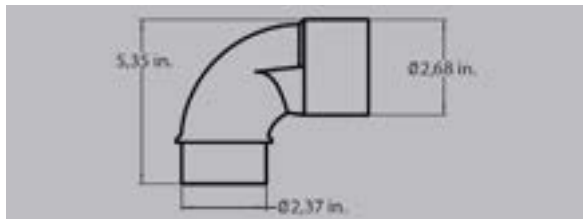

Factory price: **\$5.18**

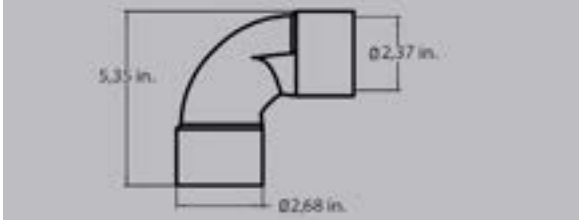

SWEEP ELBOW - 60.3 (2.374 IN.) S × 60.3 (2.374 IN.) S

Product code: ABE0102

DN: 2.36 in. S-S connection; Material: PVC; Color: White;
Temperature: ~ 122 F°;
All connections can be glued

Factory price: **\$5.61**

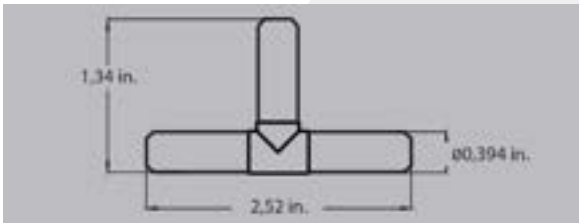

TEE - 10 SB × 10 SB × 10 SB (0.394X0.394X0.394 IN.)

Product code: ABE0046

DN: 0.39 in.; Material: PVC; Color: White; Temperature: ~ 122 F°;
SB-SB-SB
All connections can be glued or clamped

Factory price: **\$0.72**

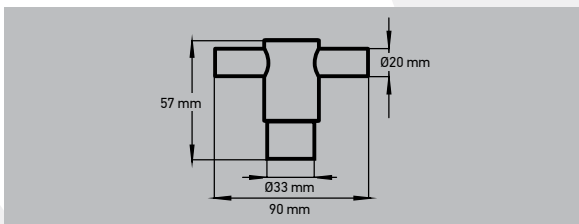

TEE - 33 (1.299 IN.) SPIGOT × 20 (0.787 IN.) SB

Product code: ABE0121

DN: 1.3-0.79 in.; Material: PVC; Color: White; Temperature: ~ 122 F°;
SB-S-SB
All connections can be glued

Factory price: **\$1.87**

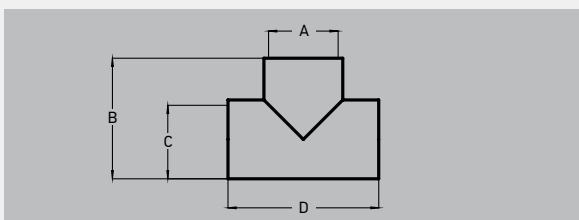

TEE - S × S × S

Material: PVC; Temperature: ~ 122 F°

Product code	A in.	B in.	C in.	D in.	Weight lb	Factory price Dollar (\$)
ABE0088	1.89	3.62	2.2	5	0.326	4.03
ABE0089	2.36	4.33	2.68	5.94	0.54	5.75



TEE - 60.3 SPIGOT × 60.3 SPIGOT × 60.3 SPIGOT (2.374X2.374X2.374 IN.)

Product code: AM00125

DN: 2.36 in. **SB-SB-SB connection**; Material: **PVC**; Color: **White**; Temperature: ~ 122 F°
All connections can be glued

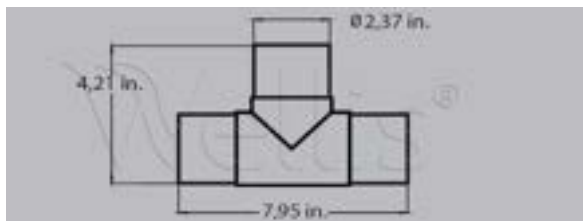

Factory price: **\$4.03**



TEE 32 (1.26 IN.) S

Product code: ABE0338

DN: 1.26 in.; Material: **PVC**; Color: **White**; Temperature: ~ 122 F°;
S-S-S connection
All connections can be glued

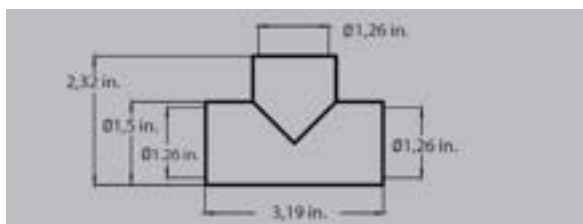

Factory price: **\$4.17**



TEE - 73 S × 73 S × 73 S (2.874X2.874X2.874 IN.)

Product code: ABE0523

DN: 2.87 in.; Material: **PVC**; Color: **White**; Temperature: ~ 122 F°;
S-S-S connection
All connections can be glued

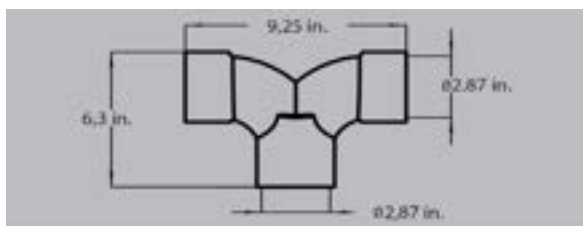

Factory price: **\$5.50**



WYE - 20 SB × 20 SB × 20 SB (0.787X0.787X0.787 IN.)

Product code: ABE0056

DN: 0.79 in.; Material: **PVC**; Color: **White**; Temperature: ~ 122 F°;
SB-SB-SB connection
All connections can be glued or clamped

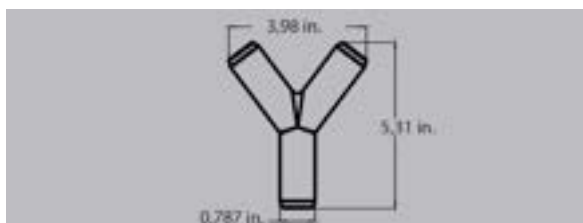

Factory price: **\$2.73**

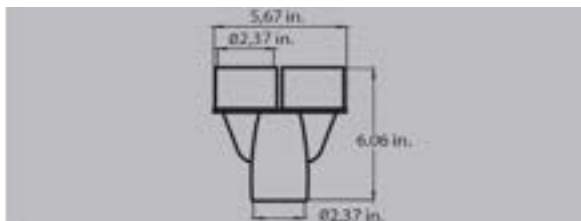

WYE - 60.3 S × 60.3 S × 60.3 S (2.374X2.374X2.374 IN.)

Product code: ABE0104

DN: 2.36 in.; Material: PVC; Color: White; Temperature: ~ 122F° ;
S-S-S connection

All connections can be glued

Factory price: **\$11.07**

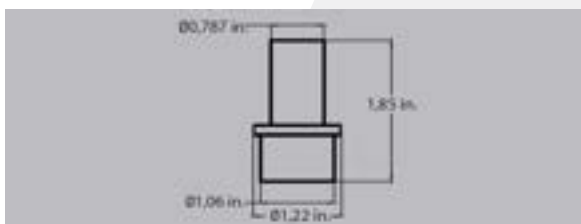

REDUCER - 20 (0.787 IN.) SB × 27 (1.06 IN.) S

Product code: ABE0108

DN: 1.06-0.79 in. SB-S connection; Material: PVC; Color: White;
Temperature: ~ 122 F°; All connections can be glued

Factory price: **\$1.73**

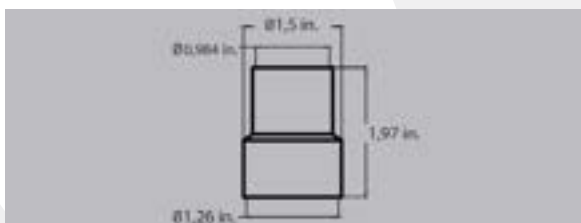

REDUCER - 33 (1.3 IN.) S × 32 (1.26 IN.) S

Product code: ABE0053

DN: 1.26-0.98 in., S-S connection; Material: PVC; Color: White;
Temperature: ~ 122 F°; All connections can be glued

Factory price: **\$1.22**

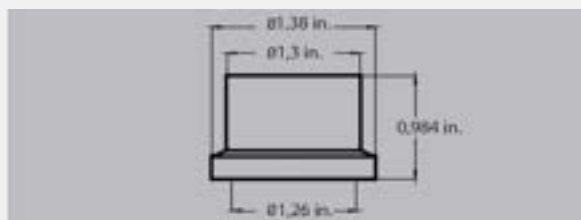

REDUCER - 33 (1.3 IN.) SPIGOT × 32 (1.26 IN.) S

Product code: ABE0164

DN: 1.3-1.26 in. SB-S connection; Material: PVC; Color: White;
Temperature: ~ 122 F°; All connections can be glued

Factory price: **\$1.44**



REDUCER - 48 (1.89 IN.) SPIGOT × 26 (1.02 IN.) S

Product code: ABE0058

DN: 1.89-1.02 in. S-S connection; Material: PVC; Color: White; Temperature: ~ 122 F°; All connections can be glued

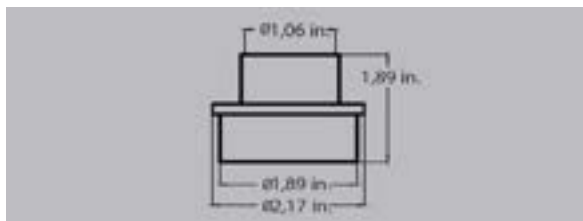

Factory price: **\$2.16**



REDUCER - 48 (1.89 IN.) SPIGOT × 33 (1.3 IN.) S

Product code: ABE0392

DN: 1.89-1.3 in. SB-S connection; Material: PVC; Color: White; Temperature: ~ 122 F°; All connections can be glued

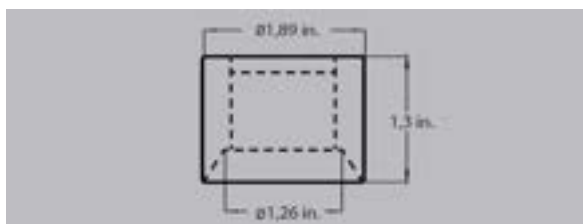

Factory price: **\$1.37**



REDUCER - 50 (1.97 IN.) S × 32 (1.26 IN.) S

Product code: ABE0054

DN: 1.97-1.26 in. S-S connection; Material: PVC; Color: White; Temperature: ~ 122 F°; All connections can be glued

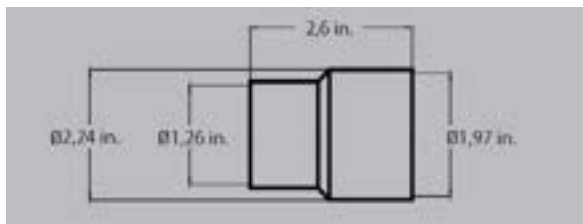

Factory price: **\$2.59**



REDUCER - 50 (1.97 IN.) SPIGOT × 32 (1.26 IN.) S

Product code: ABE0068

DN: 1.97-1.26 in. SB-S connection; Material: PVC; Color: White; Temperature: ~ 122 F°; All connections can be glued

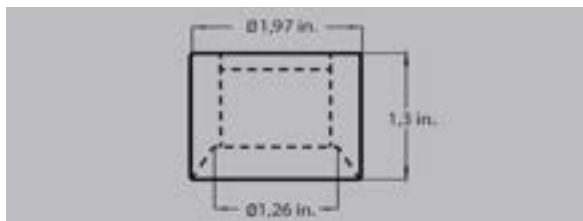

Factory price: **\$2.44**

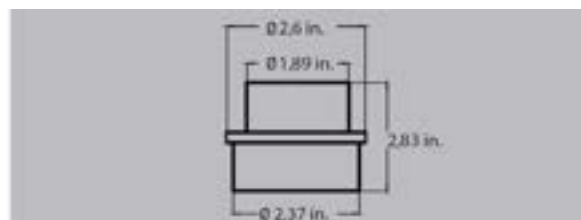

REDUCER - 60.3 (2.37 IN.) S × 48 (1.89 IN.) S

Product code: ABE0132

DN: 2.36-1.89 in., SB-SB connection; Material: PVC; Color: White; Temperature: ~ 122 F°; All connections can be glued

Factory price: **\$6.61**

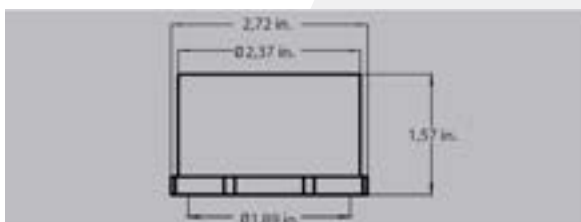

REDUCER - 60.3 (2.37 IN.) SPIGOT × 48 (1.89 IN.) S

Product code: ABE0099

DN: 2.36-1.89 in., SB-S connection; Material: PVC; Color: White; Temperature: ~ 122 F°; All connections can be glued;

Factory price: **\$2.44**

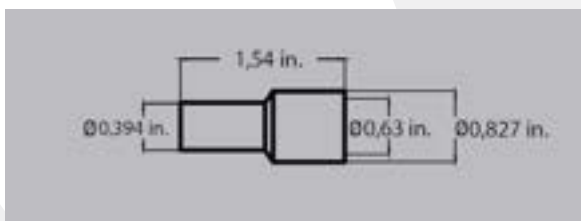

REDUCER - 16 (0.63 IN.) S × 10 (0.394 IN.) SPIGOT

Product code: ABE0060

DN: 0.63-0.39 in., SB-S connection; Material: PVC; Color: White; Temperature: ~ 122 F°; All connections can be glued

Factory price: **\$1.87**

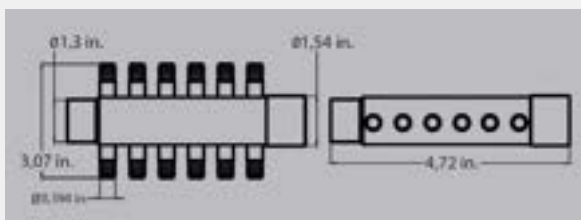

MANIFOLD - 33 S × 33 SPIGOT × (12 PCS) 10 SB (1.3X1.3X0.394 IN.)

Product code: ABE0095

DN: 1.3-0.39 in., SB-S connection; Material: PVC; Color: White; Temperature: ~ 122 F°; All connections can be glued; 12 DN0.39 branches

Factory price: **\$9.49**

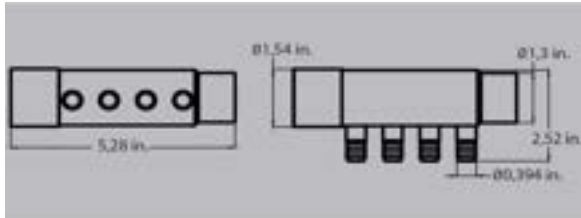

MANIFOLD - 33 S × 33 SPIGOT × (4PCS) 10 SB (1.3X1.3X0.394 IN.)

Product code: ABE0107

DN: 1.3-0.39 in., SB-S connection; Material: PVC; Color: White; Temperature: ~ 122 F°; All connections can be glued; 4 DN0.39 branches; Can be expanded

Factory price: **\$3.88**

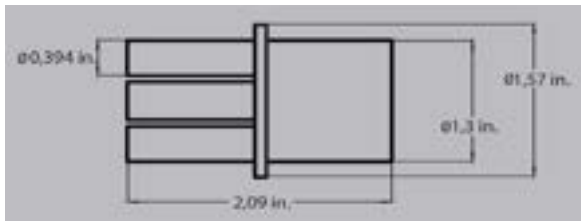

MANIFOLD - 33 SPIGOT × (4 PCS) 10 SB (1.3X0.394 IN.)

Product code: ABE0119

DN: 1.3-0.39 in., SB-S connection; Material: PVC; Color: White; Temperature: ~ 122 F°; All connections can be glued; 4 DN0.39 branches

Factory price: **\$1.08**

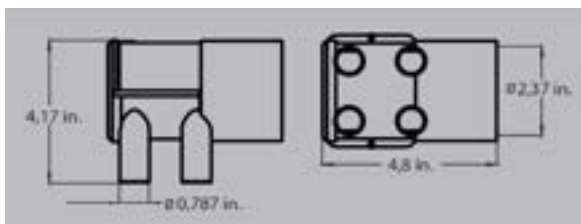

MANIFOLD - 60.3 S × (4 PCS) 20 SB (2.37X0.787 IN.)

Product code: ABE0120

DN: 2.36-0.79 in., SB-S connection; Material: PVC; Color: White; Temperature: ~ 122 F°; All connections can be glued; 4 DN0.79 branches; Closed end

Factory price: **\$5.75**

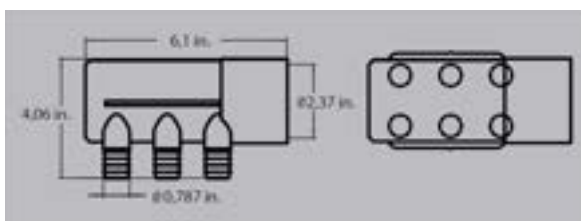

MANIFOLD - 60.3 S × (6 PCS) 20 SB (2.37X0.787 IN.)

Product code: ABE0097

DN: 2.36-0.79 in., SB-S connection; Material: PVC; Color: White; Temperature: ~ 122 F°; All connections can be glued; 6 DN0.79 branches; Closed end

Factory price: **\$6.18**



MANIFOLD - 60.3 S × (5 PCS) 33 SB (2.37X1.3 IN.)

Product code: ABE0131

DN: 2.36-0.79 in., S-S connection; Material: PVC; Color: White;
Temperature:~ 122 F°; All connections can be glued; 5 DN1.3 branches|

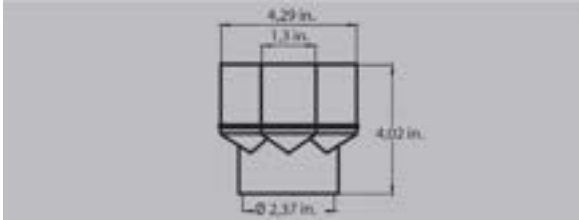

Factory price: **\$19.26**



MANIFOLD - 60.3 S × 60.3 S × (12 PCS) 20 SB (2.37X2.37X0.787 IN.)

Product code: ABE0123

DN: 2.36-0.79 in., S-S connection; Material: PVC; Color: White;
Temperature:~ 122 F°; All connections can be glued; 12 DN0.79
branches| Can be expanded

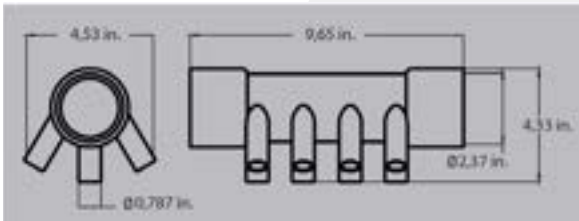

Factory price: **\$10.49**



MANIFOLD - 60.3 S × 60.3 S × (6 PCS) 20 SB (2.37X2.37X0.787 IN.)

Product code: ABE0125

DN: 2.36-0.79 in., S-S connection; Material: PVC; Color: White;
Temperature:~ 122 F°; All connections can be glued; 6 DN0.79
branches

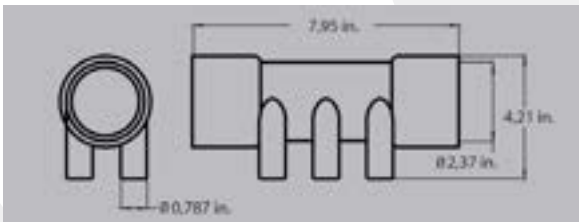

Factory price: **\$7.19**



MANIFOLD - 60.3 S × 60.3 SPIGOT × (12 PCS) 20 SB (2.37X2.37X0.787 IN.)

Product code: ABE0124

DN: 2.36-0.79 in., SB-S connection; Material: PVC; Color: White;
Temperature:~ 122 F°; All connections can be glued; 12 DN0.79
branches| Can be expanded

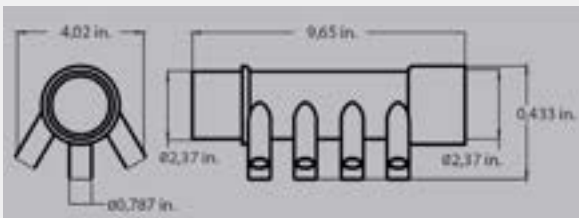

Factory price: **\$10.06**



MANIFOLD - 60.3 S × 60.3 SPIGOT × (4 PCS) 20 SB (2.37X2.37X0.787 IN.)

Product code: ABE0109

DN: 2.36-0.79 in., SB-S connection; Material: PVC; Color: White; Temperature:~ 122 F°; All connections can be glued; 4 DN0.79 branches; Can be expanded

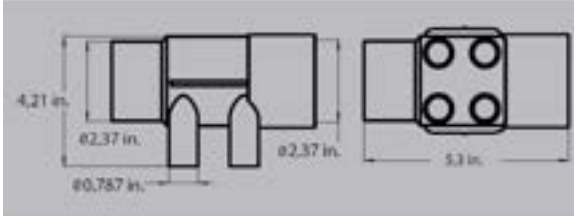

Factory price: **\$6.33**



MANIFOLD - 60.3 S × 60.3 SPIGOT × (6 PCS) 20 SB (2.37X2.37X0.787 IN.)

Product code: ABE0096

DN: 2.36-0.79 in., SB-S connection; Material: PVC; Color: White; Temperature:~ 122 F°; All connections can be glued; 6 DN0.79 branches; Can be expanded

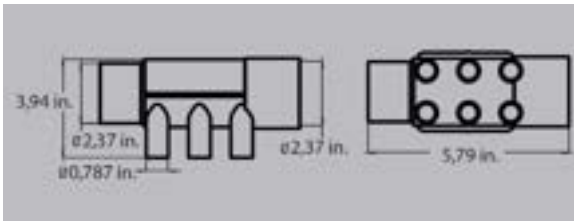

Factory price: **\$7.19**



MANIFOLD - 60.3 S × 60.3 SPIGOT × (10 PCS) 20 SB (2.37X2.37X0.787 IN.)

Product code: ABE0284

DN: 2.36-0.79 in., SB-S connection; Material: PVC; Color: White; Temperature:~ 122 F°; All connections can be glued; 10 DN0.79 branches; Can be expanded

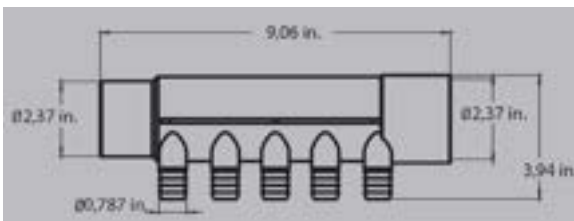

Factory price: **\$8.48**



MANIFOLD - 60.3 (2.37 IN.) S × (6 PCS) 20 (0.787 IN.) SB - WITH DRAIN

Product code: ABE0286

DN: 2.36-0.79 in., SB-S connection; Material: PVC; Color: White; Temperature:~ 122 F°; All connections can be glued; 6 DN0.79 branches; With DN0.79 drain option

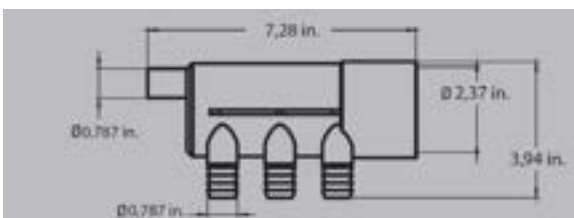

Factory price: **\$4.89**

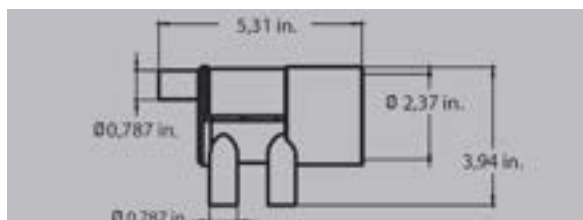

MANIFOLD - 60.3 S × (4 PCS) 20 SB - WITH DRAIN (2.37X0.787 IN.)

Product code: ABE0283

DN: 2.36-0.79 in., SB-S connection; Material: **PVC**; Color: **White**;
Temperature:~ 122 F°; All connections can be glued; 4 DN0.79
branches| With DN0.79 drain option

Factory price: **\$3.16**

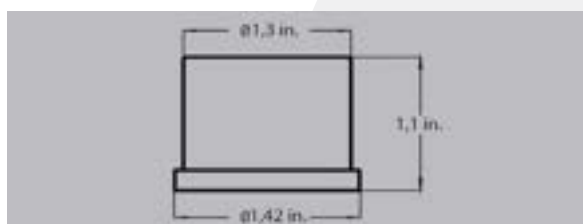

PLUG - 33 (1.3 IN.) SPIGOT

Product code: ABE0134

DN: 1.3 in.; Conical design; Material: **PVC**; Color: **White**;
Temperature:~ 122 F°; Can be glued

Factory price: **\$2.16**

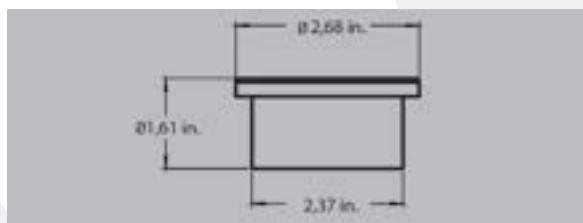

PLUG - 60.3 (2.37 IN.) SPIGOT

Product code: AE00181

DN: 2.36 in.; Material: **PVC**; Color: **White**; Temperature:~ 122 F°; Can
be glued

Factory price: **\$5.18**

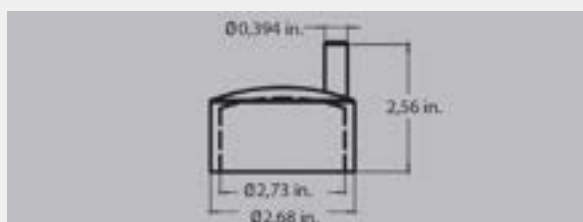

PLUG - 60.3 SPIGOT (2.37 IN.) - WITH DRAIN

Product code: ABE0282

DN: 2.36 in. S; Material: **PVC**; Color: **White**; Temperature:~ 122 F°;
Can be glued;
DN: with 0.39 in. SB drain hole

Factory price: **\$2.16**

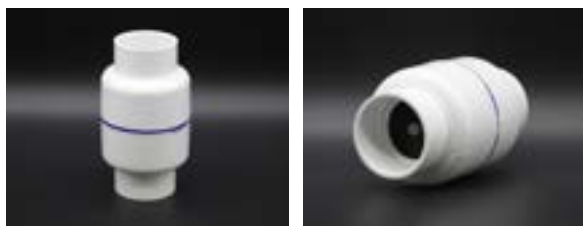

CHECK VALVE (AIR) - 48 (1.89 IN.) S × 48 (1.89 IN.) S

Product code: ABE0166

DN: **1.89 in. SB-S connection**; Material: **PVC**; Color: **White**; Max: **188.5 psi**; Temperature: ~ **122 F°**; All connections can be glued

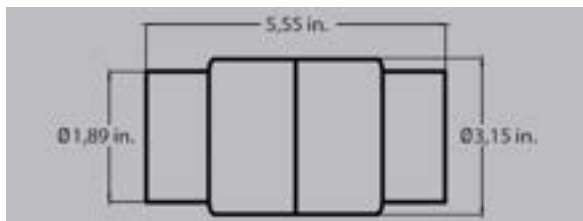

Factory price: **\$10.78**

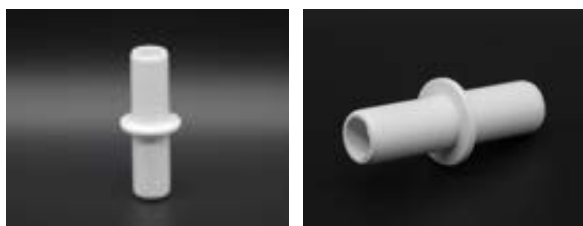

COUPLING - 20 (0.787 IN.) SPIGOT × 20 (0.787 IN.) SPIGOT

Product code: ABE0149

DN: **0.79 in.**; Material: **PVC**; Color: **Black**; Temperature: ~ **122 F°**; Sb-Sb; All connections can be glued

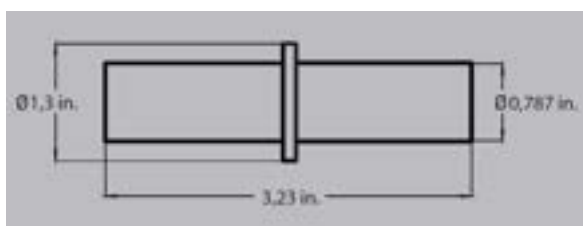

Factory price: **\$0.79**



COUPLING FOR DRAIN - 25 CORE THREAD × 25 THREAD (0.984X0.984 IN.)

Product code: AKU0103

DN: **1.26-0.866 in. with threaded end**; Material: **PVC**; Color: **Grey**; Temperature: ~ **122 F°**; Sb-S;

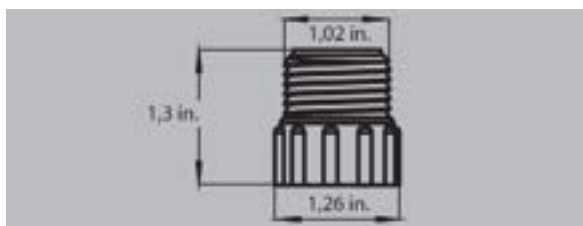

Factory price: **\$2.88**



COUPLING - 33 (1.3 IN.) S × 40 (1.57 IN.) THREAD

Product code: ABE0135

DN: **1.57-1.3 in.**; Material: **PVC**; Color: **Black**; Temperature: ~ **122 F°**; External threaded connection, glueable

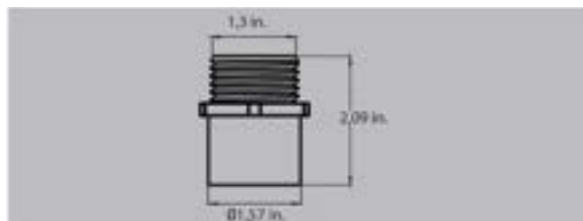

Factory price: **\$2.88**



GATE VALVE - 60.3 (2.37 IN.) S × 60.3 (2.37 IN.) S

Product code: ABE0091

DN: **2.36 in.**; Material: **PVC**; Color: **White**; Temperature: ~ **122 F°**; S-S
All connections can be glued; 2 positions (Open / Closed)

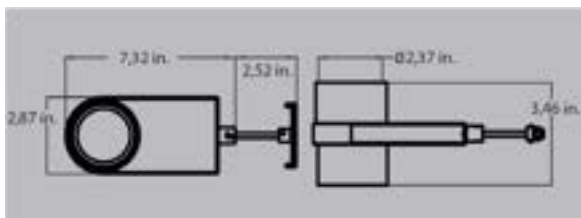

Factory price: **\$19.41**



UNION - 32 (1.26 IN.) S × 32 (1.26 IN.) S

Product code: ABE0150

DN: **1.26 in.**; Material: **PVC**; Color: **Gray**; Temperature: ~ **122 F°**;
S - connections pipe side can be glued

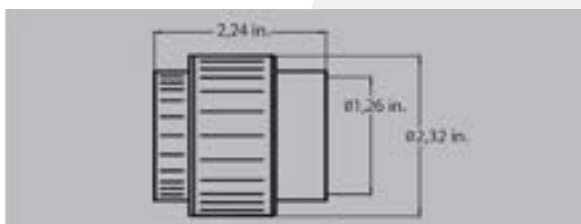

Factory price: **\$5.46**



WATER DRAIN - 20 (0.787 IN.) RB V2

Product code: AKU0084

DN: **0.79 in. threaded connection**; Material: **PVC**; Color: **black**;
Temperature: ~ **122 F°**;

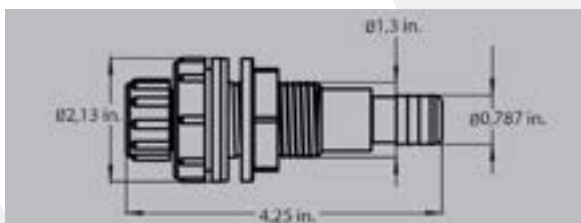

Factory price: **\$12.22**



WATER DRAIN - 50 (1.97 IN.)RB

Product code: AKU0025

DN: **1.97 in. threaded** - DN: **1.97 K connection**; Material: **PVC**; Color: **black**;
Temperature: ~ **122 F°**; Can be glued and clamped

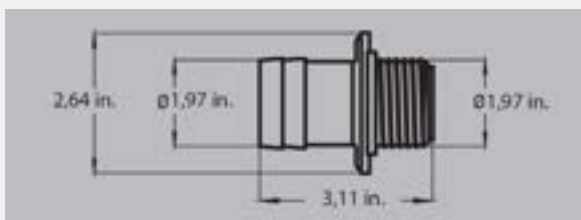

Factory price: **\$5.61**



DRAIN FOR CHAMPAGNE HOLDER (CHAMPAGNE JET)

Product code: AJ00090

Weight: **0.033 lb**; Material: **PVC, Stainless steel**; Temperature: ~ **122 F°**; Related product: **AKU0046**

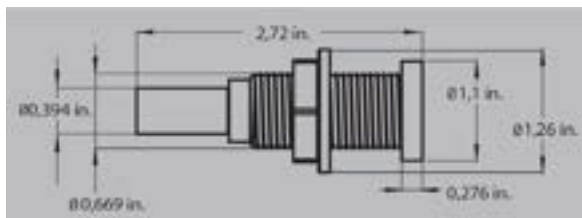

Factory price: **\$4.03**



REDUCER 10 (0.394 IN.) SB -20 (0.787 IN.) S

Product code: ABE0059

DN: **0.79-0.39 in.**; **SB-S connection**; Material: **PVC**; Color: **White**; Temperature: ~ **122 F°**; All connections can be glued

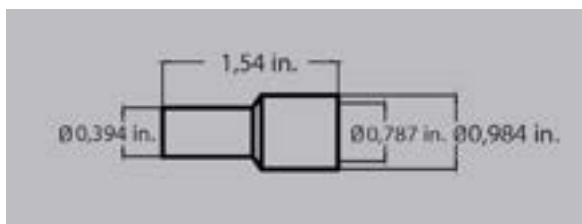

Factory price: **\$2.30**



PLUG TAPERED 16-14 (0.63X0.551 IN.)

Product code: ABE0313

DN: **0.63 in.**; Material: **PVC**; Color: **White**; Temperature: ~ **122 F°**; Can be glued

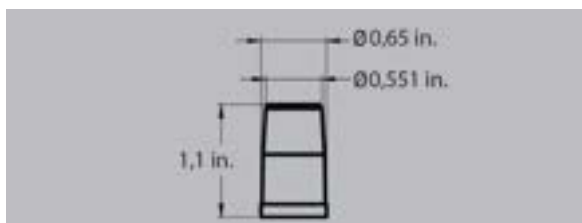

Factory price: **\$0.46**



REDUCER 40 (1.57 IN.) SPIGOT × 32 (1.26 IN.) S

Product code: AJ00010

DN: **1.57-1.26 in.**; **Sb-S connection**; Material: **PVC**; Color: **White**; Temperature: ~ **122 F°**; All connections can be glued

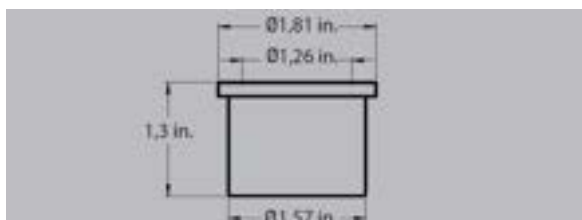

Factory price: **\$1.58**

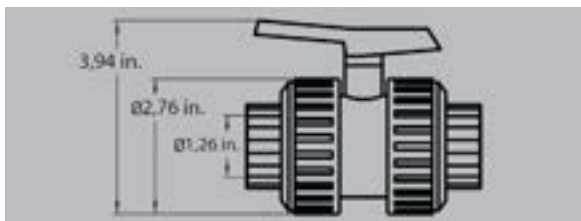

BALL VALVE 32 (1.26 IN.)

Product code: ABE0308

DN: **1.26 in.**; Material: **PVC**; Color: **Black**; Temperature: ~ **122 F°**; S-S
All connections can be glued

Factory price: **\$20.99**

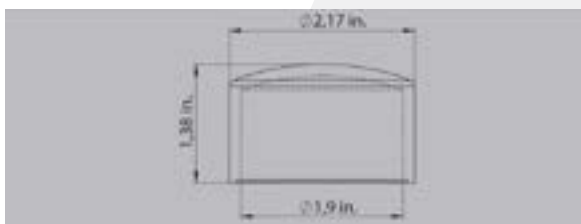

PLUG 48 (1.89 IN.)

Product code: ABE0369

DN: **1.89 in.**; Material: **PVC**; Color: **White**; Temperature: ~ **122 F°**;
Can be glued

Factory price: **\$2.01**

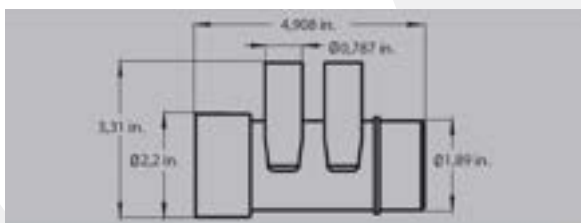

MANIFOLD - 48 (1.89 IN.) S × 20 (0.787 IN.) SPIGOT × (4PCS) V2

Product code: ABE0393

DN: **1.89-0.79 in.**; **SB-S connection**; Material: **PVC**; Color: **White**;
Temperature: ~ **122 F°**; All connections can be glued; 4 DN0.79
branches; Can be expanded

Factory price: **\$2.59**

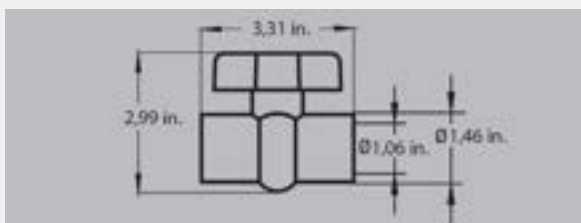

BALL VALVE 20 (0.787 IN.) S - 20 (0.787 IN.) S

Product code: ABE0370

DN: **0.79 in.**; Material: **PVC**; Color: **White + Red**; Temperature:
~ **122 F°**; S-S All connections can be glued

Factory price: **\$3.59**



GATE VALVE - 48 (1.89 IN.) S × 48 (1.89 IN.) S

Product code: ABE0285

DN: **1.89 in.**; Material: **PVC**; Color: **White**; Temperature: ~ **122 F°**; S-S
All connections can be glued; 2 positions (Open / Closed)

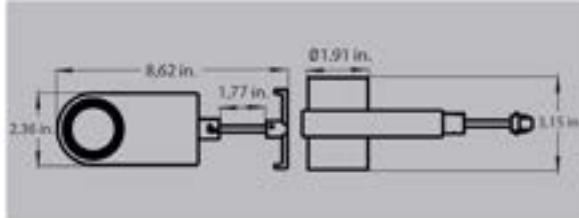

Factory price: **\$10.64**



PLUG 20 (0.787 IN.) SPIGOT

Product code: AK00237

DN: **0.79 in.**; Material: **PVC**; Color: **White**; Temperature: ~ **122 F°**;
Can be glued

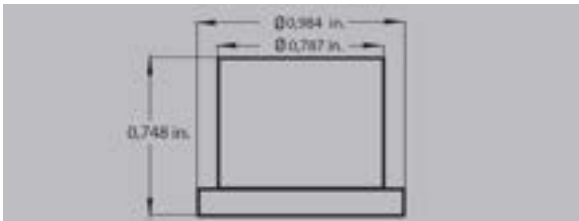

Factory price: **\$0.46**



WATER DRAIN 20 (0.787 IN.) RB

Product code: AKU1826

DN: **0.79 in. threaded connection**; Material: **PVC**; Color: **black**;
Temperature: ~ **122 F°**; Weight: **0.22 lb**

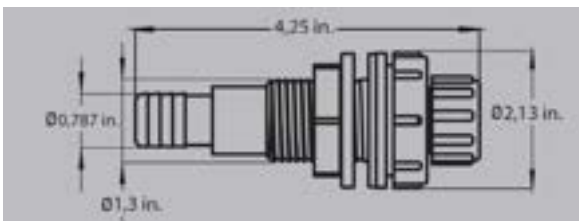

Factory price: **\$12.79**



COUPLING 60 (2.36 IN.)

Product code: ABE0280

DN: **1.26 in.**; **S-S connection**; Material: **PVC**; Color: **White**;
Temperature: ~ **122 F°**; Can be glued

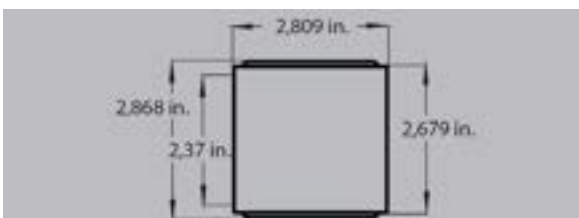

Factory price: **\$1.87**

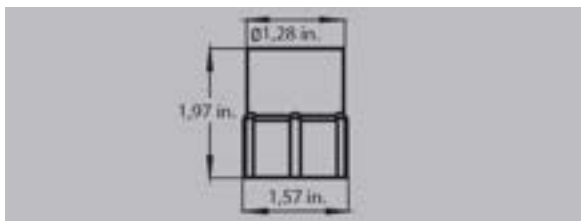

COUPLING 32 (1.26 IN.) (INTERIOR THREAD)

Product code: ABE0336

DN: 1.26 in.; Material: **PVC**; Color: **Black**; Temperature: ~ 122 F°;
Glueable internal threaded extension connection

Factory price: **\$1.37**

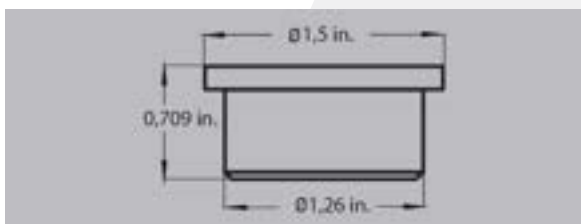

PLUG 32 (1.26 IN.) SPIGOT

Product code: AK00236

DN: 1.26 in.; Material: **PVC**; Color: **White**; Temperature: ~ 122 F°; Can be glued

Factory price: **\$0.43**

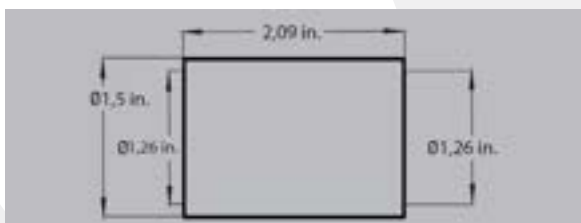

COUPLING 32 (1.26 IN.)

Product code: ABE0332

DN: 1.26 in.; **S-S connection**; Material: **PVC**; Color: **White**;
Temperature: ~ 122 F°; Can be glued

Factory price: **\$1.37**

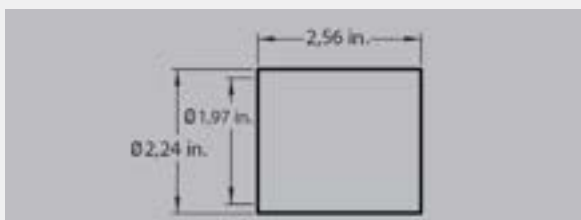

COUPLING 50 (1.97 IN.)

Product code: ABE0335

DN: 1.97 in.; **S-S connection**; Material: **PVC**; Color: **White**;
Temperature: ~ 122 F°; Can be glued

Factory price: **\$4.60**



PLUG 33 (1.3 IN.)

Product code: ABE0354

DN: **0.827 in.**; Material: **PVC**; Color: **White**; Temperature: ~ **122 F°**; Can be glued

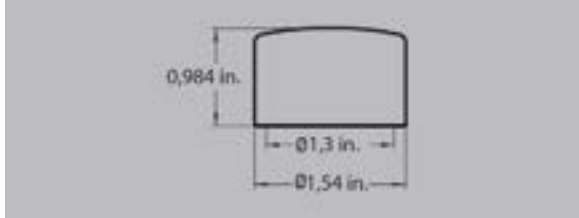

Factory price: **\$1.06**



ELBOW 10 (0.394 IN.) QUICK CONNECTION

Product code: ABE0365

DN: **0.394 in.**; Material: **PVC**; Color: **black&Blue**; Temperature: ~ **122 F°**; quick-connect system

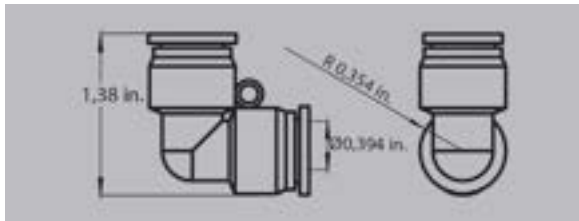

Factory price: **\$1.06**



PIPE CONNECTOR 33 (1.3 IN.)

Product code: ABE0309

DN: **1.3-0.79 in.**; **SB-S connection**; Material: **PVC**; Color: **White**; Temperature: ~ **122 F°**; All connections can be glued

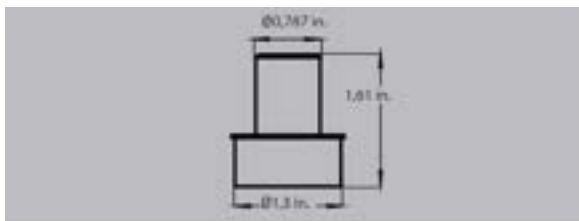

Factory price: **\$1.06**



CHECK VALVE 50 (1.97 IN.) - 38 (1.5 IN.) DN40 (1.57 IN.)

Product code: ABE0175

DN: **1.57 in.**; Material: **PVC**; Color: **White**; S-S Union connection , pipe connection with glue; Max pressure: **232 psi**

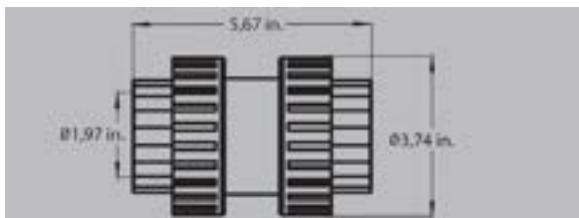

Factory price: **\$51.03**



TE PVC 50/50/50 (1.97/1.97/1.97 IN.)

Product code: ABE0268

DN: **0.97 in.**; Material: **PVC**; Color: **White**; Temperature: ~ **122 F°**;
S-S-S; All connections can be glued

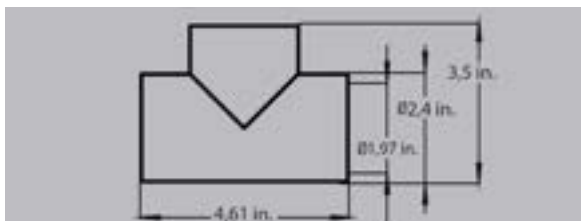

Factory price: **\$22.71**



UNION FOR HEAT PUMP

Product code: ABE0400

DN: **1.97-1.65 in.**; **threaded**; Material: **PVC**; Color: **Gray**; can be glued
+ Internal external threaded connection

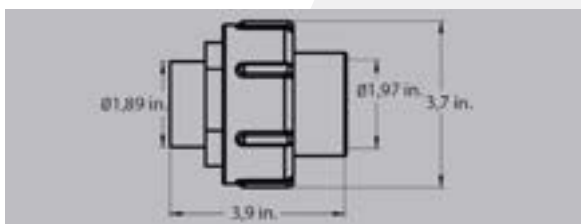

Factory price: **\$18.26**



MANIFOLD 48 (1.89 IN.) S -20 (0.787 IN.) SPIGOT × 10 (0.394 IN.) SB V2

Product code: ABE0394

DN: **1.89-0.79 in.**; **SB-S connection**; Material: **PVC**; Color: **White**;
Temperature: ~ **122 F°**; All connections can be glued; 10 DN0.79
branches; Can be expanded

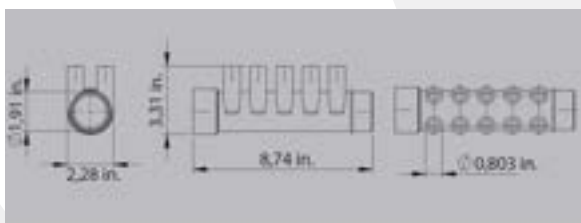

Factory price: **\$5.75**



ELBOW 33MM (1.3 IN.) 90° S-S

Product code: ABE0312

DN: **1.3 in.**; **S-S connection**; Material: **PVC**; Color: **White**;
Temperature: ~ **122 F°**; All connections can be glued

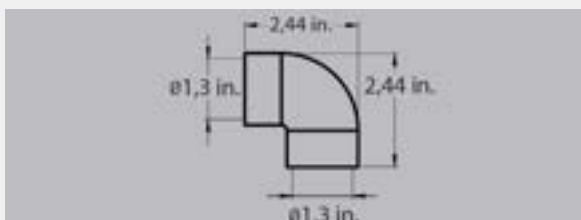

Factory price: **\$2.44**



DISTRIBUTOR FOR OZON - 60.3 SPIGOT × 60.3 SPIGOT × (2 PCS) 20 SB (2.37X2.37X0.787 IN.)

Product code: ABE0386

DN: 2.36-0.79 in.; Sb-Sb-Sb; Material: PVC; Color: White;
Temperature: ~ 122 F°;

Factory price: **\$5.75**

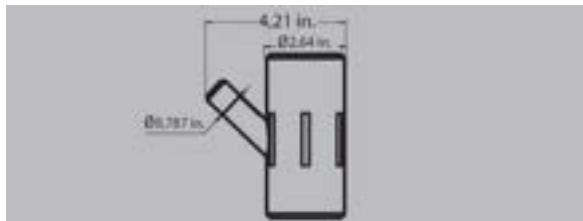

DISTRIBUTOR 10 (0.394 IN.) T FAST CONNECTOR

Product code: ABE0366

DN: 0.39 in.; Material: PVC; Color: Black, blue;
Temperature: ~ 122 F°; Quick connection system

Factory price: **\$2.16**

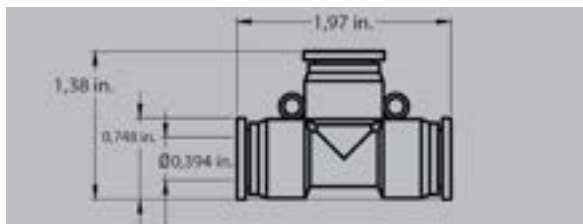

PLUG 21 (0.827 IN.)

Product code: ABE0347

DN: 0.83 in.; Conical design; Material: PVC; Color: White;
Temperature: ~ 122 F°; Can be glued

Factory price: **\$0.58**

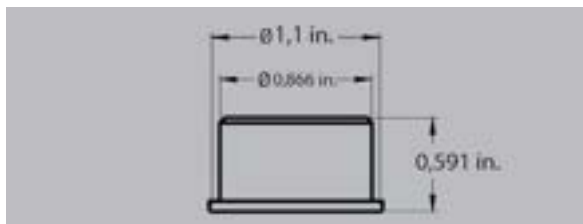

COUPLING - 33 (1.3 IN.) THREAD

Product code: ABE0357

DN: 1.30 in.; S-S connection; Material: PVC; Color: White;
Temperature: ~ 122 F°; Can be glued;

Factory price: **\$1.08**

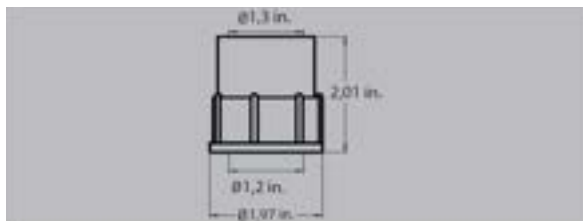



CUPLING 48 (1.89 IN.)

Product code: ABE0334

DN: **0.89 in.**; **S-S connection**; Material: **PVC**; Color: **White**;
Temperature: ~ **122 F°**; Can be glued;

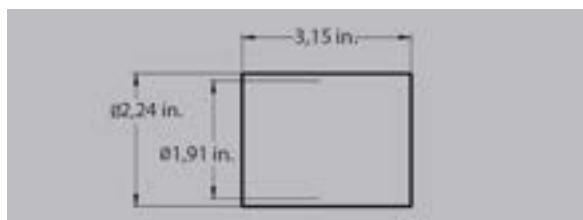

Factory price: **\$1.37**



TEE 21 (0.827 IN.) T S-SB-S

Product code: ABE0351

DN: **0.83 in.**; Material: **PVC**; Color: **White**; Temperature: ~ **122 F°**;
S-SB-S All; connections can be glued

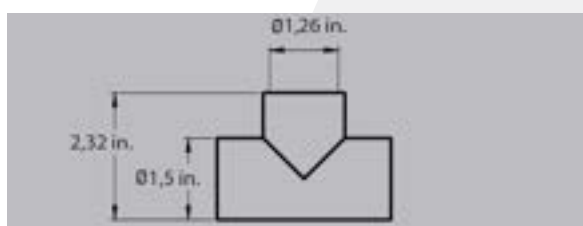

Factory price: **\$1.08**



TEE 48-33 (1.89-1.3 IN.) T S-SB-S

Product code: ABE0348

DN: **1.89-1.3 in.**; Material: **PVC**; Color: **White**; Temperature: ~ **122 F°**;
S-SB-S All; connections can be glued

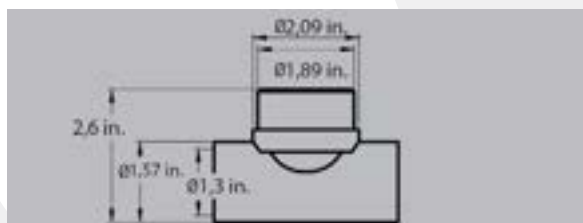

Factory price: **\$1.87**



CUPLING 33 (1.3 IN.)

Product code: ABE0333

DN: **1.3 in.**; **S-S connection**; Material: **PVC**; Color: **White**;
Temperature: ~ **122 F°**; Can be glued

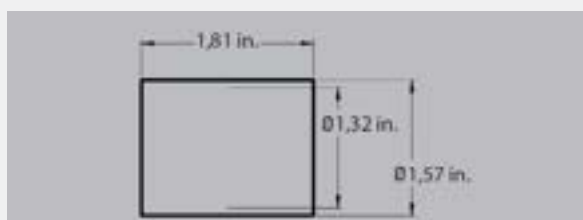

Factory price: **\$0.72**



ELBOW 48 (1.89 IN.) S-S

Product code: ABE0345

DN: **1.89 in.**; **S-S connection**; Material: **PVC**; Color: **White**;
Temperature: ~ **122 F°**; All connections can be glued

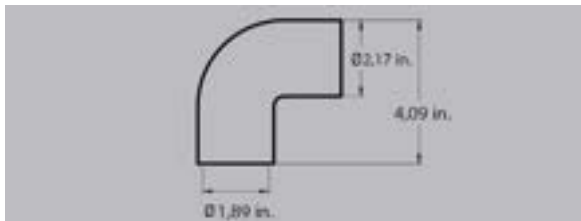

Factory price: **\$2.30**

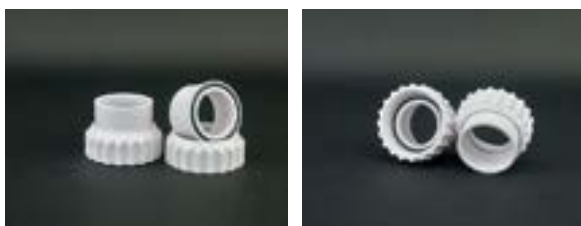

UNION 48 (1.89 IN.) PVC

Product code: ABE0343

DN: **0.39 in.**; Material: **PVC**; Color: **Black**; Temperature: ~ **122 F°**;
Quick connection system

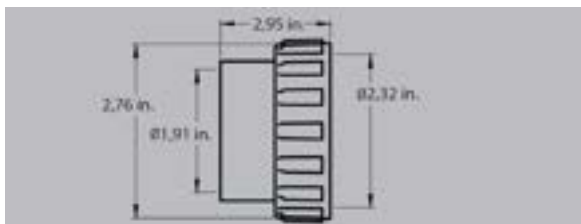

Factory price: **\$3.59**



WYE - 32 S × 32 S × 32 S (1.26X1.26X1.26 IN.)

Product code: ABE0045

DN: **1.26 in.**; Material: **PVC**; Color: **White**; Temperature: ~ **122 F°**;
All connections can be glued or clamped

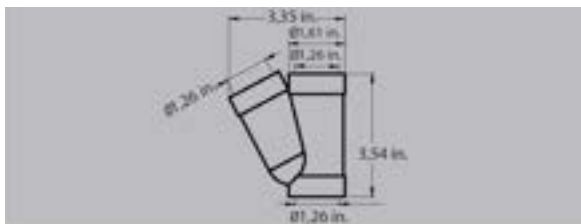

Factory price: **\$2.73**



TEE - 32 S × 50 SPIGOT × 32 S (1.26X1.97X1.26 IN.)

Product code: ABE0174

DN: **1.97-1.26 in.**; Material: **PVC**; Color: **White**; Temperature:
~ **122 F°**; S-SB-S All connections can be glued



Factory price: **\$5.75**

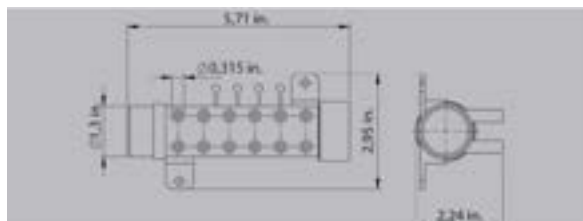

MANIFOLD - 33 S × 33 SPIGOT × (8 PCS) 12 SB (1.3X1.3X0.472 IN.)

Product code: ABE0353

Material: **PVC**; Size: **5.71x2.24x2.95 in.**; Weight: **0.179 lb**

Factory price: **\$3.16**



CHECK VALVE 48 (1.89 IN.) V2

Product code: ABE0397

DN: **1.89 in.**; Material: **PVC**; Colour: **Blue-transparent**; can be glued; Sb-Sb; Max pressure: **188.5 psi**

Factory price: **\$17.25**

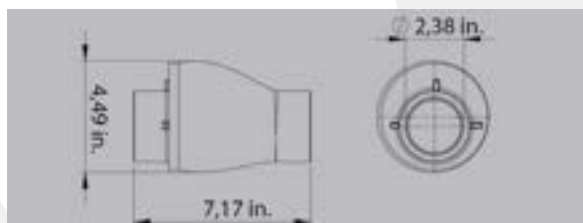

CHECK VALVE 60 (2.36 IN.) V2

Product code: ABE0398

DN: **2.36 in.**; Material: **PVC**; Color: **White**; can be glued; Sb-Sb; Max pressure: **188.5 psi**

Factory price: **\$21.99**

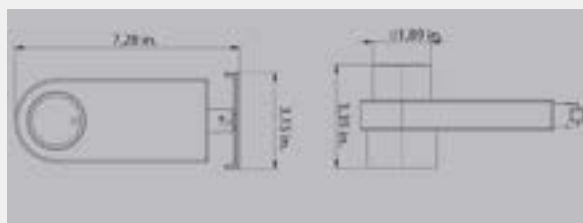

GATE VALVE - 60 (2.36 IN.) S × 60 (2.36 IN.) S

Product code: ABE0401

DN: **2.36 in.**; Material: **PVC**; Color: **White**; Temperature: ~ **122 F°**; S-SB All connections can be glued; 2 positions (Open / Closed)

Factory price: **\$11.50**

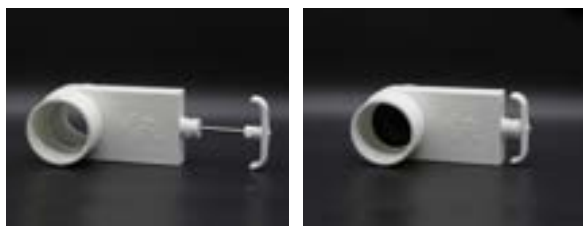

GATE VALVE - 73 (2.87 IN.)

Product code: ABE0402

DN: **2.87 in.**; Material: **PVC**; Color: **White**; Temperature: ~ **122 F°**;
S-SB All connections can be glued; 2 positions (Open / Closed)

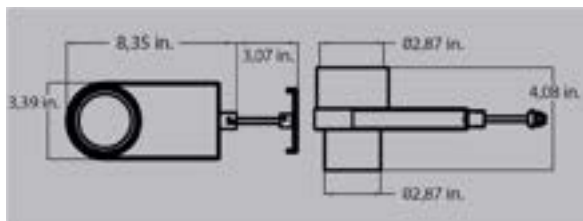

Factory price: **\$19.41**



GATE VALVE - 48 (1.89 IN.)

Product code: ABE0403

DN: **1.89 in.**; Material: **PVC**; Color: **White**; Temperature: ~ **122 F°**;
S-SB All connections can be glued; 2 positions (Open / Closed)

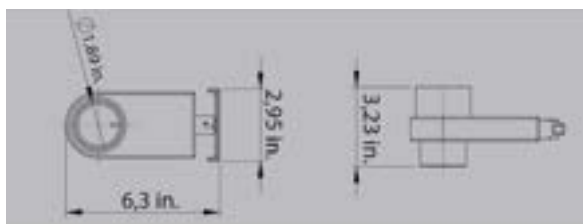

Factory price: **\$10.93**

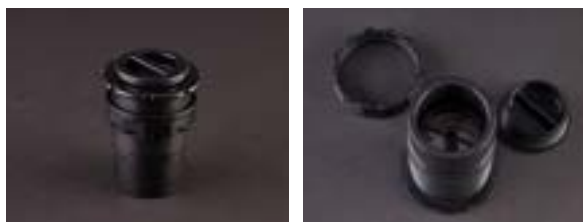

WATER DRAIN - 48 (1.89 IN.) RB

Product code: AKU1990

DN: **1.89 in.**; **threaded connection**; Material: **PVC**; Color: **Black**;
Temperature: ~ **122 F°**;

Wellisparts®

Factory price: **\$8.77**

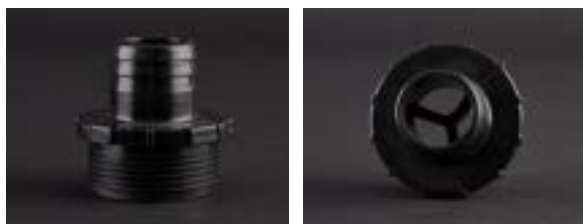

DRAINPIPE 48 (1.89 IN.) ADAPTER FOR 1.25 "HOSE

Product code: AKU1991

DN: **1.89 in.**; **threaded - 1.25" connection can be glued**; Material: **PVC**; Color: **Black**; Temperature: ~ **122 F°**;

Wellisparts®

Factory price: **\$8.77**



WATER DRAIN PLUG RB20 (0.787 IN.)

Product code: ABE0422

DN: 1.02 in.; threaded - 3/4" connection; Material: PVC+Silicone seal; Color: black; Temperature: ~ 122 F°;

Wellisparts®

Factory price: **\$1.37**



PLUG 60 (2.36 IN.)

Product code: ABE0391

DN: 2.36 in.; Material: PVC; Color: White; Temperature: ~ 122 F°; Can be glued

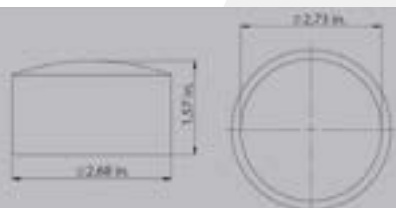

Factory price: **\$1.73**



FAST CONNECTOR SOCKET

Product code: ABE0065

DN: 0.39 in.; Material: PVC; Color: Black, Blue; Temperature: ~ 122 F°; Quick connection system

Wellisparts®

Factory price: **\$1.37**



TEE QUICK CONNECTION 10 (0.394 IN.)

Product code: ABE0364

DN: 0.39 in.; Material: PVC; Color: Black, Blue; Temperature: ~ 122 F°; Quick connection system

Wellisparts®

Factory price: **\$1.22**



CHECK VALVE FOR AROMATHERAPY

Product code: ABE0390

DN: 0.28 in.; Material: PVC; Color: White; Can be glued; Sb-Sb

Wellisparts®

Factory price: **\$3.88**



PROFILE 60 (2.36 IN.) DOUBLE-SIDED WALL FILTER DISTRIBUTOR

Product code: ABE0395

DN: 2.36-2.36-2.36 in.; Sb-Sb-Sb connection; Material: PVC; Color: White; Temperature: ~ 122 F°; All connections can be glued; 2 x DN2.36 branches

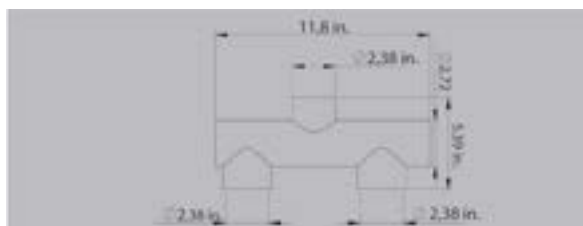

Factory price: **\$11.93**



PROFILE 48-20 (1.89-0.787 IN.) DISTRIBUTOR FOR CIRCULATOR 4, WITH END

Product code: ABE0412

DN: 1.89-0.79 in.; SB-S connection; Material: PVC; Color: White; Temperature: ~ 122 F°; All connections can be glued; 4 DN0.79 branches| Closed end

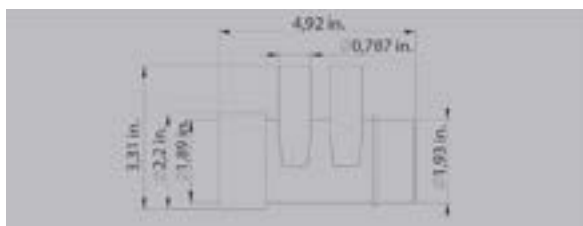

Factory price: **\$2.73**



TEE 20-10-20 (0.787-0.394-0.787 IN.) V2

Product code: ABE0426

DN: 0.79-0.39-0.79 in.; SB-SB-SB connection; Material: PVC; Color: White; Temperature: ~ 122 F°; All connections can be glued

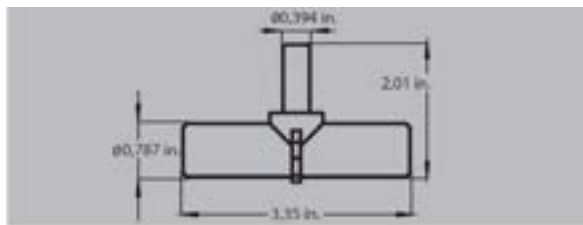

Factory price: **\$1.22**



PIPE CLAMP - 73 (2.87 IN.)

Product code: ASE0187

Range: **2.2-2.48 in.**; Material: **stainless steel**; Color: **silver+black**;
-40 - 100 C°; Connecting nut: **welded, M8 / M10, SW 13**

Wellisparts®

Factory price: **\$11.50**



PIPE CLAMP - 63 (2.48 IN.)

Product code: ASE0186

Range: **2.68-2.87 in.**; Material: **stainless steel**; Color: **silver+black**;
-40 - 212 F°; Connecting nut: **welded, M8 / M10, SW 13**

Wellisparts®

Factory price: **\$5.32**



CHECK VALVE FOR OZONE (BALBOA)

Product code: ABE0526

DN: **0.28 in.**; Material: **PVC**; Color: **Black**; can be glued; Sb-Sb; Related product: **ABE0359, ACM0947**

Wellisparts®

Factory price: **\$7.62**



MULTIPLE MANIFOLD - 20 SPIGOT × 20 SPIGOT × (2 PCS) 10 SB (0.787X0.787X0.394 IN.)

Product code: ABE0289

DN: **0.79-0.39 in.**; **SB-S connection**; Material: **PVC**; Color: **White**;
Temperature: ~ 122 F°; All connections can be glued; 2 DN0.39 branches

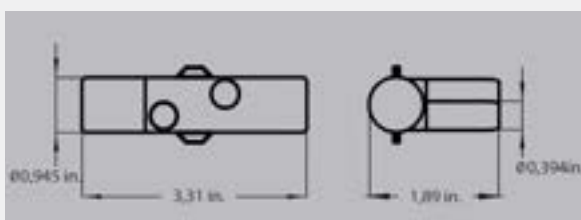

Factory price: **\$0.93**



ELBOW 48 (1.89 IN.) S-S

Product code: ABE0404

DN: **1.89 in.**; **S-S connection**; Material: **PVC**; Color: **White**;
Temperature: ~ **122 F°**; All connections can be glued

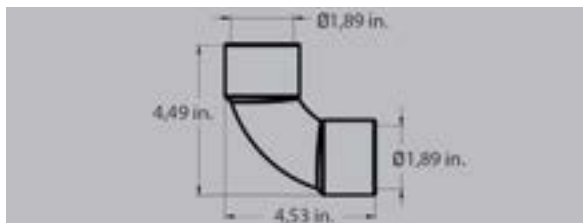

Factory price: **\$1.73**



ELBOW 48 (1.89 IN.) SB-S

Product code: ABE0405

DN: **1.89 in.**; **Sb-S connection**; Material: **PVC**; Color: **White**;
Temperature: ~ **122 F°**; All connections can be glued

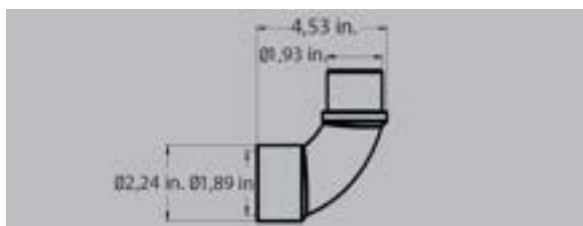

Factory price: **\$2.16**



PROFILE 2.5 "ELBOW SB-S V2

Product code: ABE0522

DN: **2, 5" Sb-S connection**; Material: **PVC**; Weight: **0.772 lb**;
Size: **6.7x3.4x6.7 in.**; Color: **White**; Temperature: ~ **122 F°**;
All connections can be glued



Factory price: **\$7.19**



PROFILE 2.5 "ELBOW S-S V2

Product code: ABE0521

DN: **2,5" S-S connection**; Material: **PVC**; Weight: **0.772 lb**;
Size: **6.7x3.4x6.7 in.**; Color: **White**; Temperature: ~ **122 F°**;
All connections can be glued



Factory price: **\$7.19**



SADDLE 50 PVC 1/2"

Product code: EE00214

Material: **PVC + stainless steel bolts**; Weight: **0.284 lb**;
Size: **2.4x3.5x2.4 in.**; Temperature: ~ **122 F°**;

Wellisparts®

Factory price: **\$6.33**



REDUCER FOR SADDLE 1/2"-1/4"

Product code: ABE0419

Material: **PVC**; Weight: **0.018 lb**; Size: **1.1x1.1x0.9 in.**; Temperature: ~ **122 F°**; Related Product: **EE00214**

Wellisparts®

Factory price: **\$2.30**



AWAB CLAMP 8-16 / 9

Product code: SZE0206

Range: **0.315-0.63 in.**; Material: **stainless steel**; Color: **silver**;
Temperaturre: **-40 - 212 F°**; Weight: **0.42 oz**; Width: **0.35 in.**

Wellisparts®

Factory price: **\$0.65**



PLUG 14

Product code: ABE0311

DN: **0.55 in.**; Material: **PVC**; Color: **White**; Temperature: ~ **122 F°**;
Can be glued; Size: **0.75x0.62x0.62 in.**

Wellisparts®

Factory price: **\$1.15**



PLUG 7 (0.276 IN.)LVJ

Product code: ABE0371

DN: **2.76 in.**; Material: **PVC**; Color: **White**; Temperature: ~ **122 F°**; Can be glued

Wellisparts®

Factory price: **\$1.15**



ELBOW 45° - 48 (1.89 IN.) MM

Product code: ABE0406

DN: **1.89 in.**; Material: **PVC**; Weight: **0.159 lb**;
Size: **4.17x2.36x1.89 in.**; a: **1.89 in.**; b: **1.89 in.**; c: **1.3 in.**;

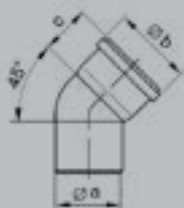

Factory price: **\$2.73**



BALL VALVE PVC 50 (1.97 IN.)

Product code: ABE0269

DN: **1.97 in.**; Weight: **0.207 lb**; Material: **PVC**; Temperature: ~ **131 F°**;
packing dims: **6.5x5.51x3.94 in.**

Wellisparts®

Factory price: **\$43.13**



HEAT PUMP CONNECTING PART SET D50

Product code: ABE0671

This set contains the necessary parts to connect the heat pump to the pool

Wellisparts®

Factory price: **\$136.56**



Wellisparts®

HEAT PUMP CONNECTING PART SET 32 (1.26 IN.)

Product code: ABE0670

This set contains the necessary parts to connect the heat pump to the pool

Factory price: **\$117.59**



Wellisparts®

BALL VALVE 48 (1.89 IN.) B-B

Product code: ABE0506

Weight: **0.207 lb**; Material: **PVC**; Temperature: ~ **131 F°**; Packing dimension: **6.5x5.5x3.9 in.**

Factory price: **\$34.36**



Wellisparts®

IDOM 33-20 (1.3-0.787 IN.) DEALER 3

Product code: ABE0425

DN: **1.3-0.79 in.**; Material: **PVC**; Weight: **0.119 lb**; Size: **1.34x0.35x1.34 in.**, 3x DN: **0.79 in. branching off**

Factory price: **\$2.06**



Wellisparts®

PIPE CLAMP 45 (1.77 IN.) FGRS 45-50 (1.77-1.97 IN.)

Product code: ASE0188

Range: **1.57-1.97 in.**; Material: **stainless steel +rubber**; Color: **silver+black**; **-40 - 212 F°**

Factory price: **\$1.44**



CLAMP OETIKER FOR Ø 9.60 MM-11.30 MM (0.378-0.445 IN.) OZONE

Product code: ASE0227

Range: **0.38-0.45 in.**; Material: **stainless steel**; Color: **silver**;
Temperature: **-40 - 212 F°** Weight: **0.42 oz**; Width: **0.2 in.**

Wellisparts®

Factory price: **\$0.36**



CLAMP OETIKER FOR Ø 23.90 MM-27.10 MM (0.941-1.07 IN.)

Product code: ASE0228

Range: **0.94-1.07 in.**; Material: **stainless steel**; Color: **silver**;
Temperature: **-40 - 212 F°**

Wellisparts®

Factory price: **\$1.29**



48-32 (1.89-1.26 IN.) TEE

Product code: ABE0540

DN: **1.89-1.26 in.**; Material: **PVC**; Color: **White**; Temperature:
~ **122 F°**; SB-S-SB All connections can be glued



Factory price: **\$1.73**

Suction

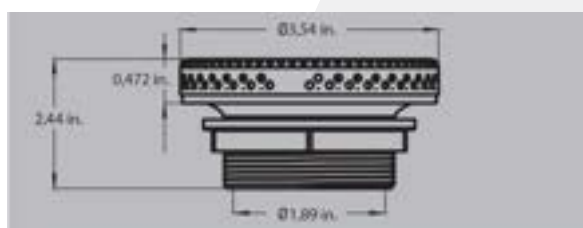

SUCTION - 48 (1.89 IN.) S

Product code: AKU1720

Weight: **0.291 lb**; Material: **PVC, Stainless steel**; Temperature: **~ 122 F°**;

Factory price: **\$16.39**

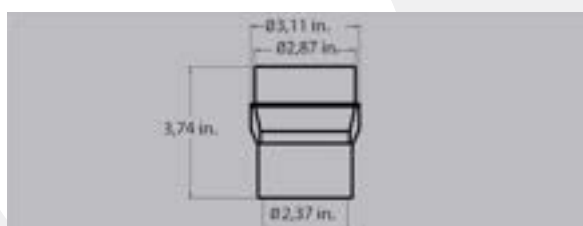

REDUCER FOR SUCTION - 60.3 (2.37 IN.) S

Product code: ABE0291

DN: **2.36-1.89 in.**; S-S connection; Material: **PVC**; Color: **White**; Temperature: **~ 122 F°**; All connections can be glued

Factory price: **\$3.02**

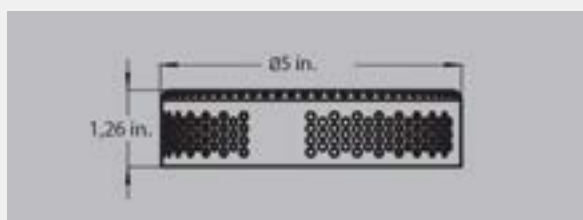

SUCTION 2.5" CHROME (THICK)

Product code: AE00507

Weight: **0.223 lb**; Material: **Stainless steel**; Temperature: **~ 122 F°**;

Factory price: **\$11.36**



SUCTION 2" CHROME THICK V2

Product code: ABE0505

Weight: **0.725 lb**; Material: **PVC, Stainless steel**; Temperature: ~ **122 F°**; Related Products: **AJ00243, AJ00244, ABE0413**

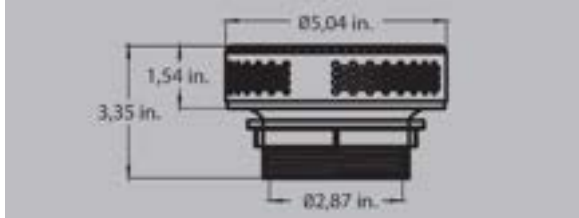

Factory price: **\$15.81**



SELF ADJUSTING NUT FOR SUCTION HEAD

Product code: AJ00243

Weight: **0.157 lb**; Material: **PVC**; Size: **4.69x0.906x4.69 in.**; Related Product: **ABE0505; AJ00244, ABE0421**



Factory price: **\$2.44**



SEALING FOR SELF ADJUSTING SUCTION HEAD NUT

Product code: AJ00244

Weight: **0.062 lb**; Material: **PVC**; Size: **4.92x0.47x4.92 in.**; Related Products: **ABE0505, AJ00243**



Factory price: **\$2.30**



SELF-ADJUSTING COMPENSATION RING FOR SUCTION 2"

Product code: AE00594

Weight: **0.055 lb**; Material: **PVC**; Size: **5.12x0.39x5.12 in.**



Factory price: **\$3.16**



SUCTION HEAD 2.5" CHROME (HIGH)

Product code: *ABE0421*

Weight: **0.46 lb**; Material: **Chrome + PVC**; Size: **5x3.15x5 in.**; Related Products: **AJ00243, AJ00244, ABE0413**

Wellisparts®

Factory price: **\$6.18**

Circulation pumps



COUNTERCURRENT PUMP 2200 W 60 HZ

Product code: ACM0955

RU certified, 56WUA300a-II 60 hz, 2 speed 220-240V, Qmax: 253.6/116.2 gal/min, Hmax: 52.5/13.41 ft, 10/3.5 A, 3450/1725 rpm, Maximum water temp 122 F°



Wellisparts®

Factory price: **\$359.30**

CIRCULATION PUMP WTC50M 250 W 60 HZ

Product code: ACM0902

220 V/60 Hz, 250 W VDE approval 4.92 ft cable with AMP connector, with unions, without air switch, UL certification, Qmax: 61.64 gal/min, Hmax: 12.48 ft, 0.25 kW, SF 1.0, 1700 rpm, IP55, Class155(F)

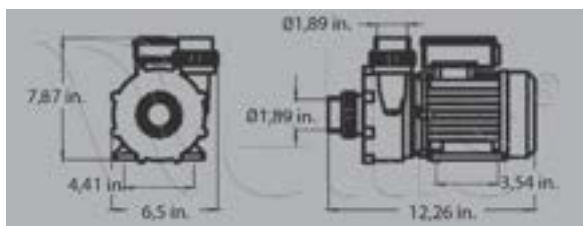

Factory price: **\$98.60**

CIRCULATION PUMP 1100 W (WBE150) 60 HZ

Product code: ACM0951

RU Certification, Hmax 45.9 ft, Qmax 163.8 gal/min, 220-240 V, 60 Hz, 3450 rpm, Maximum water temp: 122 F°, d., Power: 1100 W



Wellisparts®

Factory price: **\$144.60**

Spa pumps



SPA PUMP 2,4 HP - ONE SPEED 60 HZ

Product code: ACM0732



Performance curves

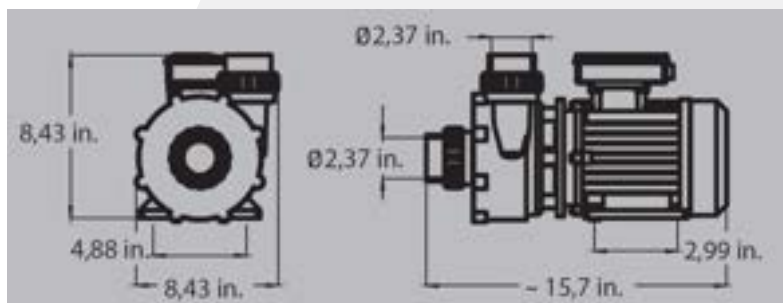
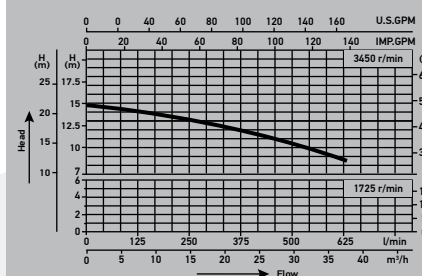

Voltage: **230 V**; Current: **8 A**; Performance: **1800 W**,
2.4 HP; Frequency: **60 Hz**; Flow: **167.7 gal/min**,
 Head: **47.6 ft**; Waterproof: **IPx5**;

Factory price: **\$228.56**

SPA PUMP 3 HP - ONE SPEED 60 HZ

Product code: ACM0734



Performance curves

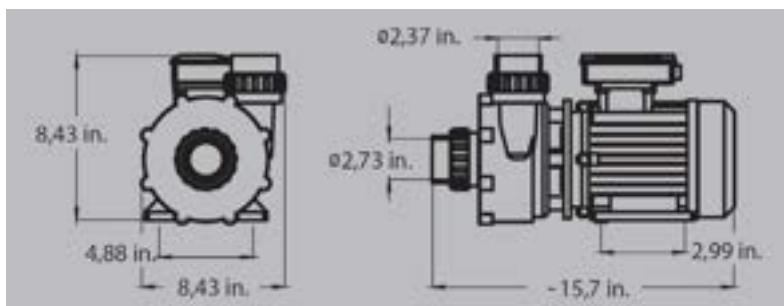
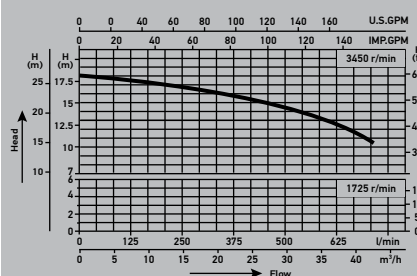

Voltage: **230 V**; Current: **10 A**; Performance: **2200 W, 3 HP**; Frequency: **60 Hz**; Flow: **187.6 gal/min**; Head: **59.1 ft**; Waterproof: **IPx5**

Factory price: **\$258.75**



SPA PUMP 3 HP - TWO SPEED 60 HZ

Product code: ACM0735

Voltage: **230 V**, Current: **10/3.5 A**, Performance: **2200/805 W, 3/1 HP**, Frequency: **60 Hz**, Flow: **187.6/88.1 gal/min**, Head: **59.1/16.4 ft**

Factory price: **\$310.50**

SPA PUMP 2.4 /0.9 HP- TWO SPEED 60 HZ

Product code: ACM0733



Performance curves

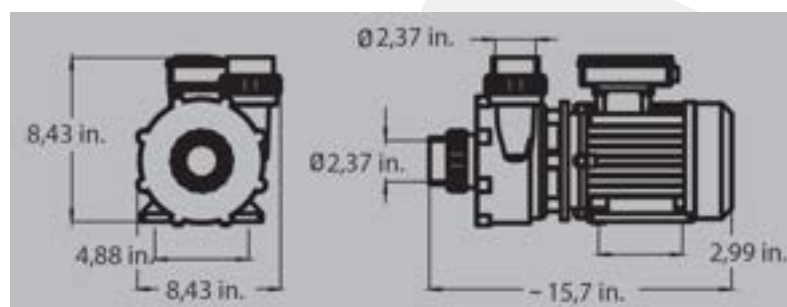
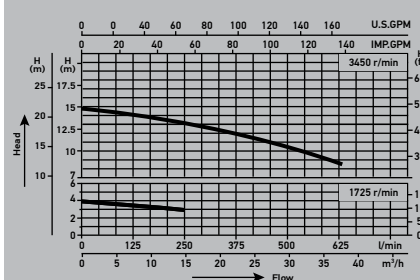

Voltage: **230 V**; Current: **8/3 A**; Performance: **1800/690 W, 2.4/0.9 HP**; Frequency: **60 Hz**; Flow: **167.3/66 gal/min, 635/250 l/min**; Head: **47.57/13.1 ft**;

Factory price: **\$271.69**



UNION

Temperature: ~ 122 F°

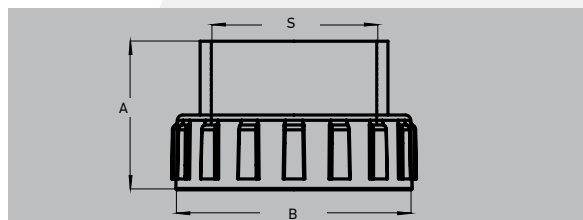

Product code	Diameter (S) in.	A in.	B in.	Weight (lb)	Factory price Dollar (\$)
ABE0023	1.97	2.09	2.95	0.159	3.31
ABE0106	2.37	2.28	3.62	0.273	4.89
ABE0253	2.87	2.32	4.09	0.331	17.11



UNION 33 (1.3 IN.) FOR PUMP

Product code: ABE0352

Weight: **0.13 lb**; Material: **PVC**; Temperature: ~ 122 F°

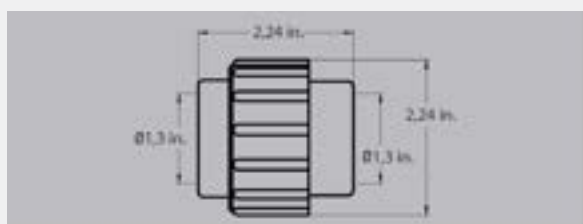

Factory price: **\$6.47**



RUBBER SUPPORT M8×15/ M8×30 (M8X0.591 IN./M8X1.18 IN.)

Product code: ASE0126

Weight: **0.075 lb**; Material: **Rubber/Iron** Relevant product: **ACM0734, ACM0735, ACM0733, ACM0945**

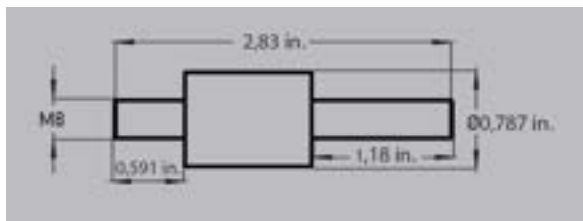

Factory price: **\$1.58**



SEALING FOR HYDROMASSAGE PUMP

Product code: ABE0399

Material: **Rubber/Iron** Related product: **ACM0733, ACM0734, ACM0735**

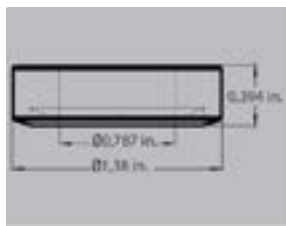

Factory price: **\$14.66**



SPA PUMP 1100W 60HZ (48WUA1001C-II)

Product code: ACM0945

RU certificated, 48WU1001C-II, 2 speed pump; High speed: Hmax: 45.9 ft, Qmax: 121.5 gal/min, 115V, 60 Hz, 10.3A, 0.75 kW/1Hp, 3450 rpm; Low speed: Hmax: 9.8 ft, Qmax 52.8 gal/min, 115V 60 Hz, 3.8A, 0.08 kW/0.12HP, 1725 rpm, max water temp: 122 F°

Wellisparts®

Factory price: **\$198.16**



MOTOR CABLE Y (PARALLEL PLAIN 6 CORE)

Product code: ACM0995

Weight: **0.076 oz**; Size: **3.94x1.42x0.32 in.**; Cable cross section: **0.00205 in.² (1.32 mm²); 1 male side 2 female side connection**

Wellisparts®

Factory price: **\$6.04**



HOSE CONNECTION FOR VENT 10 FOR PUMP WITH THREAD

Product code: *ABE0267*

Material: **Steel**; Weight: **0.039 lb**; Size: **0.55x0.55x1.38 in.**

Wellisparts®

Factory price: **\$1.87**



COUNTERCURRENT HOUSING

Product code: *ABE0413*

Material: **Stainless Steel**; Weight: **44.1 lb**; Size: **28.7x16.9x15.4 in.**

Related Product: **ABE0421, AJ00243, ABE0505**

Wellisparts®

Factory price: **\$3152.44**

Gecko

Control Box / Heater / Control Panel



CONTROL PANEL - AUX ONE BUTTON

Product code: ACM0763

IN.K110; Weight: **0.381 lb**; Temperature: ~ **122 F°**; Buttons: **1**;
Length: **19.7 in.**; Volts: **12v**; 1 button: **control pump from each seat**;
Related product: **ACM0771, ACM0785, ACM0776, ACM0776, ACM0754, ACM0952**

Factory price: **\$30.49**

CONTROL PANEL - AUX FOUR BUTTON

Product code: ACM0762

IN.K120; Weight: **0.772 lb**; Temperature: ~ **122 F°**; Buttons: **4**;
Length: **19.7 in.**; Button Configuration: **Pump 1/Pump 2/Pump 3/ Light**; Related product: **ACM0776, ACM0956, ACM0770, ACM0754, ACM0952**

Factory price: **\$69.00**

LIGHT CABLE WITH CONNECTORS

Product code: ACM0775

Weight: **0.066 lb**; Temperature: ~ **122 F°**; Related products:
US: ACM0952, ACM0853, ACM0956, ACM0854 EU: ACM0754, ACM0776, ACM0755, ACM0756, ACM0802

Factory price: **\$5.50**

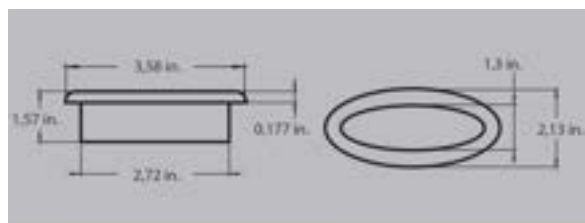
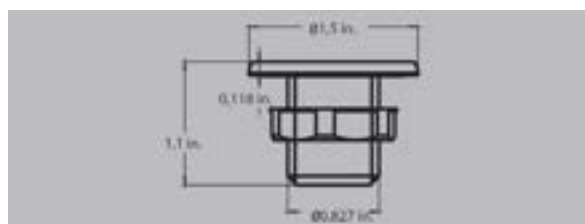

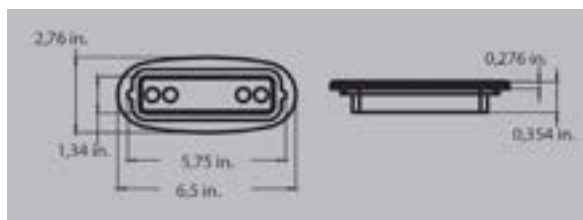

CONTROL PANEL IN.K300 - ONE PUMP

Product code: *ACM0759*

Weight: **0.677 lb**; Size: **7.2x2.99x2.36 in.**; Temperature: ~ **122 F°**;
Buttons: **4**; Related control box: **US: ACM0952, ACM0853, ACM0956, ACM0854 EU: ACM0754, ACM0776, ACM0755, ACM0756**

Factory price: **\$68.95**

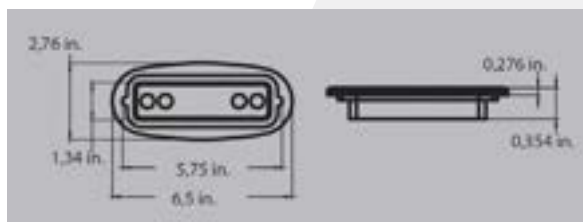

CONTROL PANEL IN.K300 - TWO PUMP

Product code: *ACM0760*

Weight: **0.677 lb**; Size: **7.2x2.99x2.36 in.**; Temperature: ~ **122 F°**;
Buttons: **4**; Related control box: **US: ACM0952, ACM0853, ACM0956, ACM0854 EU: ACM0754, ACM0776, ACM0755, ACM0756**

Factory price: **\$68.95**

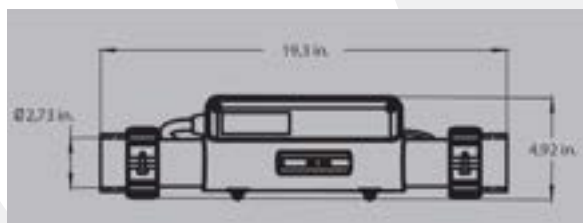

HEATER - 2000 W V2

Product code: *ACM0996*

Weight: **0.677 lb**; Temperature: ~ **122 F°**; Voltage: **230 V**; Current: **8.7 A**; Performance: **2000 W**; Material: **Plastic + Stainless steel**;
Related product: **EU: ACM0754, ACM0755, ACM0756, ACM0776 US: ACM0952, ACM0854, ACM0853, ACM0956 Both: ABE0373**

Factory price: **\$98.95**

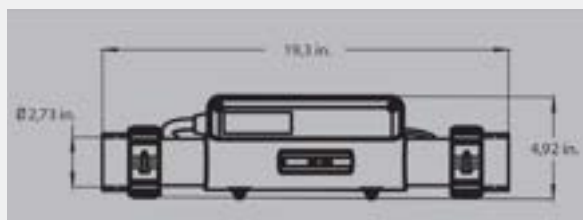

HEATER - 3000 W V2

Product code: *ACM0997*

Weight: **4.678 lb**; Temperature: ~ **122 F°**; Voltage: **230 V**; Current: **13.0 A**; Performance: **3000 W**; Material: **Plastic + Stainless steel**;
Related product: **EU: ACM0754, ACM0755, ACM0756, ACM0776 US: ACM0952, ACM0854, ACM0853, ACM0956 Both: ABE0373**

Factory price: **\$98.95**



CONTROL PANEL - PULSAR / SEQUENCER

Product code: ACM0765

Weight: **0.395 lb**; Temperature: ~ **122 F°**; Buttons: **4**; **Led Display**;
Waterproof: **IP x5**; Related product: **US: ACM0952, ACM0853, ACM0956, ACM0854 EU: ACM0754, ACM0776, ACM0755, ACM0756**

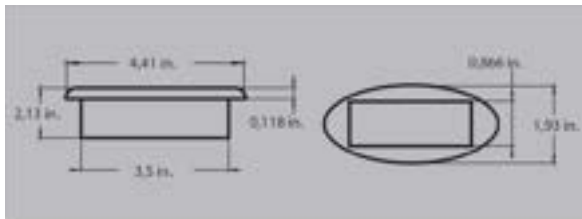

Factory price: **\$93.95**

STICKER CONTROL PANEL- K120

Product code: ACM0770

Weight: **0.002 lb**; Temperature: ~ **122 F°**; Related Product: **ACM0762**



Factory price: **\$9.95**

STICKER CONTROL PANEL- K110 BLUE

Product code: ACM0771

Weight: **0.002 lb**; Temperature: ~ **122 F°**; Related Product: **ACM0763**



Factory price: **\$9.95**

STICKER CONTROL PANEL- ONE PUMP (WELLIS LOGO)

Product code: ACM0773

Weight: **0.009 lb**; Temperature: ~ **122 F°**; Related Product: **ACM0759**



Factory price: **\$12.50**



STICKER CONTROL PANEL- TWO PUMP (WELLIS LOGO)

Product code: ACM0774

Weight: **0.008 lb**; Temperature: ~ **122 F°**; Related product: **ACM0760**

Factory price: **\$12.50**



STICKER CONTROL PANEL- ONE PUMP - WITHOUT LOGO

Product code: ACM0778

Weight: **0.008 lb**; Temperature: ~ **122 F°**; Related product: **ACM0759**

Factory price: **\$9.95**



STICKER - K300 TWO PUMP (WITHOUT LOGO)

Product code: ACM0779

Weight: **0.008 lb**; Temperature: ~ **122 F°**; Related product: **ACM0760**

Factory price: **\$9.95**

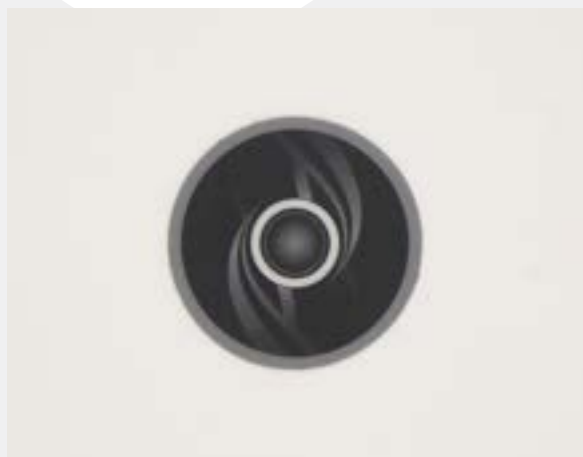

STICKER CONTROL PANEL 1 BUTON BLACK- K110

Product code: ACM0785

Weight: **0.002 lb**; Temperature: ~ **122 F°**; Related Product: **ACM0763**

Factory price: **\$9.95**



INMIX GECKO

Product code: ACM0767

Weight: **0.046 lb**; Temperature: ~ **122F°**; Input: **230 VAC**;
Output: **5 VDC, 1.6 A**; Related product: **EU ACM0776, US: ACM0956**
Both: ACM0912, ACM0814

Factory price: **\$59.95**



LED CABLE FOR IN.MIX

Product code: ACM0814

Weight: **0.022 lb**; Temperature: ~ **122 F°**; Connection: **4PIN**,
Length: **9.84 in.**; Related product: **ACM0767**

Factory price: **\$1.95**



STICKER CONTROL PANEL AUX 4 BUTTONS

Product code: ACM0784

Weight: **0.002 lb**; Temperature: ~ **122 F°**; Related product: **ACM0762**

Factory price: **\$12.50**

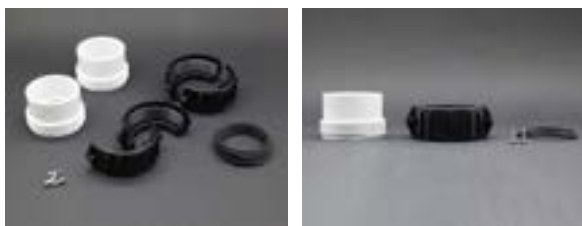

UNION SET FOR 2" GECKO HEATERS

Product code: ABE0373

Weight: **0.776 lb**; Temperature: ~ **122 F°**; Size: **4.33x6.3x3.15 in.**
Related Product: **ACM0996, ACM0997, ACM0926**

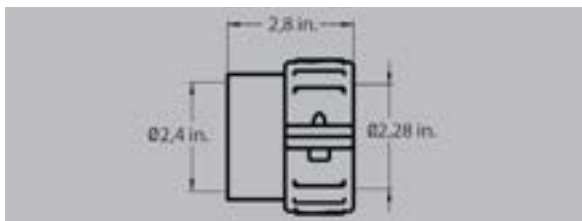

Factory price: **\$10.95**

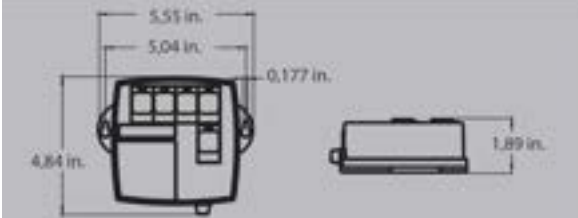

IN.GRID EXTERNAL HEATER CONTROLLER AND 4 WAYS CONNECTOR

Product code: ACM0881

Weight: **0.904 lb**; IPX5; -4 F°-140 F° Connected to the Y series, in.grid gives you the advantages of using alternative heating sources. Connected to the CO port of your spa control system, in.grid will act as a dispatcher of external heating sources such as your heat pump or your central house heating system. Related product **US: ACM0952, ACM0853, ACM0956, ACM0854 EU: ACM0754, ACM0776, ACM0755, ACM0756** with appropriate software revision

Factory price: **\$104.95**



CONTROL PANEL STICKER IN.K300 2 PUMPS (WELLIS LOGO)

Product code: ACM0884

Weight: **0.009 lb**; Temperature: ~ 122 F°; Related product: **ACM0760**

Factory price: **\$9.50**



CONTROL PANEL STICKER IN.K300 1 PUMP (WELLIS LOGO)

Product code: ACM0885

Weight: **0.009 lb**; Temperature: ~ 122 F°; Related product: **ACM0759**

Factory price: **\$9.50**



FUSE 20A, 500V, IN.Y & IN.X GECKO CONTROL BOX

Product code: ACM0886

Weight: **0.004 lb**; Size: **1.24x0.26x0.26 in.**; Related products: **US: ACM0952, ACM0853, ACM0956, ACM0854 EU: ACM0754, ACM0776, ACM0755, ACM0756**

Factory price: **\$6.95**



FUSE 250 mA, 250 V, IN.Y & IN.X GECKO CONTROL BOX

Product code: ACM0887

Weight: **0.007 lb**; Size: **1.23x0.26x0.26 in.**; Related products:

US: ACM0952, ACM0853, ACM0956, ACM0854 **EU:** ACM0754, ACM0776, ACM0755, ACM0756

Factory price: **\$2.95**



CONTROL PANEL - IN.K1000 GEN2

Product code: ACM0912

Weight: **1.404 lb**; Temperature: ~ **122 F°**; Touch, LCD display For

Hot Tub; Related Products: **US:** ACM0952, ACM0853, ACM0956, ACM0854 **EU:** ACM0754, ACM0776, ACM0755, ACM0756;

Replacement of **ACM0768**

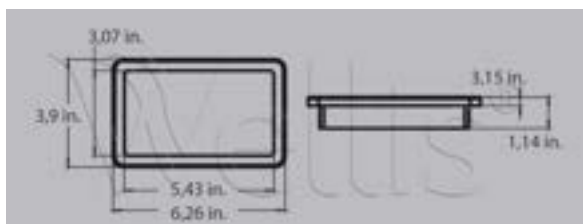

Factory price: **\$249.00**



AMPLIFIER - INSTREAM 2 MID (QUICK CONNECTOR)

Product code: ACM0998

Weight: **3.97 lb**; Temperature: ~ **122 F°**; Extra: **Bluetooth; USB;**

Connection; Integrated Fm receiver with external antenna;

Connection: 4 speaker, One subwoofer; Waterproof: IPx5; Related

product: EU ACM0768, ACM0754, ACM0755, ACM0756, ACM0776

US: ACM0952, ACM0853, ACM0956, ACM0854 Replaced product:

ACM0904

Factory price: **\$249.00**



WIFI RECEIVER IN-TOUCH 2 GECKO USA 60 HZ

Product code: ACM0890

Ultimate Wi-Fi remote control for your spa with smartphone application. Weight: **0.875 lb**; Humidity: **Up to 85% non condensing;**

Operating temperature: **-4°F to 140°F**; Storage temperature: **-22°F**

to 185°F; Water ingress protection: **IPX5** US plug 100-240V 50/60

Hz, 0, 2A UR certificated Related Product: **US:** ACM0952, ACM0853,

ACM0956, ACM0854

Factory price: **\$109.95**





CONTROL PANEL IN.K500

Product code: ACM0959

K506; with 9.84 ft length 8-pin cabel; IPX5; Temperature: **-4 F°-140 F°**;
Related product: **US: ACM0952, ACM0853, ACM0956, ACM0854**
EU: ACM0754, ACM0776, ACM0755, ACM0756

Wellisparts®

Factory price: **\$99.95**



IN.YJ-2 CONTROL BOX (4 KW) 60 HZ V3

Product code: ACM0952

RU certification, 120/240V 60 Hz, 32A, AMP-V3-GD1; Related Product:
ACM0759, ACM0760, ACM0959, ACM0912

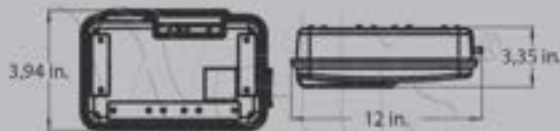

Factory price: **\$139.95**



HEATER 4 KW GECKO

Product code: ACM0926

RU certification, YJ-4-240-2-INC-IF-T-V3, 240V - 4kW; Related Product:
ACM0952

Wellisparts®

Factory price: **\$99.95**



FIRELAY 120V/60 HZ 1800 W (15 A) PLUG&PLAY

Product code: ACM0949

Weight: **3.287 lb**; RU certificated Related Tubs US: **Orion P&P, Leo**

Wellisparts®

Factory price: **\$39.95**



IN.YE-5 GECKO CONTROL BOX (4 KW) 60 HZ

Product code: ACM0853

All circuit convertible 120/240 V 50/60 Hz 4.0 KW Heater (4000 Watts)
Pump #1 and Pump #2 - Single or dual speed Blower/Pump 3 = Single
speed Circ Pump Ozone 12 Volt Light; Related Product: **ACM0759,**
ACM0760, ACM0959, ACM0912, ACM0775, ACM0996, ACM0997,
ACM0765, ACM0881, ACM0886, ACM0887, ACM0998, ACM0890

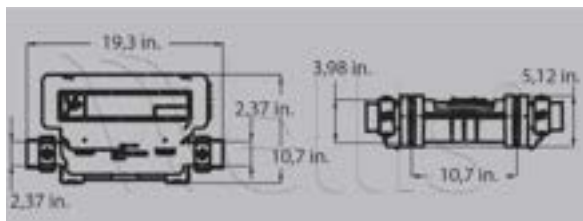

Factory price: **\$299.95**



IN.YT-8 GECKO CONTROL BOX (4 KW) 60 HZ

Product code: ACM0956

RU certificated, IN.YT-8-H4.0; AMP-3-V2-WE2, 120/240VAC 60Hz, 48A,
4kw heater Related Products Related Product: **ACM0759, ACM0760,**
ACM0959, ACM0912, ACM0775, ACM0996, ACM0997, ACM0765,
ACM0881, ACM0886, ACM0887, ACM0998, ACM0890

Wellisparts®

Factory price: **\$349.95**



MOTOR 60 HZ CIRCULATING 2" 190 W GECKO CMXP 1 / 15HP

Product code: ACM0889

Weight: **14.3 lb** ; 62.87 gal/min; 230V/60hz; 0,161 Kw; RPM: **1425**
speed: **1**

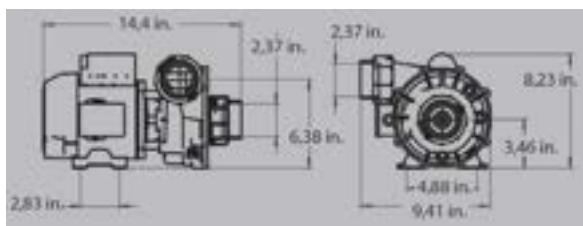

Factory price: **\$134.95**



COLOR MIXER IN-MIX 300

Product code: ACM1033

1 co-cable with: 9.84 ft lenght and 1 cable with 4 pin male; 120-240 VAC
0.32-0.2 A, 50-60 Hz; Related products: **US: ACM0952, ACM0853,**
ACM0956, ACM0854 EU: ACM0754, ACM0776, ACM0755,
ACM0756

Wellisparts®

Factory price: **\$119.00**



IN.K500 KEYBOARD STICKER

Product code: ACM0960

Weight: **0.015 lb**; Size: **6.73x2.8x0.02 in.**; Related Product: **ACM0959**

Factory price: **\$19.95**



CABLE FOR MOTOR Y (CONVERTER GECKO 7 CORE)

Product code: ACM0993

Weight: **0.829 oz**; One side with 4pin male and the other 2 with 4 pin and 3 pin female, cable cross section: 0.00205 in.² (1.32 mm²); Related Product: **US: ACM0854, ACM0732, ACM0733, ACM0734, ACM0735**
EU: ACM0755 , ACM0079, ACM0594, ACM0080, ACM0394

Factory price: **\$5.95**

Wellisparts®



CONTROL BOX IN.YE-3

Product code: ACM0854

Temperature: ~ **122 F°**; Pump: **2.2 speed**; Circulation pump: **Yes**; Ozonator: **Yes**; Led voltage: **12 VAC, 1 A max.**; Voltage: **120/240V 50/60 hz**; Heater: **4 kW**; Waterproof: **IPx5**; Related Product: **ACM0759, ACM0760, ACM0959, ACM0912, ACM0775, ACM0996, ACM0997, ACM0765, ACM0881, ACM0886, ACM0887, ACM0998, ACM0890**

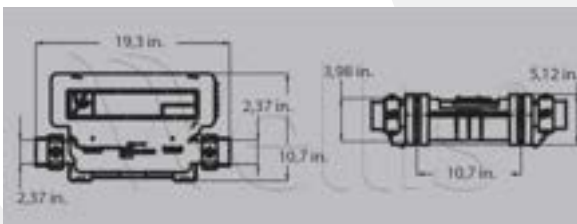

Factory price: **\$226.00**

Pillows

PILLOW - 12.5X4.45X2.36 IN. - PAL. V2 LIGHT GREY

Product code: AF00042

Weight: **0.366 lb**; Material: **EVA**; Temperature: ~ **122 F°**; Relevant Product US: **ORION P&P, LEO P&P, HERCULES, Chicago**; Replaced product: **AF00034**, for the replacement the following parts needed: **2 pc AF00045, 1pc ASE0019 (optional) 6pc ASE0073 (optional) Mounting guide VcManhattan deluxe (WM00445) Palermo deluxe (WM00446) Miami family (WM00456) Fiji (WM00459)**

Factory price: **\$37.38**

PILLOW - 18.2x5.31x2.76 IN. - MAL. V2 LIGHT GREY

Product code: AF00040

Weight: **0.82 lb**; Material: **EVA**; Temperature: ~ **122 F°**; Relevant Product US: **Jersey Sterling Silver**; Replaced product: **AF00032** for the replacement the following parts needed: **2 pc AF00045, 1pc ASE0019 (optional) 6pc ASE0073 (optional) Mounting guide V2**

Factory price: **\$48.44**

PILLOW HOLDER - 17 (0.669 IN.)

Product code: ASE0088

Weight: **0.002 lb**; Material: **ABS**; Temperature: ~ **122 F°**; Related Product: **AF00063, AF00030, AF00031**

Factory price: **\$1.87**

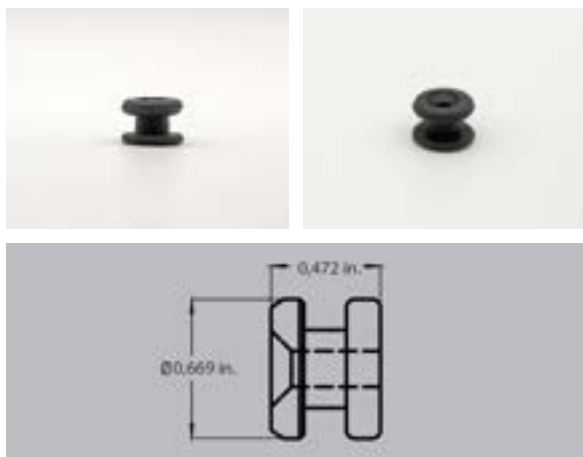
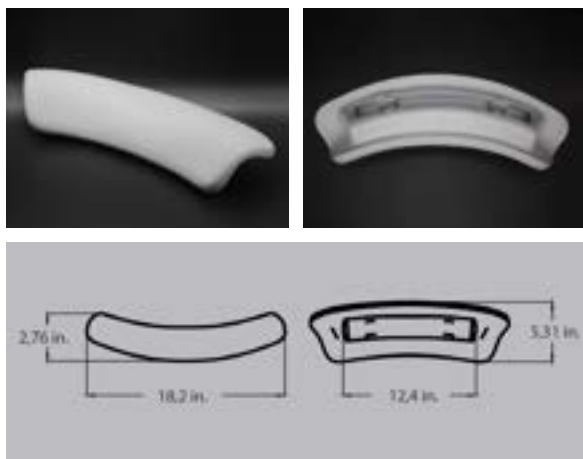
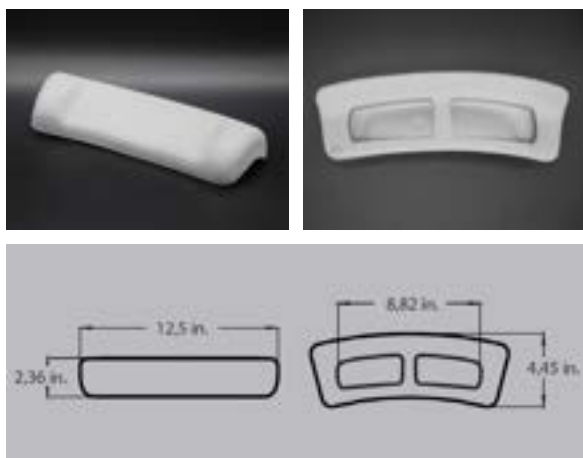

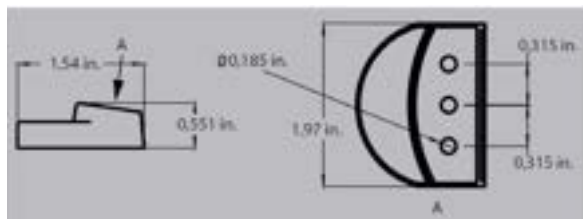

PILLOW HOLDER - 50 × 39 × 14 (1.97X1.54X0.551 IN.)

Product code: AF00045

Weight: **0.015 lb**; Material: **ABS**; Temperature: ~ **122 F°**; Related Product: **AF00062, AF00061, AF00065, AF00040, AF00042**

Factory price: **\$2.44**

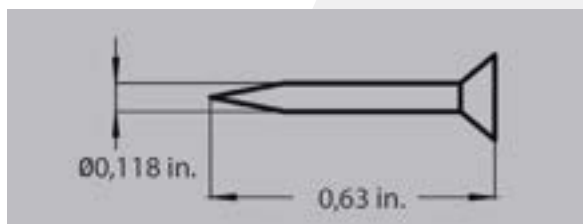

COUNTERSUNK SCREW 3 × 16 (0.118X0.63 IN.) A4

Product code: ASE0169

Weight: **0.0035 oz**; Material: **Stainless Steel**; Related product: **AF00045**

Factory price: **\$0.65**

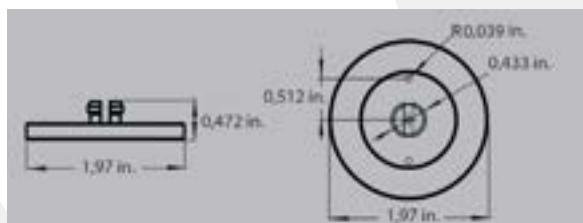

PILLOW ADAPTER

Product code: AF00057

Weight: **0.022 lb**; Material: **PA**; Temperature: ~ **122 F°**; Related Product: **AF00048, AF00044**

Factory price: **\$14.38**



PILLOW - 11×5.71×3.35 IN. LIGHT GREY

Product code: AF00062

Weight: **0.567 lb**; Material: **EVA**; Temperature: ~ **122 F°**; Relevant Product: **US: New York Sterling Silver**; Replaced product: **AF00034, AF00044, AF00048**, for the replacement the following parts needed: **2 pc AF00057, 2pc AF00045 6pc ASE0169 (optional) Mounting guide V1**

Factory price: **\$20.99**



PILLOW - 11.8×4.96×2.2 IN. WHITE RIBBED

Product code: AF00061

Weight: **0.326 lb**; Material: **EVA**; Temperature: ~ **122 F°**; Relevant Product: **US: AMAZONAS W-flow 2019, DANUBE W-flow 2019, LONDON DELUXE, PARIS DELUXE, Rio Grande 2019 W-flow**; Replaced product: **AF00050, AF00051** for the replacement the following parts needed: **2 pc AF00045, 1pc ASE0019 (optional) 6pc ASE0073 (optional) Mounting guide V2**

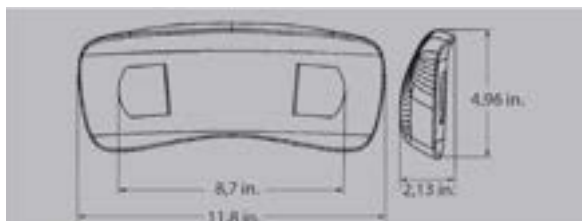

Factory price: **\$19.69**



PILLOW - 13×9.06 IN. - (MAL) CORNER, LIGHT GREY

Product code: AF00063

Weight: **0.388 lb**; Material: **EVA**; Temperature: ~ **122 F°**; Relevant Product EU: **Jupiter, Jupiter P&P, Harmony Camargue, Havana 2 P&P Camargue, Harmony Camargue STD**; Relevant Product: **US: Jersey Sterling Silver**

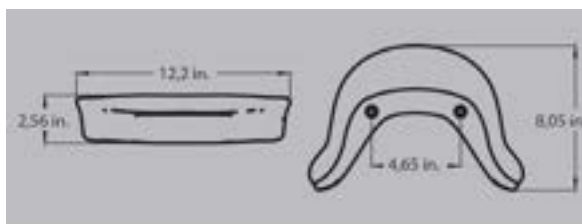

Factory price: **\$18.69**



STAINLESS WOODSCREW FOR PILLOW- 3,5 × 25 (0.138X0.984 IN.)

Product code: ASE0018-K

Weight: **0.0035 oz**; Material: **Stainless Steel**; Size: **0.14x0.98 in.**

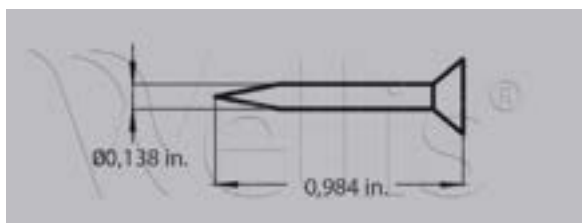

Factory price: **\$0.29**



PILLOW 16.5×6.69 IN. GREY (ROB) LIGHT GREY

Product code: AF00065

Weight: **1 lb**; Size: **16.5x6.69x1.97 in.**; Relevant Product EU: **Elbrus 230 medence, Kilimanjaro, Everest, Kilimanjaro standard, Olympus, Rio Grande Turbine**; Relevant Product: **US: Olympus, MONT BLANC, MONTE ROSA, TAURUS, LIBRA**; Replacement for: **AF00060**

Factory price: **\$40.25**

Filter houses



FILTER HOUSE - 60.3 (2.37 IN.) S × 60.3 (2.37 IN.) S - SKIMMER

Product code: AKU0047

Weight: **4.41 lb**; Temperature: ~ **122 F°**; Related product: **AKU0116, AKU1608**; In EU both basket: **AKU2138** for old version, **IN US: AKU2036** for new version

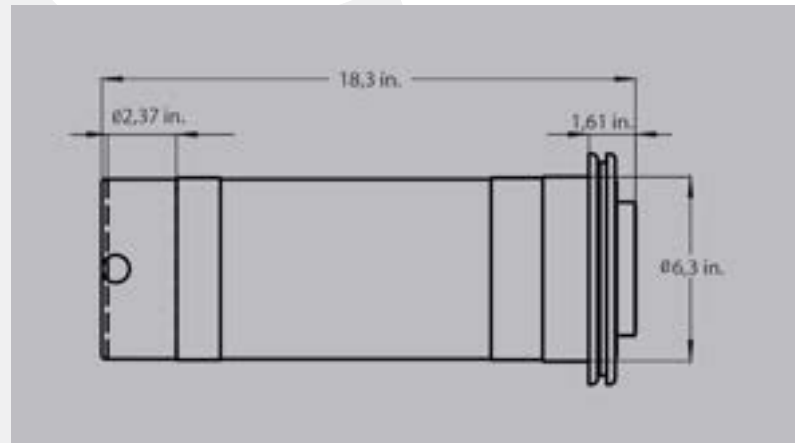

Factory price: **\$97.03**

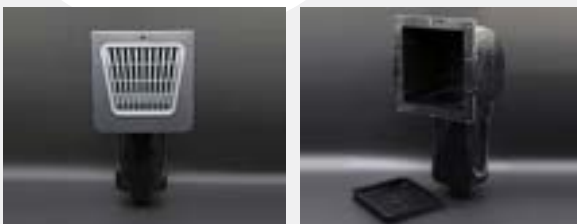

FILTER HOUSE - WALL ONE FILTER

Product code: AM01077

Weight: **5.27 lb**; Temperature: ~ **122 F°**; Related Product: **AKU1609, AKU0135, AKU2648**

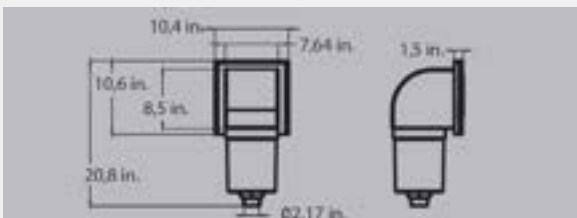

Factory price: **\$56.06**



FILTER HOUSE -WALL TWO FILTERS V2

Product code: AM01214

Weight: **9.46 lb**; Temperature: ~ **122 F°**; Related product: **AKU1609**, **AKU0135**, **AKU2648**

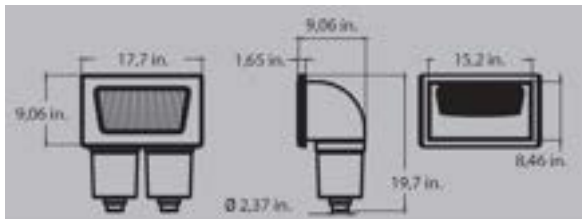

Factory price: **\$75.04**



FILTER HOUSE FOR FLOATING 50 SQF FILTERS

Product code: AKU1830

Weight: **1.24 lb**; Temperature: ~ **122 F°**; Related product: **AKU1831**; In EU both basket: **AKU2138** for old version, IN US: **AKU2036** for new version

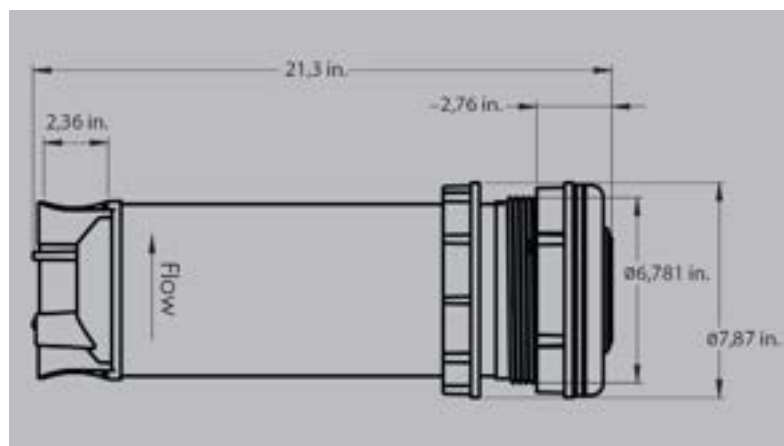

Factory price: **\$46.72**



SKIMMER HOUSE WITH WELLIS LOGO

Product code: AKU1842

Weight: **0.811 lb**; Temperature: ~ **122 F°**; Size: **5.98x5.98x0.75 in.**; Related product: **AKU1830**

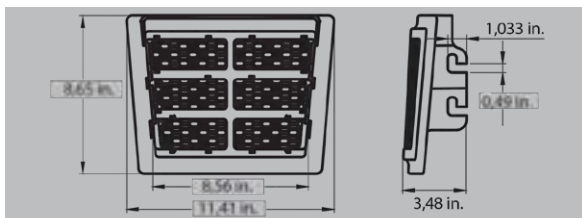

Factory price: **\$14.38**

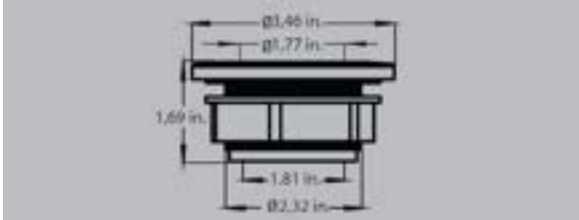

FILTER HOLDER - 48 MM (1.89 IN.)

Product code: AKU1840

Weight: **0.304 lb**; Material: **PVC**; Temperature: ~ **122 F°**; Replacement for: **AKU0024**; Related product: **AKU0136, AKU1610, AKU2649**; Related Tubs: **EU: Elbrus 230, Kilimanjaro, Everest, Kilimanjaro standard, Acapulco Deep-In, Hydrotix Deluxe, Hydrotix Luxury, Hydrotix Relax**; **US: Cuba Power, MONT BLANC, MONTE ROSA, TAURUS, LIBRA**

Factory price: **\$12.94**

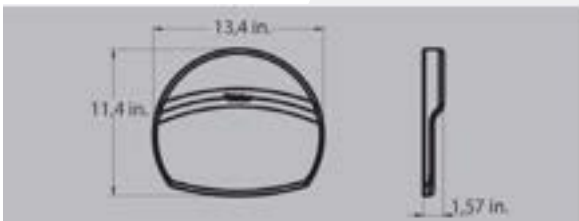

FILTER HOUSE - SKIMMER COVER ROUND

Product code: AKU1832

Weight: **1.03 lb**; Temperature: ~ **122 F°**; Size: **11.4x0.16x13.4 in.**; Material: **EVA**; Related product: **EU: Amazonas Turbine 2019, Amazonas W-flow 2019, Danube Turbine 2019, Danube W-Flow 2019, Elbrus 2018, Malaga 2018, Malaga 2018 standard, Palermo 2018 Standard, Manhattan 2018, Manhattan NTR, Marbella, Palermo 2018 standard, Rio Grande Turbine 2019, Week End 453** **US: AMAZONAS W-flow 2019, DANUBE W-flow 2019, LONDON DELUXE, PARIS DELUXE, Rio Grande 2019 W-flow**

Factory price: **\$23.72**

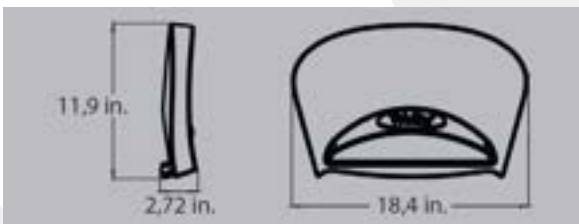

FILTER HOUSE - SKIMMER COVER GREY WITH WELLIS LOGO

Product code: AKU1833

Weight: **1.94 lb**; Material: **EPS**; Replacement of **AKU0059**; Related Tubs: **EU: Elbrus 230, Everest, Kilimanjaro, Kilimanjaro standard, Olympus, Hydrotix Deluxe, Hydrotix Luxury, Hydrotix Relax**, **US: LIBRA, MONT BLANC, MONTE ROSA, Olympus, TAURUS**

Factory price: **\$33.78**

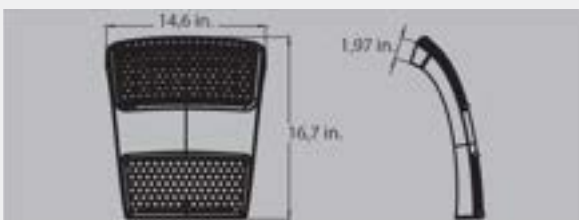

SKIMMER HOUSE LIGHT GREY

Product code: AKU1835

Weight: **2.38 lb**; Material: **PVC**; Temperature: ~ **122 F°**; Replacement of: **AKU0060**; Related Tubs: **EU: Olympus medence, Elbrus 230, Kilimanjaro, Everest, Kilimanjaro standard, Hydrotix Deluxe, Hydrotix Luxury, Hydrotix Relax** **US: Olympus medence, MONT BLANC, MONTE ROSA, TAURUS, LIBRA**

Factory price: **\$23.00**



PROTECTIVE GRILLE FOR SWIMMING FILTERS

Product code: AKU2095

Weight: **0.556 lb**; Temperature: ~ **122 F°**; Size: **7.76x7.76x0.55 in.**;

Related Product: **AKU1830, AKU0047**

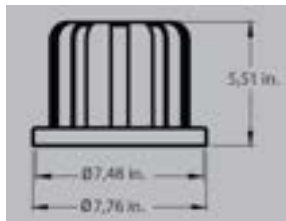

Factory price: **\$21.56**



BASKET FOR FLOATING FILTER HOUSE V2

Product code: AKU2036

Weight: **0.456 lb**; Size: **7.09x4.72x7.09 in.**; Relevant Product: **For new version of AKU0047, AKU1830**

Wellisparts®

Factory price: **\$15.81**



SKIMMER SCREW

Product code: ASE0216

Weight: **0.011 lb**; Size: **0.12x0.12x0.39 in.**; Related Product:

AM01077, AM01214

Wellisparts®

Factory price: **\$2.88**



LOCKING RING FOR FLOATING SKIMMER HOUSE

Product code: AKU2462

Weight: **0.084 lb**; Size: **7.09x7.09x1.18 in.**; Related Product: **AKU0047, AKU1830**

Wellisparts®

Factory price: **\$8.34**



Wellisparts®

RUBBER GASKET FILTER HOUSING SIDE WALL 2 (LVJ)

Product code: AE00503

Weight: **0.441 lb**; Material: **silicone**; Related Product: **AM01214**

Factory price: **\$6.04**



Wellisparts®

RUBBER SEAL FOR WALL FILTER HOUSING 1

Product code: AE00502

Weight: **0.011 lb**; Material: **silicone**; Size: **9.84x9.84x0.08 in.**; Related Product: **AM01077**

Factory price: **\$5.32**



Wellisparts®

FILTER TANK COARSE THREAD EGO3

Product code: AKU2648

Weight: **1.1 lb**; Material: **ABS**; Size: **6.3x7.09x6.3 in.**; Compatible with: **AKU0135, AKU1609**; Related Product: **AKU2650, AKU2651**

Factory price: **\$37.38**

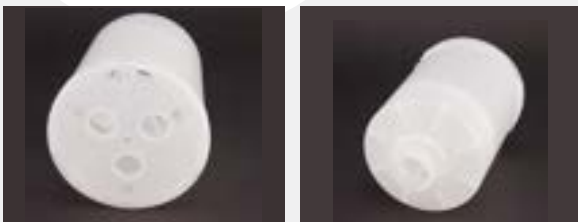

Wellisparts®

FILTER TANK WITH FINE THREAD EGO3

Product code: AKU2649

Weight: **1.1 lb**; Material: **ABS**; Size: **6.3x7.09x6.3 in.**; Compatible with: **AKU0136, AKU1610**; Related Product: **AKU2650, AKU2651**

Factory price: **\$37.38**

Filters



SPA FILTER - 6.89X2.05 IN. - WELLIS ANTIMICROBIAL BLUE (FINE THREAD)

Product code: AKU0136

Compatible models: **US:** Paris Life, MONT BLANC, MONTE ROSA, TAURUS, LIBRA, Everest Life; **EU:** Elbrus 230, Kilimanjaro, Everest, Kilimanjaro standard, Everest Life; Kilimanjaro Life, Malaga Life, Palermo Life, Elbrus Life, Manhattan Life, Lima Life; Compatible with: AKU1610, AKU2649

Factory price: **\$22.00**

SPA FILTER - 6.89X2.05 IN. - MYLINE WHITE (FINE THREAD)

Product code: AKU1610

Compatible models: **US:** Paris Life, MONT BLANC, MONTE ROSA, TAURUS, LIBRA, Everest Life; **EU:** Elbrus 230, Kilimanjaro, Everest, Kilimanjaro standard, Everest Life, Kilimanjaro Life, Malaga Life, Palermo Life, Elbrus Life, Manhattan Life, Lima Life ; Compatible with: AKU0136, AKU2649

Factory price: **\$21.00**

SPA FILTER - 6.89X2.05 IN. - WELLIS ANTIMICROBIAL BLUE (COARSE THREAD)

Product code: AKU0135

Compatible models: **US:** AMAZONAS W-flow 2019; **Eu:** Amazonas Turbine 2019, Amazonas W-flow 2019, Rio Grande Turbine, Danube Turbine; Compatible with: AKU1609, AKU2648

Factory price: **\$22.00**

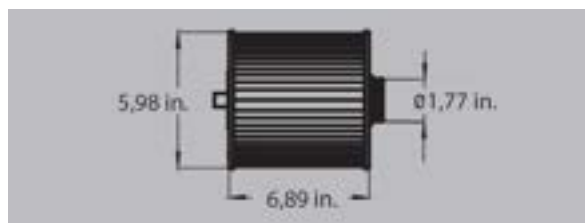
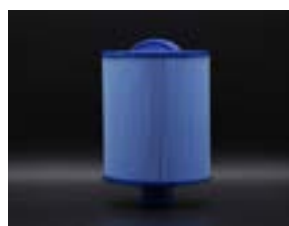
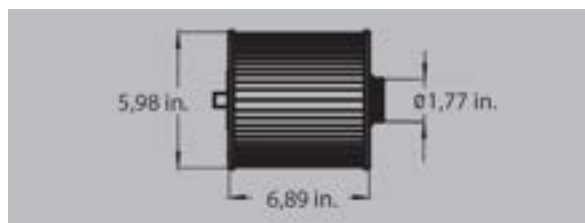
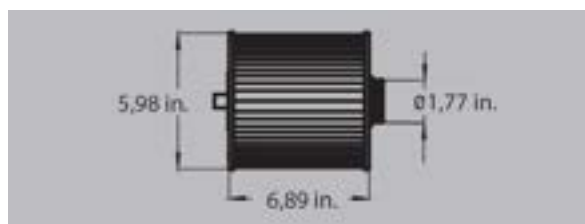

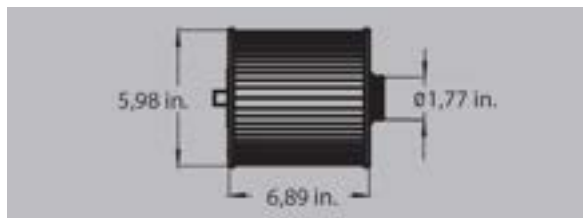

SPA FILTER - 6.89X2.05 IN. - MYLINE WHITE (COARSE THREAD)

Product code: AKU1609

Compatible models: **US:** New York Sterling Silver, Boston Sterling Silver, Atlanta Sterling Silver; **EU:** Venus, Spirit Camargue STD, Spirit Camargue, Saturn, Pluto P&P, Pluto, Mars P&P, Mars, Mars Camargue, Spirit; Compatible with: AKU0135, AKU2648

Factory price: **\$21.00**

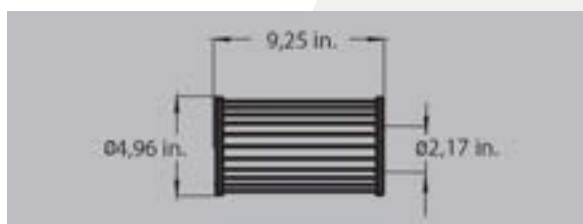

SPA FILTER - 9.25×5 IN. - WELLIS ANTIMICROBIAL BLUE (NO THREAD)

Product code: AKU0116

Compatible models: **US:** OLYMPUS; **EU:** Credo, 330/2L, 536L, 645/L, Palermo Premium, Explorer, Bliss Tuscan Sun; Compatible with: AKU1608

Factory price: **\$22.00**

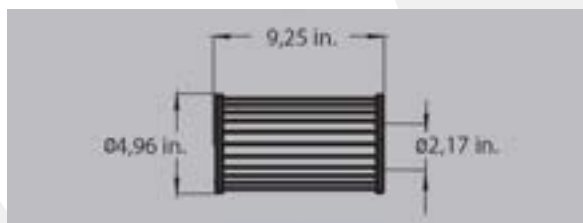

SPA FILTER - 9.25×5 IN. - MYLINE WHITE (NO THREAD)

Product code: AKU1608

Compatible models: **US:** ORION P&P, LEO P&P, LEO, Chicago Sterling Silver; Compatible with: AKU0116

Factory price: **\$21.00**



SPA FILTER - 13.1 × 4.88 IN. - WHITE 50 SQF (NO THREAD)

Product code: AKU1831

Compatible models: **US:** LONDON DELUXE, PARIS DELUXE, HERCULES, Jersey Sterling Silver, DANUBE W-flow 2019, Rio Grande 2019 W-flow, Olympus

Factory price: **\$22.00**



FILTER BALL 300 GR

Product code: AKU2650

Weight: **0.661 lb**; Size: **15.7x23.6x11.8 in.**; Related products: **AKU2648, AKU2649**

Wellisparts®

Factory price: **\$26.16**



FILTER BALL 600 GR

Product code: AKU2651

Weight: **1.32 lb**; Size: **15.7x23.6x23.6 in.**; Related products: **AKU2648, AKU2649**

Wellisparts®

Factory price: **\$48.88**

Water chemicals

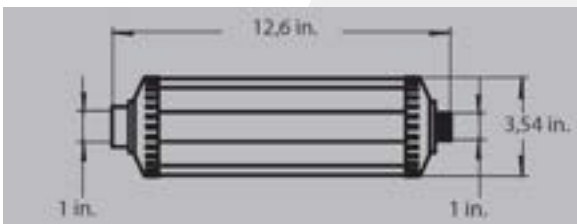

PURE STREAM (WATER SOFTENER)

Product code: WE00067

Weight: **0.403 lb**; Temperature: **68 F°**; Lifetime: **2113.38 gal**; **ION-Exchange; Resin Filter**, to be connected to the water pipe during filling

Factory price: **\$20.00**

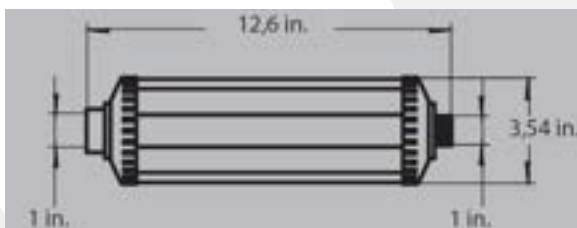

PURE FILL (CARBON FILTER)

Product code: WE00068

Weight: **0.403 lb**; Temperature: **68 F°**; Lifetime: **2113.38 gal**; **Carbon Filter**, to be connected to the water pipe during filling

Factory price: **\$20.00**

Sanitizer system



JET - 20 (0.787 IN.) SB - OZONE 90°

Product code: AJ00169

Weight: **0.403 lb**; Material: **PVC, Stainless steel**; Temperature: ~ 122 F°

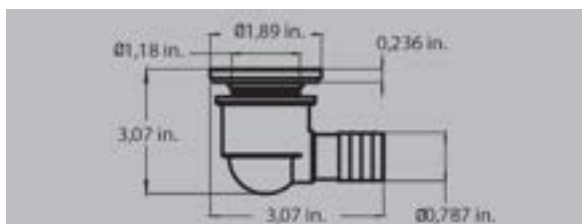

Factory price: **\$2.44**

OZONE - INJECTION

Product code: ABE0359

Weight: **0.086 lb**; Material: **ABS**; Size: **2.48x1.14x5.91 in.**;
Related product: **US: ACM0947, ABE0526, ABE0448, EU: ACM0999, ABE0526, ABE0448**; Replacement of: **ABE0093**

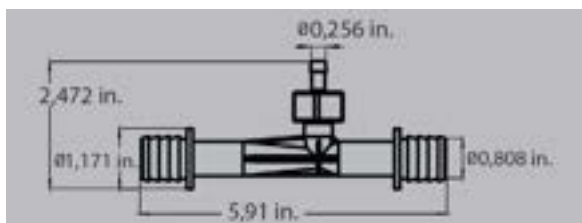

Factory price: **\$3.74**

UV-C - BULB FOR STAINLESS STEEL HOUSE V4

Product code: ACM1000

Weight: **1.54 lb**; Size: **0.79x0.79x13.0 in.**; Tüv16W T5, 4P-SE;
Related Product: **EU: ACM0888, ACM0905 US: ACM0893, ACM0905**; Replacement of: **ACM0624, ACM0906, ACM0930**



Factory price: **\$20.13**

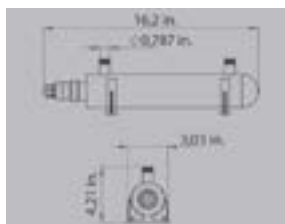

UV-C STAINLESS STEEL HOUSE SET 60HZ

Product code: *ACM0893*

Stainless steel house, cloche, 1 pc bulb 15W, 2 pc click fixer, adapter 120/240V, 60hz, 6 gal/min; Related product: **ACM1000, ACM0905**

Wellisparts®

Factory price: **\$270.25**



OZONE GENERATOR UL 60 HZ

Product code: *ACM0947*

UR certificated, TCB-87400AV, AC100-240V 50/60 Hz; Working current: **40-80 mA**; Related product: **ABE0526**

Wellisparts®

Factory price: **\$62.82**



UV-C + OZONE DISINFECTION SYSTEM

Product code: *ACM0938*

UV/Ozon generator, 240V 50/60Hz, 240mA, 23W, Operating water temp: **41-104 F°**, Max operating; Pressure: **30PSI**, Flow rate: **4 gal/min to 20 gal/min max**; UV-C emitter replacement AQS4076; IPX5; TÜV; RU certificated, Reset button; Related products: **ACM1111**



Factory price: **\$299.00**



SEAL FOR OZONE INJECTOR

Product code: *ABE0448*

Weight: **0.002 lb**; Material: **rubber**; Size: **0.59x0.59x0.59 in.**; Related product: **ABE0359**

Wellisparts®

Factory price: **\$1.08**



UV-C - GLASS FOR STAINLESS STEEL HOUSE V2

Product code: ACM0905

Weight: **0.185 lb**; Material: **Glass**; Temperature: ~ **122 F°**; Related Product: **EU: ACM0888, ACM1000 US: ACM0893, ACM1000**



Factory price: **\$22.86**



UV-C LAMP

Product code: ACM1111

Weight: **0.441 lb**; Power: **19 W**; Current: **0,6 A**; Voltage: **32 V**
Estimated: **10 000h**; Size: **11.39x0.72x10.72 in.**; Related Product: **ACM0938**

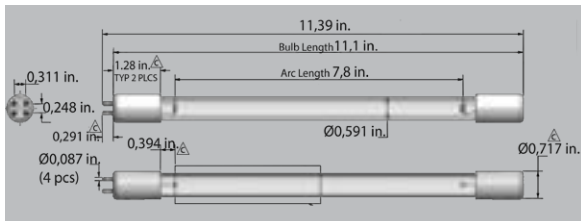

Factory price: **\$72.45**

Aromatherapy



AROMATHERAPY LIQUID 250 ML (8.45 OZ) LEVENDULA

Product code: WM00400

Original French Fragrance; Weight: **0.573 lb**; vol.: **8.45 oz (250 ml)**;
Related product: **AM00744**

Factory price: **\$14.49**



AROMATHERAPY LIQUID 250 ML (8.45 OZ) MEDITERRAN

Product code: WM00409

Original French Fragrance; Weight: **0.573 lb**; vol.: **8.45 oz (250 ml)**;
Related product: **AM00744**

Factory price: **\$14.49**



AROMATHERAPY LIQUID 250 ML (8.45 OZ) ORANGE

Product code: WM00403

Original French Fragrance; Weight: **0.573 lb**; vol.: **8.45 oz (250 ml)**;
Related product: **AM00744**

Factory price: **\$14.49**



AROMATHERAPY LIQUID 250 (8.45 OZ) ML ROSEMARY

Product code: WM00406

Original French Fragrance; Weight: **0.573 lb**; vol.: **8.45 oz (250 ml)**;
Related product: **AM00744**

Factory price: **\$14.49**



AROMATHERAPY LIQUID 250 ML (8.45 OZ) POLYNESIAN

Product code: WM00412

Original French Fragrance; Weight: **0.573 lb**; vol.: **8.45 oz (250 ml)**;
Related product: **AM00744**

Factory price: **\$14.49**



AROMATHERAPY LIQUID 250 ML (8.45 OZ) EUCALYPTUS

Product code: WM00448

Original French Fragrance; Weight: **0.573 lb**; vol.: **8.45 oz (250 ml)**;
Related product: **AM00744**

Factory price: **\$14.49**



AROMA LAVENDER FOR SAUNA 250 ML (8.45 OZ)

Product code: WM00402

Original French Fragrance; Weight: **0.573 lb**; vol.: **8.45 oz (250 ml)**;
Related product: **AM00744**

Factory price: **\$14.49**



AROMA ORANGE BLOSSOM FOR SAUNA 250 ML (8.45 OZ)

Product code: WM00405

Original French Fragrance; Weight: **0.573 lb**; vol.: **8.45 oz (250 ml)**;

Related product: **AM00744**

Factory price: **\$14.49**



AROMA ROSEMARY FOR SAUNA 250 ML (8.45 OZ)

Product code: WM00408

Original French Fragrance; Weight: **0.573 lb**; vol.: **8.45 oz (250 ml)**;

Related product: **AM00744**

Factory price: **\$14.49**



AROMA MEDITERRANEAN FOR SAUNA 250 ML (8.45 OZ)

Product code: WM00411

Original French Fragrance; Weight: **0.573 lb**; vol.: **8.45 oz (250 ml)**;

Related product: **AM00744**

Factory price: **\$14.49**



AROMA POLYNESIAN FOR SAUNA 250 ML (8.45 OZ)

Product code: WM00414

Original French Fragrance; Weight: **0.573 lb**; vol.: **8.45 oz (250 ml)**;

Related product: **AM00744**

Factory price: **\$14.49**



AROMA EUCALYPTUS FOR SAUNA 250 ML (8.45 OZ)

Product code: WM00450

Original French Fragrance; Weight: **0.573 lb**; vol.: **8.45 oz (250 ml)**;

Related product: **AM00744**

Factory price: **\$14.49**



SEALING RING FOR AROMA PUMP

Product code: AE00737

Material: **rubber**; Weight: **0.002 lb**; Size: **0.98x0.98x0.2 in.**;

Related product: **US: AM00744 EU: AM00744, AKU2465**

Wellisparts®

Factory price: **\$0.43**



PUMP TYPE AROMATHERAPY HOUSE

Product code: AM00744

Weight: **0.441 lb**; Material: **ABS**; Size: **3.19x3.19x7.99 in.**;

Related products: **AE00737, WM00400, WM00409, WM00403, WM00406, WM00412, WM00448, WM00402, WM00405, WM00408, WM00411, WM00414, WM00450**

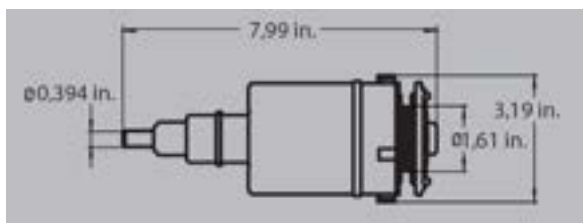

Factory price: **\$71.59**

Sound system

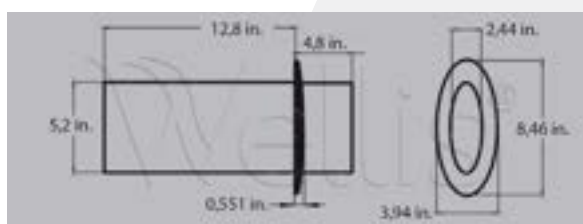
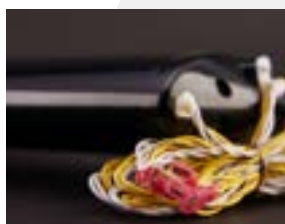

SPEAKER OVAL POP-UP POLY PLANER (MA7020-G) + CONVERTER

Product code: ACM1031

Weight: **5.478 lb**; Size: **17.5x9.06x3.15 in.**, **50 W**, **8 Ohm**;
Cable: **2x2 pcs**, cross section:**0.00233 in.²**, lenght: **7.94 ft**; Related
product: **ASE0223, ACM0998, ACM0894, ACM0849, ACM0929,**
ASE0200

Factory price: **\$133.40**

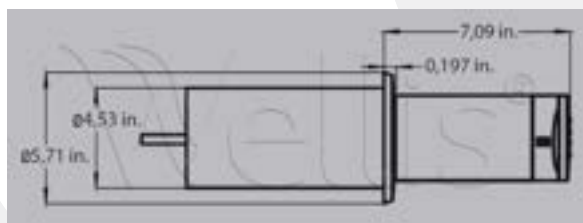

SPEAKER ROUND POP-UP POLY PLANER (SP201RG) + CONVERTER

Product code: ACM1030

Weight: **2.515 lb**; Size: **19.1x10.8x3.15 in.**, **4pin connection**; Cable
lenght: **7.94 ft**; Related product: **US: ASE0223, ACM0849, ASE0200,**
ACM0998, ACM0894 EU: ACM0524, ACM0676, ACM0525,
ASE0223, ACM0849, ASE0200, ACM0998, ACM0894

Factory price: **\$150.65**

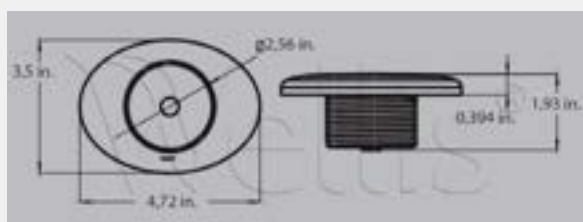

SPEAKER OVAL FLAT POLY PLANAR (SB50G) + CONVERTER

Product code: ACM1029

4 ohm impedance; Full frequency audio range; **35 watt RMS**
power rated; **Chemical resistant components**; **Threaded body with**
backing nut; Related Product: **ASE0223, ACM0998, ACM0894,**
ACM0849, ASE0200, EU only: ACM0524, ACM0676, ACM0525

Factory price: **\$30.25**



SPEAKER CABLE - 2 × 0.75 (0.079X0.03 IN.) RED-BLACK

Product code: ACM0695

Weight: **4.7 lb**; Length: **328 ft**; Dimension: **0.0787 x 0.0295 in.**;
Minimum order quantity: **1.09 yd**; Related product: **ACM1031, ACM1030, ACM1029**

Factory price: **\$0.46**



SUBWOOFER 288 W

Product code: ACM0849

Weight: **9.37 lb**; Power Handling: **288W**; Impedance: **4 Ohm & 2 Ohm stable**; Frequency Response (sub): **26-125 Hz**; Sensitivity: **86 dB**; Power max: **288 W**; Waterproof: **IPx4**; Chassis Material: **ABS**; Cone Material: **Polypropylene**; Inputs: **2x RCA**; Certification: **RoHS**;
Dimensions: **14.5 × 11 × 5.67 in.**; Additional Features: **Tuned port**; Related Product: **ASE0223, ACM0998, ACM0894, ACM0849, ACM0929, ASE0200, ACM1031, ACM1030, ACM1029, ACM0874**

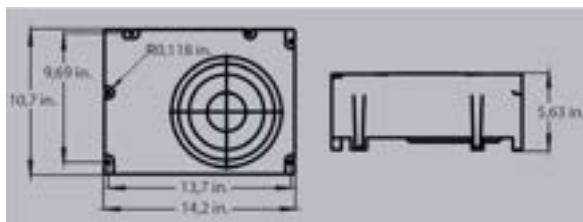

Factory price: **\$114.43**



GRILLE FOR SPEAKER 3" (2 WAY) WELLIS LOGO

Product code: ACM0875

Weight: **0.066 lb**; Material: **Plastic**; Temperature: **~ 122 F°**;
Related Product: **ACM0874**

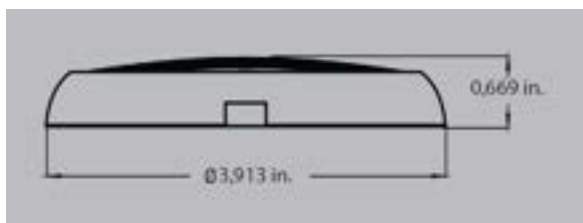

Factory price: **\$5.32**



SPEAKER 3" (2 WAY)

Product code: ACM0874

Weight: **0.796 lb**; Impedance: **4 ohm**; Peak power: **60 W**; Continuous Power: **30 watts RMS/speaker**; **SPL 83 DB**; Frequency Response (Single Cone): **70-20 000 Hz**; Channel Speaker: **2**; **Powder coated stainless steel grill**; Related Product: **ASE0223, ACM0849, ACM0998, ACM0929**

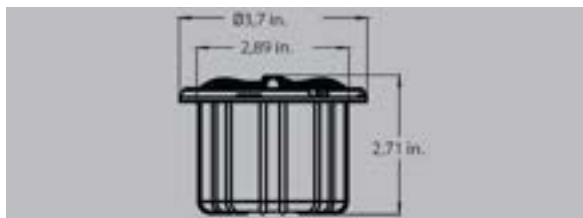

Factory price: **\$34.50**

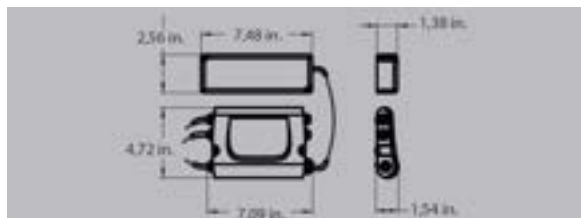

AUDIO AMPLIFIER BLUETOOTH WITH TRANSFORMATOR 6,3 A, 24 V V2

Product code: *ACM0929*

Transformer: **IP67**; Input: **220 V; 1.7 A; 50-60Hz, 277V 1,5 A (for north USA)**; Connector: **4 pin**; Audio amplifier: input: **24 V, 6,25 A**; Output: **4 channel, 4x30W, 8 Ohm, 20Hz-20Khz, IPX5, 2.1: 2x30W, 8 ohm**, Part of the subwoofer 1: **60W, 4 ohm**, 3 connectors: **2 pin**; Related Product: **ACM0875, ACM0874, ACM1031, MyMusic 2.0, 2.1, 4.0**

Factory price: **\$151.66**



FIXATION CONSOL FOR SUBWOOFER 288 W

Product code: *ASE0200*

Weight: **0.0132 lb**; Material: **Steel sheet**; Size: **2.09x0.87x0.35 in.**; Related Products: **ACM0849**

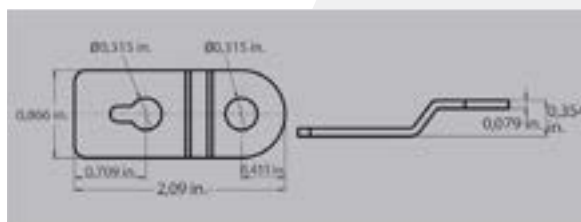

Factory price: **\$1.44**



CABLE SET FOR LOUDSPEAKER UNIVERSAL 2.0-4.1

Product code: *ACM0894*

Weight: **0.948 lb**; 1 pcs 2 pin 3.31 ft cabel, 1 pcs 4 pin 3.31 ft cabel, 2 pcs 2 pin 10.23 ft cabel, 1 pcs 2 pin 11.23 ft cabel; Minimum order quantity by 1,09 yard; Related Products: **ACM1031, ACM1030, ACM1029, ACM0849**

Factory price: **\$17.25**



GRILLE FOR SPEAKER 3" (2 WAY) NEUTRAL

Product code: *ACM0897*

Weight: **0.04 lb**; Material: **ABS**; Size: **3.94x3.94x0.67 in.**; Related Products: **ACM0874**



PLASTIC SNAP SET FOR SPEAKER

Product code: ASE0223SET

Weight: **0.011 lb**; Material: **ABS**; Size: **0.2x0.2x1.65 in.**; Contains 8 pc

Related products: **ACM1031, ACM1030, ACM1029, ACM0874**

Wellisparts®

Factory price: **\$3.59**



BLUETOOTH AMPLIFIER WITH 2.0 WITH CABLE WHIP

Product code: ACM0943

Weight: **0.661 lb**; Input: **100-240V, 10A**, Output: **2.0 2x15W; 64 Ohm**,

Freq: **20hz-20khz, IPX5**; Size: **2.36x1.57x0.98 in.**; Related Products: **ACM0874**

Wellisparts®

Factory price: **\$56.35**



FIXING TOOL FOR PLASTIC PATENT FOR SPEAKER

Product code: SZE0985

Weight: **0.075 lb**; Material: **ABS**; Size: **0.98x3.94x0.98 in.**

Wellisparts®

Factory price: **\$59.80**

Others

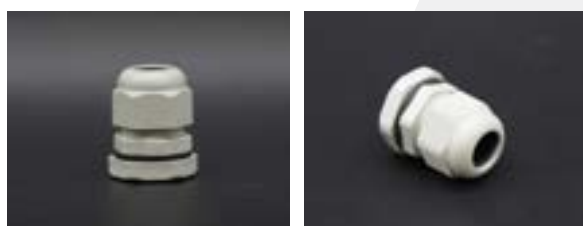
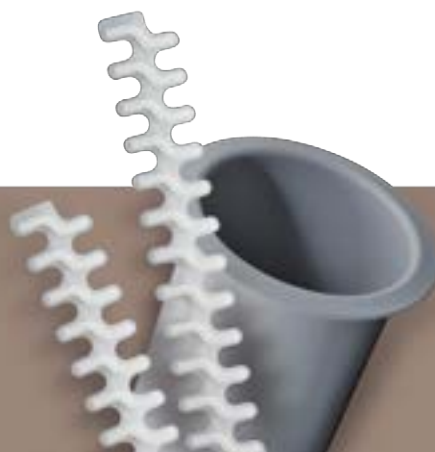

CABLE GLAND PG21

Product code: ABE0035

Weight: **0.027 lb**; Temperature: ~ **122 F°**

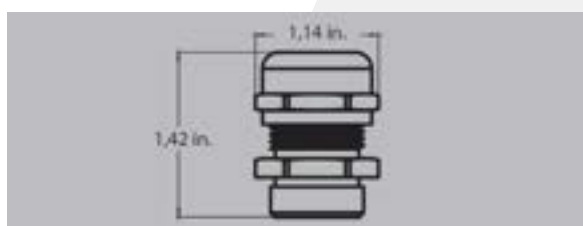

Factory price: **\$0.58**



CABLE GLAND PG13.5 PLUG&PLAY

Product code: ACM0621

Weight: **0.027 lb**; Temperature: ~ **122 F°**; Type: **PG13.5**

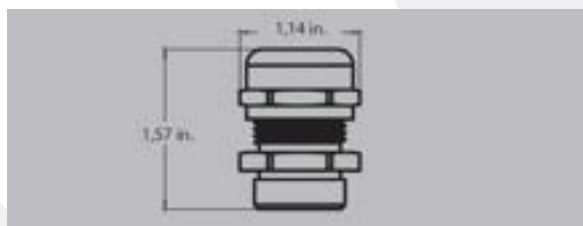

Factory price: **\$0.63**

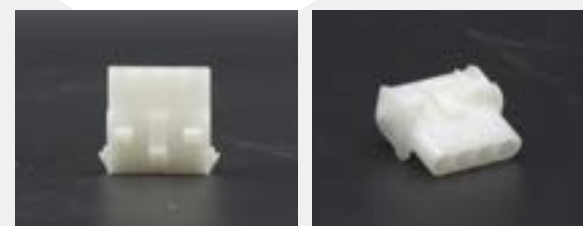

POWER CONNECTOR HOUSE 6,35 MM (0.25 IN.9) 4 P (FEMALE)

Product code: AE00271

Weight: **0.004 lb**; Temperature: ~**122 F°**; Connection: **0.25 in.**; Related product: **AE00269, AE00272, AE00273**

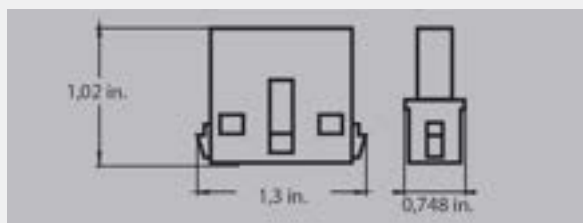

Factory price: **\$0.63**



POWER CONNECTOR HOUSE 6,35 MM (0.25 IN.) 4 P (MALE)

Product code: AE00269

Weight: **0.002 lb**; Temperature: ~122 F°; Connection: **0.25 in.**; Related product: AE00271, AE00272, AE00273

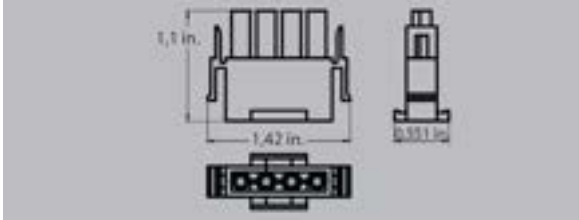

Factory price: **\$0.58**



POWER CONNECTOR PIN 6,35 MM (0.25 IN.) (MALE)

Product code: AE00272

Weight: **0.011 lb**; Temperature: ~122 F°; Connection: **0.25 in.**; Related product: AE00269, AE00271, AE00273

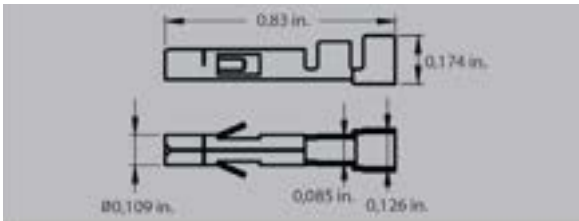

Factory price: **\$0.23**



POWER CONNECTOR PIN 6,35 MM (0.25 IN.) (FEMALE)

Product code: AE00273

Weight: **0.004 lb**; Temperature: ~122 F°; Connection: **0.25 in.**; Related product: AE00269, AE00271, AE00272

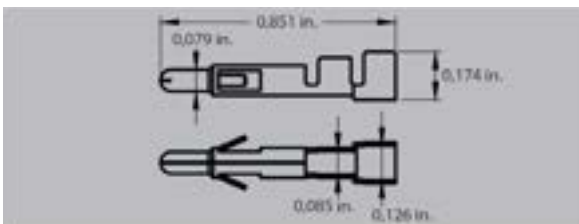

Factory price: **\$0.23**

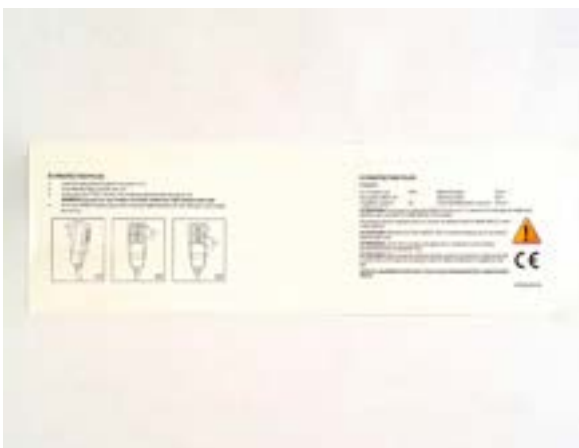

STICKER "PLUG&PLAY"

Product code: AE00308

Instruction of relay and data 230 V, 16 A, Nominal 30 mA, Plug and Play EU, IP54, outdoor use

Factory price: **\$0.98**

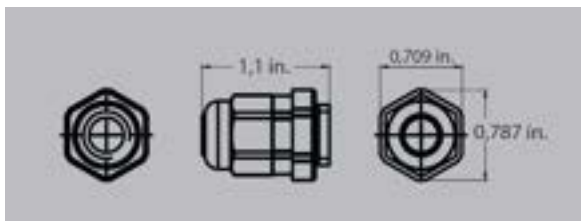

GLAND PG7

Product code: AE00199

Weight: **0.022 lb**; Size: **1.18×0.79×0.79 in.**; Temperature: ~ **122 F°**

Factory price: **\$0.37**



GLAND M32 × 1,5 (0.061 IN.)

Product code: ACM0786

Weight: **0.014 lb**; IP **68**; Material: **ABS**; Size: **1.3x1.26x1.97 in.**

Factory price: **\$2.30**

Wellisparts®



CABLE GLAND M25 IP65

Product code: ABE0295

Weight: **0.055 lb**; IP**65**; Size: **1.97x1.42x2.91 in.**

Factory price: **\$1.15**

Wellisparts®



THREADED ROD A2 M14 × 1000 (39.37 IN.)

Product code: ASE0193

Weight: **2.018 lb/yd**; Material: **steel**; Size: **39.37x0.55x0.55 in.**

Factory price: **\$11.04**



STICKER WARNING REDUCE

Product code: AE00600

Weight: 0.002 lb; Size: 1.18x0.09x5.91 in.

Factory price: **\$1.50**



STICKER CAUTION CONNECT

Product code: AE00599

English and Spanish language

Factory price: **\$2.88**



STICKER CAUTION USE

Product code: AE00601

English and Spanish language

Factory price: **\$2.88**



SCREW FT 3,5 × 25 (0.138X0.984 IN.) (COARSE THREAD)

Product code: AE00260

Weight: 0.011 lb; Size: 0.98x0.14x0.14 in.

Factory price: **\$0.14**



JUNCTION BOX 19×14×7 (0.748X0.551X0.276 IN.)

Product code: ABE0044

Weight: **0.698 lb**; Material: **ABS**; IP **56** / IK**08**;
Size: **7.48x5.51x2.76 in.**

Wellisparts®

Factory price: **\$10.28**

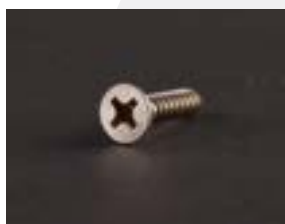

SCREW FOR SWIVEL ROD A4 ST5, 5 × 25 MM (0.197X0.984 IN.)

Product code: ASE0168-K

Weight: **0.008 lb**; **ST0.217X0.984 in.** (5.5x25 mm); DIN**7982**;
A4C H3; Size: **0.98x0.22x0.22 in.**;

Wellisparts®

Factory price: **\$0.72**



ENGINE MOUNT BRACKET (UPPER SIDE)

Product code: ABE0541

Weight: **0.412 lb**; Material: **ABS**; Size: **7.48x5.51x2.76 in.**

Wellisparts®

Factory price: **\$6.61**



CABLE GLAND 9

Product code: ACM0657

Weight: **0.014 lb**; IP **68**; Material: **ABS**; Size: **1.3x0.87x0.87 in.**

Wellisparts®

Factory price: **\$0.29**



POLYFOAM 35 MM NFO3 - 2 M² (21.53 FT²)

Product code: ABE0472

Weight: **4.41 lb**; Color: **light gray**; Material: **Polyfoam**;
Size: **78.74x39.37x1.38 in.**; 1 table: **21.53 ft²**; Replacement for: **ABE0038**

Wellisparts®

Factory price: **\$56.78**



STICKER MINIMUM WATER LEVEL

Product code: AE00646

Weight: **0.007 lb**; Size: **6.1x1.18x0.08 in.**; Temperature: ~ **122 F°**;
Replacement for: **AE00291**

Wellisparts®

Factory price: **\$0.37**



VENTILATION WITH THERMOSTAT LIGHT GREY

Product code: AKU0123

Weight: **0.311 in.**; Material: **PVC**; Size: **4.69x4.69x2.64 in.**;
Temperature: ~ **122 F°**

Factory price: **\$29.21**



POLYFOAM 10 MM (0.394 IN.) NFO3 (LIGHT GRAY) USA

Product code: ABE0473

Material: **Polyfoam**; Weight: **22+ lb**; Size: **23.6x43.31x23.6 in.**;
1 roll: **25.2 yd/30.3 yd² (272.3 ft²)**

Factory price: **\$14.29**



SCREW A4 M5 × 40 (1.57 IN.)

Product code: ASE0232

Weight: **0.002 lb**; Material: **Stainless steel**; Size: **0.2x0.2x1.57 in.**;
Recommended for Swimspace

Wellisparts®

Factory price: **\$0.80**

Tools

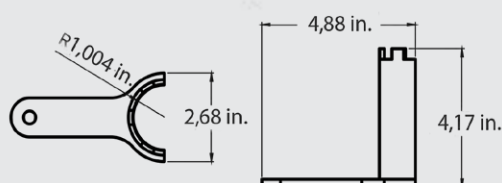
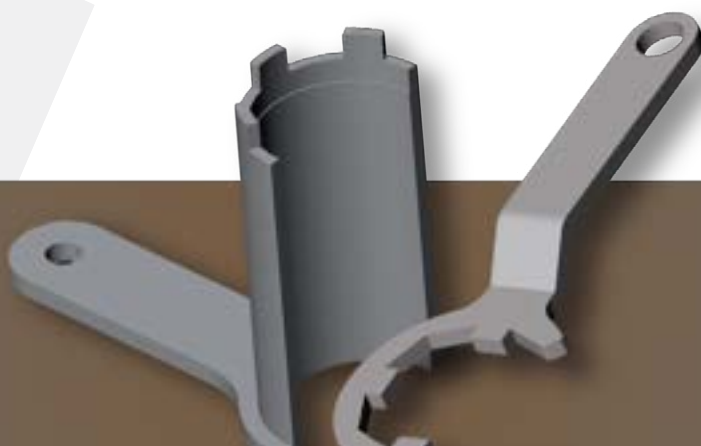

JET WRENCH V1 FOR AIR REGULATOR

Product code: SZE0778

Weight: **~1.1 lb**; Material: **Steel**

Factory price: **\$62.45**

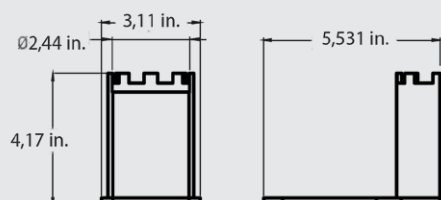

JET WRENCH V1 FOR TAP

Product code: SZE0779

Weight: **~1.1 lb**; Material: **Steel**

Factory price: **\$65.55**

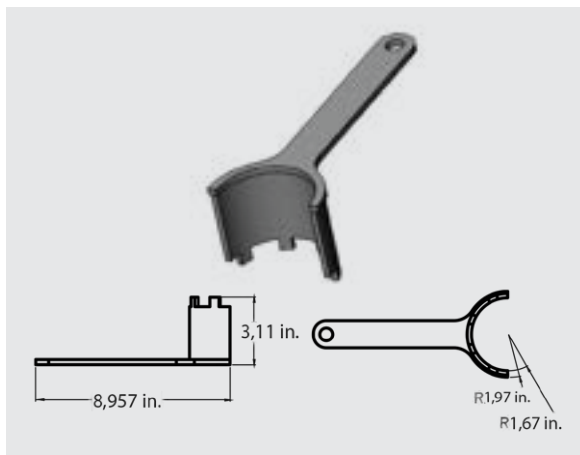

JET WRENCH V1 FOR DIVERTER

Product code: **SZE0780**

Weigth: ~1.1 lb; Material: **Steel**

Factory price: **\$67.85**

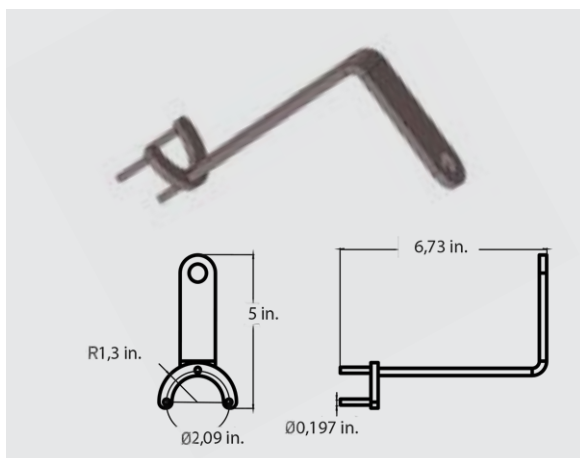

JET WRENCH V2 FOR AIR REGULATOR

Product code: **SZE0781**

Weigth: ~1.1 lb; Material: **Steel**

Factory price: **\$62.45**

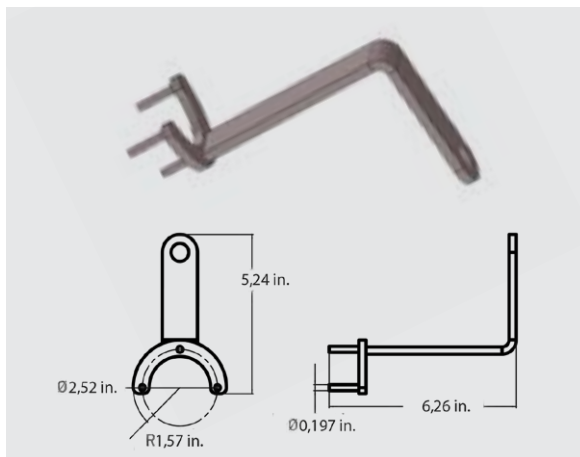

JET WRENCH V2 FOR TAP

Product code: **SZE0782**

Weigth: ~1.1 lb; Material: **Steel**

Factory price: **\$68.77**

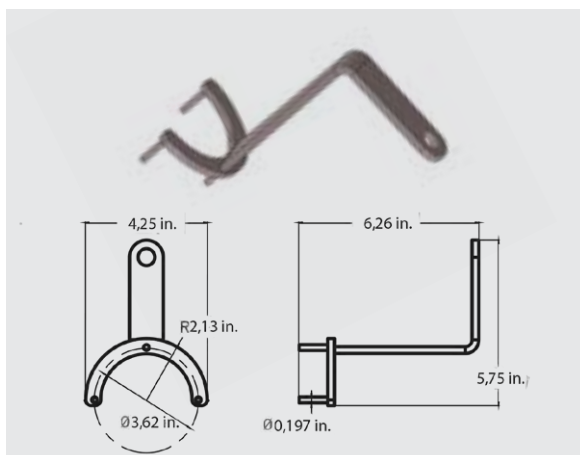

JET WRENCH V2 FOR DIVERTER

Product code: **SZE0783**

Weigth: ~1.1 lb; Material: **Steel**

Factory price: **\$70.50**

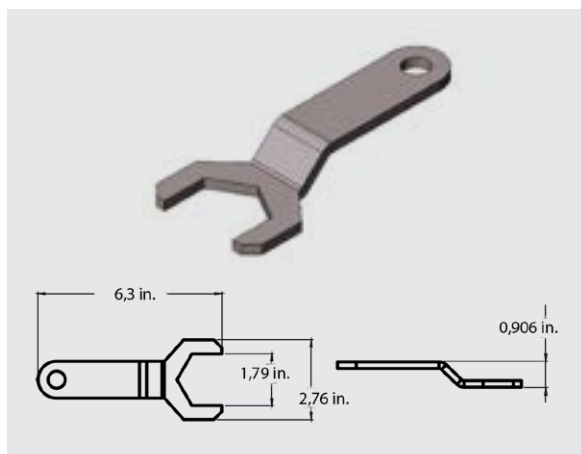

JET WRENCH MICRO

Product code: SZE0784

Weight: ~1.1 lb; Material: Steel

Factory price: **\$39.10**

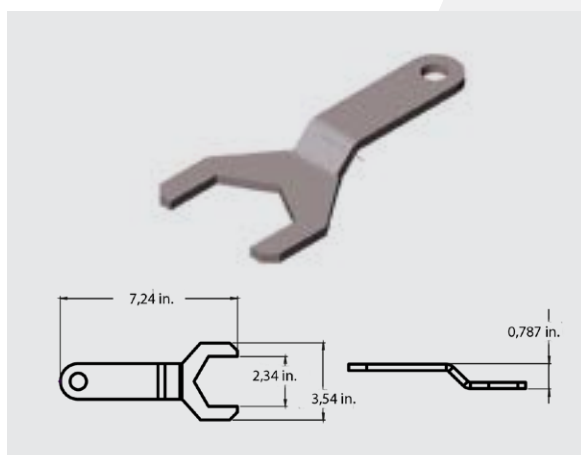

JET WRENCH MIDI

Product code: SZE0785

Weight: ~1.1 lb; Material: Steel

Factory price: **\$40.25**

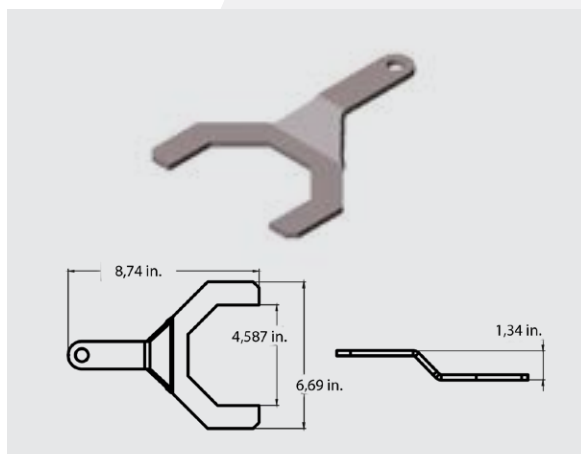

JET WRENCH BIG

Product code: SZE0786

Weight: ~1.1 lb; Material: Steel

Factory price: **\$40.25**

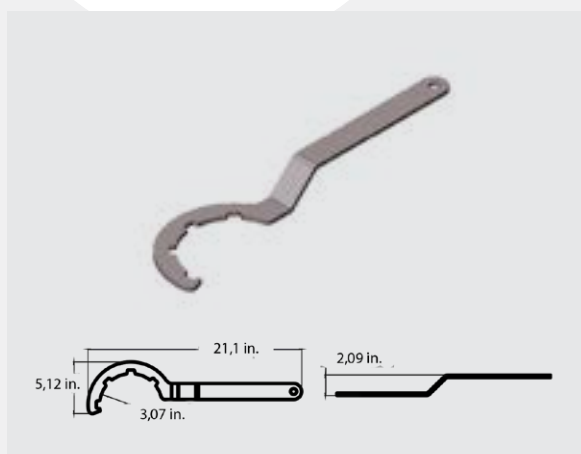

JET WRENCH 7"

Product code: SZE0787

Weight: ~1.1 lb; Material: Steel

Factory price: **\$47.96**

JET WRENCH FOR MICRO TRANSPARENT

Product code: SZE0788

Weight: ~1.1 lb; Material: Steel

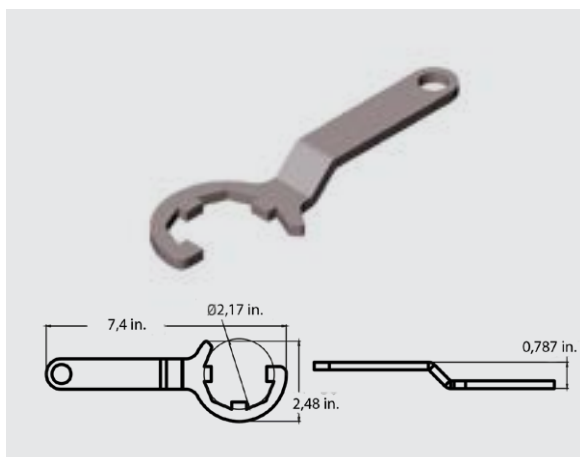

Factory price: **\$40.25**

JET WRENCH FOR BIG TRANSPARENT

Product code: SZE0790

Weight: ~1.1 lb; Material: Steel

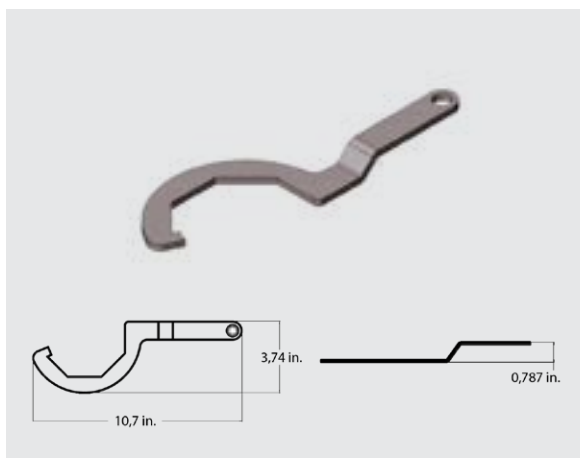

Factory price: **\$34.96**

JET WRENCH 7"

Product code: SZE0791

Weight: ~1.1 lb; Material: Steel

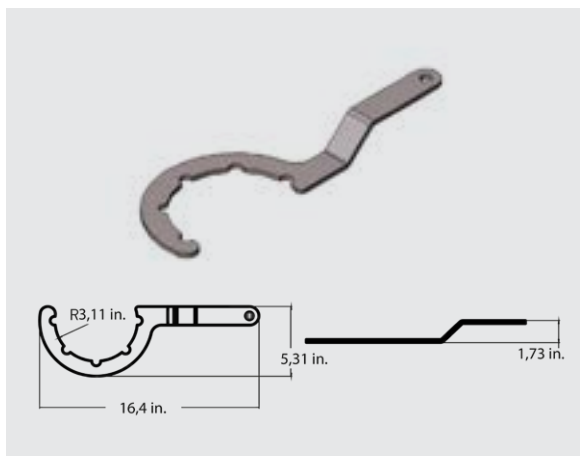

Factory price: **\$45.77**

SKIMMER WRENCH

Product code: SZE0792

Weight: ~1.1 lb; Material: Steel

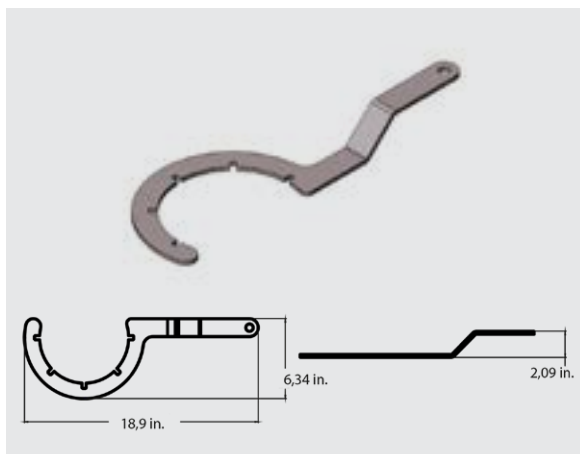

Factory price: **\$43.13**



BE A PART OF THE WELLIS EXPERIENCE!

THE MISSION OF OUR COMPANY IS TO PROVIDE THE BEST QUALITY PRODUCTS TO OUR CUSTOMERS, EQUIPPED WITH THE BEST POSSIBLE MASSAGE AND RELAXATION EXPERIENCES, AT A COMPETITIVE PRICE. WE HAVE MORE THAN 1,600 COLLEAGUES WORKING IN OUR THREE FACTORY FACILITIES THAT ARE ALL WORKING FOR THE SAME PURPOSE EVERY DAY: TO BRING THE WELLIS WELLNESS EXPERIENCE TO YOUR HOME.



Wellis factory video



Thanks to continuous growth and development, Wellis Magyarország Zrt. is now the largest spa manufacturer in Europe. As a domestic producer, it is the market leader amongst the wellness equipment manufacturers and distributors of Hungary.

Since the company was founded in 2003, more and more people are choosing Wellis products across Europe. The increasing demand for a healthy lifestyle increases the demand for quality wellness products. Thanks to continuous development and growth, Wellis has now become the largest hot tub manufacturer on the European market. We produce hot tubs, swim spas, their associated thermal roofs and pool side coverings, involving more than 1000 people at a total area of 59,800 yd². The construction and continuous expansion of the huge plant, which is equipped with modern manufacturing tools was motivated by the growing market demand and the pursuit of quality manufacturing technology. Our products are stored in several warehouses. In the second half of 2020, we also acquired our second site in Ózd, and in 2021 we started manufacturing the hot tubs and employing another 800 employees. The two production units are available with a huge capacity – we could produce 100,000 hot tubs a year – which could make us one of the world's leading manufacturers in the next few years. There could be no more material proof of our company's international recognition than the many awards that our products win at exhibitions around the world. They represent the excellence and quality that has resulted in more than 18 years of professional experience. We currently sell 30,000 Wellis hot tubs per year at more than 500 points of sale worldwide.





© Wellis 2022

Wellisparts is a registered trademark of the Wellis Group.
MAR1186 • (v1)

wellis.com | <https://wos.wellis.com>